

2019-2020 Membership Digest



Kiwanis[®]

CLUB OF ANN ARBOR

*Celebrating 99 Years of Community Service
and Camaraderie*

**MAKE A DIFFERENCE IN THE LIVES
OF CHILDREN IN THIS COMMUNITY**



www.a2kiwanis.org

Kiwanis Club of Ann Arbor

2019-2020

OFFICERS

President Dana A. Dever
 President-elect Margaret J. Krasnoff
 Immed. Past Pres William V. Hampton
 Treasurer, Foundation..... Gregory P. Meisner
 Treasurer, ClubEvan C. LeRoy
 Asst. Treasurer, Foundation... Robert M. Johnson
 Secretary, Foundation..... Susan M. Smith
 Cell phone: 734-834-0374
 E-mail: smithsms@umich.edu
 Secretary, Club Kathie E. Wilder
 Cell phone: 734-6600-5135
 E-mail: kwildera2@gmail.com
 Asst. Secretary, Club..... Robert H. Gray
 Cell phone: 734-604-4977
 E-mail: rhgray@umich.edu

DIRECTORS

Emily Allshouse Sept. 30, 2020
 Marianne E. D'Angelo Sept. 30, 2020
 Gordan L. Beeman Sept. 30, 2021
 Mary Stewart Sept. 30, 2021
 Larry E. Dittmar Sept. 30, 2022
 Kenneth L. Hillenburg..... Sept. 30, 2022

AMINISTRATIVE STAFF

Administrative Assistant.....Mary Schwartz
 Email: kadminasst@icloud.com
 Volunteer Coordinator Sonia Peterson
 Email: kiwanisvcoordinator@icloud.com
 Facility CoordinatorTanya Salamin
 Email: facilitycoordinator@icloud.com
 Sales ManagerMario Gasbarro
 Email: mgasb44791@msn.com

KIWANIS CENTER

100 North Staebler Road, Suite C, Ann Arbor, MI 48103-9755

Administration Phone: 734-368-9738

Answering Service for pickup of donations: 734-665-0450

Email for pickup of donations: donations@a2kiwanis.org

Website: www.a2kiwanis.org

MEETING TIMES OF NEARBY KIWANIS CLUBS

Monday

- * Kiwanis Club of Ann Arbor - Kiwanis Center, 100 North Staebler Road 12:10 PM
- * Chelsea - Chelsea Hospital, Main Dining Room, 775 S Main 6:15 PM
- * Howell - Block Brewing Company, 1140 S Michigan Ave, Howell, 1st & 3rd Mon 5:30 PM
- * Saline - Brecon Village, 200 Brecon Dr, 1st & 3rd Mon 5:45 PM
- * South Lyon – Kiwanis Hall, 228 N Warren St, South Lyon, 2nd and 4th Mon 6:30 PM

Tuesday

- * Ann Arbor Western - The Sports Bar, 5510 Jackson Rd 12:00 PM
- * Belleville Area - Kabob Garden, 277 E Columbia Ave, 2nd & 4th Tues 6:00 PM
- * Plymouth - Zack's of Plymouth, 9468 Main St, Plymouth, 1st & 3rd Tues 6:30 PM

Wednesday

- * Canton – Canton Township Offices, 1150 Canton Center South, 2nd & 4th Wed 6:00 PM
- * Manchester - Kingsley-Jenter (K-J) House, 302 E Main St, 4th Wed 6:00 PM
- * Ypsilanti - EMU Student Center Building, 900 Oakwood St, Ypsilanti Noon

Thursday

- * Brighton - Homewood Suites, 8060 Challis Rd, 1st & 3rd Thurs(1st) 7:15 AM; (3rd) 6:30 PM
- * Colonial Plymouth – Stella's Trackside, 855 Starkweather Rd Noon
- * Whitmore Lake - Whitmore Lake Community Center, 9101 Main St, 1st & 3rd Thurs 7:00 PM

The Objects of Kiwanis International and Our Club Are:

TO GIVE PRIMACY to the human and spiritual rather than to the material values of life.

TO ENCOURAGE the daily living of the Golden Rule in all human relationships.

TO PROMOTE the adoption and the application of high social, business, and professional standards.

TO DEVELOP, by precept and example, a more intelligent, aggressive, and serviceable citizenship.

TO PROVIDE, through Kiwanis clubs, a practical means to form enduring friendships, to render altruistic service, and to build better communities.

TO COOPERATE in creating and maintaining that sound public opinion and high idealism which makes possible the increase of righteousness, justice, patriotism, and good will.

Through the Sponsorship of
Kiwanis Club of Ann Arbor Foundation,



WARM THE CHILDREN

Providing New Winter Clothing for Needy Children

Warm the Children is a local non-profit sponsored by the Kiwanis Club of Ann Arbor Foundation that annually provides new winter clothing for children.

We ask for your donation to support this vital program for children in Washtenaw County. 100% of your donation goes directly to providing clothing.

YOU CAN MAKE A DIFFERENCE IN THE LIVES OF CHILDREN.

FOR VOLUNTEER OPPORTUNITIES, PLEASE VISIT: www.a2kiwanis.org/WarmTheChildren

BE A SHOPPER: See the eyes of the children light up!!

BE A DONOR: 100% of your donation goes directly to providing clothing.

On line: www.a2kiwanis.org/WarmTheChildren

By mail: Warm the Children c/o Old National Bank

In person: At any Old National Bank branch
in Washtenaw County

2723 S State Street
Ann Arbor MI 48104

CLUB HISTORY OF COMMUNITY SERVICE

The Kiwanis Club of Ann Arbor was organized on May 13, 1921, and chartered on June 13, 1921, with 60 charter members. As of September 30, 2019, the club was the largest Kiwanis club in Michigan, with 137 members (including emerita and emeritus members). Since its founding, the club had inducted 1271 members.

In 1922 the club began working with the University of Michigan Hospital to provide recreation and education for young patients. In 1934 this activity was adopted as a Michigan District project and named for Forney W. Clement, a former District Secretary and member of our club. Subsequently, the project was extended to Mary Free Bed Hospital in Grand Rapids (1961), Northern Michigan Hospitals, Inc. in Petoskey (1977), and Children's Hospital of Michigan in Detroit (1980s). Our club members make an annual gift to the Michigan District to support the Clement project at these four hospitals, and also contribute monthly to the Mott Pot to provide additional support to the Clement project at the U of M Mott Children's Hospital.

In 2017, by vote of our Board and club members, our club became the sponsoring agency for Ann Arbor Warm The Children program, with an annual commitment of \$2500.

Proceeds from rummage sales and other fund-raising efforts have enabled the club to fund the activities of many charitable organizations. Most club donations range between \$500 and \$4000. The club has made a few major gifts of \$5000 to \$25,000 to several community organizations to help support their activities.

- * Capital campaigns
 - * AA YMCA
 - * American Red Cross
 - * Arbor Hospice
- * Special Projects
 - * AA Fire Department's "Smoke House"
 - * AA Hands On Museum
 - * AA Library Bookmobile
 - * Dawn Farm (new van)
 - * Help Source
- * Salvation Army
- * Washtenaw Intermediate School District (Green House Project)
- * Hope Dental Clinic
- * "Neutral Zone" for teens
- * Peace Neighborhood Center
- * Washtenaw Area Council for Children
- * Family Learning Institute Bookmobile

In addition to raising money to help charitable organizations, club members have participated in many local hands-on activities. Examples include:

- * greenhouse project at High Point
- * "Christmas-in-April"
- * donating blood
- * dictionaries for 4th-graders
- * "Bring Geography to School"
- * "Kids Against Hunger"
- * serving as Warm The Children "shoppers"
- * "Terrific Kids" at Mitchell School
- * "Meals on Wheels"
- * valentines for Mott Children's Hospital
- * Special Day's Children's Cancer Camp
- * Fourth of July parade in downtown AA
- * hosting parties at Mott Children's Hospital for Christmas and special occasions

The club has also participated in projects that benefit people outside the local area: Examples include:

- * donated funds and goods to help victims of earthquakes, floods, hurricanes, and tsunamis
- * collected and mailed boxes of clothing to Poland, Dominican Republic, and Nigeria
- * collected and sent boxes of prescription eyeglasses to Third World countries
- * donated \$104,000 to the worldwide Iodine Deficiency Disorder project sponsored by KI
- * donated \$103,185 in 2015 to the Kiwanis/unicef worldwide ELIMINATE project to eliminate maternal and neonatal tetanus.
- * donated over \$38,000 since 2010 to the Haiti Nursing Foundation to fund student scholarships to the Faculty of Nursing Science of the Episcopal University of Haiti.

CLUB MEMBERSHIP

Those who join our club are invited to join by current members. The weekly Monday- noon meetings are an excellent forum for prospective members to meet club members. The club covers the cost of two meals for each prospective member.

Members who wish to sponsor prospective members ask them to fill out and sign a Membership Application form. Sponsors sign the form and return it to the Club Secretary. The Secretary arranges for information about the applicant to be published in two consecutive issues of the Club Newsletter, and forwards the completed application to the facilitator of the Past Presidents, who arranges for the applicant to be interviewed by a Past President.

After an interviewer recommends acceptance of the application, the Club Secretary submits the application to the Club Board of Directors for approval. After the Board's approval, the Secretary notifies the applicant and requests payment of dues. Upon payment of dues, the Secretary places a new-member badge in the badge rack, and the President schedules a formal induction ceremony, with the applicant and sponsor present.

Annual club dues for 2019-2020 are \$180. Sponsors mentor new members to help them complete several tasks required to earn a regular-member badge. New members qualify for the regular-member badge once they:

- have been oriented about the club
- have their picture taken by the club photographer
- work on a sale activity
- join a committee
- give a 3-minute speech about themselves
- actively work on a club committee
- participate in two additional club activities, such as:
 - * greet guests and members at a noon meeting
 - * attend a Board meeting
 - * attend an interclub
- participate in at least one Kiwanis-sponsored community activity, such as:
 - * Warm The Children program
 - * Salvation Army bell ringing
 - * Meals on Wheels delivery

"...fresh, thoughtfully prepared, and carefully cooked." —Ann Arbor Observer

cardamom
FRESH INDIAN

1739 Plymouth Road 734.662.2877
cardamomA2.com

How To Maintain Perfect Attendance

A member who chooses to maintain perfect attendance can do so by attending all regularly scheduled club meetings or by making up missed meetings. One member participation credit may be earned for personal attendance at the following meetings or activities during the calendar month or 7 days immediately preceding or following the month that a club meeting is missed:

- a regular, round-table, Board, or special meeting of any other Kiwanis-family club
- a regular (not a special) meeting of our club's Board of Directors
- a regular, scheduled meeting of one of our club's formal committees
- a service project of our club or of a Kiwanis-family organization sponsored by our club (maximum of 1 credit/day/project)
- an international, district, or division Board meeting, convention, conference, or scheduled meeting (maximum of 1 credit per event)
- a club function held to improve the health, welfare, morale, or esprit de corps of club members (maximum of 1 credit/month)
- absence from a regular club meeting as a result of travel to or from an international or district convention or conference (travel must be within 7 days before or after the event)
- a visit to the international office, a regional service center, or a district office (maximum of 1 credit/quarter)
- one credit is given for each regular meeting missed as a result of performing jury duty



HOURS
5 AM – 9 PM
(734) 662-3244

602 S Ashley St.
Ann Arbor, MI 48103
<https://washtenawdairy.com>

2019-2020

HONORARY MEMBERS

Neel Hajra

Joyce Hunter

Rev. George Lambrides

HONORED VOLUNTEERS

Michael Birkle

Carole Buttrum

Katherine Gravlin

Cathy Marshall

Dee Smit

Sallie Springer

Carol Ziegler

IN MEMORIAM



Robert J. Barden, Sr.



Jonathan W. Bulkley



Paul D. Klinger



John R. McKeown



Joseph C. Medrano

**Members with 10 or more years of
PERFECT ATTENDANCE
through September 30, 2019**

| | | | |
|----------------------|---------------------|-------------------|-------------------|
| 56 Benedek, Dick | 28 Gilligan, George | 17 Barden, Bob | 13 Keyes, Sharon |
| 52 Ziegler, Jr., Max | 27 Hendricks, Rick | 17 Bell, Dave | 12 Gray, Bob |
| 45 Dever, C. Nick | 26 Cross, Harry | 17 Lamkin, Sally | 12 Hughes, Dave |
| 44 Sheldon, Cliff | 26 Dabbs, Mike | 16 Niemann, Wally | 12 Supica, Max |
| 40 Leslie, Dale | 26 Schork, Peter | 15 Drake, Dave | 12 Wishka, Mark |
| 39 Sanchez, Fred | 24 Buhner, Pat | 15 Lamkin, Burt | 11 Greene, Bob |
| 38 Ziesemer, Doug | 24 French, Larry | 15 Robb, Bill | 11 Johnson, Bob |
| 36 Carr, Bob | 23 Bassett, John | 15 Webb, Ellen | 11 Kidle, John |
| 36 Dukes, Clar | 23 Beeman, Gordon | 14 Burroughs, Dan | 10 Argyle, Ray |
| 36 Meretta, Jim | 23 Dever, Dan | 14 Elling, Gary | 10 Conlin, Ed |
| 31 Barden, Kathy | 23 Hanton, Doug | 14 Gallup, Al | 10 Gardner, Ron |
| 30 Lande, Lynne | 22 Donner, Garry | 14 Kossick, Don | 10 Mattson, Ann |
| 28 Brown, Jerry | 18 Kinney, Rip | 13 Dahl, John | 10 Winkler, Chris |

FIRST- AND SECOND-GENERATION CLUB MEMBERS

Current members whose parent was, or currently is, a member of our club include:

Kathleen Barden and Robert J Barden, Jr, daughter and son of Robert J Barden, Sr

Harry L Cross, son of Ray E Cross

C Nicholas Dever and Dana A Dever, sons of Charles H Dever

David J Drake, son of Don D Drake

Lynne P Lande, daughter of Nicholas J Prakken

Michele D Robb, daughter of William C Robb

Douglas F Ziesemer, son of Fred C Ziesemer

**Do what you love.
For others.**



United Way
of Washtenaw County

VOLUNTEERS

Find the perfect opportunity to give back to your community at...

NON PROFIT AGENCIES

Post your needs and reach potential volunteers at...

EMPLOYERS

Put your team to work doing community service at...

VolunteerWashtenaw.org

PAST PRESIDENTS

| | | | | | |
|---------|----------------------------|---------|----------------------------|-----------|---------------------------|
| 1921-21 | Fred J Heusel* | 1953-54 | Mac E Watterworth* | 1986-87 | Clifford G Sheldon (DP) |
| 1921-22 | Robert Norris* | 1954-55 | Herbert E Welhenes* | 1987-88 | Fulton B Eaglin (DP) |
| 1922-23 | Walter R Drury* | 1955-56 | Emerson F Powrie* | 1988-89 | Douglas F Ziesemer (DP) |
| 1923-24 | Harry W Nichols* | 1956-57 | W Charles Gregory* | 1989-90 | Michael F Dabbs (DP) |
| 1924-25 | John E Swisher* | 1957-58 | Loren W Campbell* | 1990-91 | Lyman W Bittman (DP)* |
| 1925-26 | Lewis D Reiman (LG,G)* | 1958-59 | Gene D Maybee* | 1991-92 | Lloyd E Kitchens (MP,LG)* |
| 1926-27 | Jay G Pray* | 1959-60 | Fred J Schmid* | 1992-93 | Eugene A Glysso*n* |
| 1927-28 | Arthur E Crippen (LG)* | 1960-61 | F Huston Colvin* | 1993-94 | Kathy Barden (DP) |
| 1928-29 | Clifford C Glover* | 1961-62 | Walter E Kneer* | 1994-95 | Gary R Elling (MP) |
| 1929-30 | Floyd A Sergeant* | 1962-63 | Fred E Stein* | 1995-96 | Leland D Bachman (DP)* |
| 1930-31 | Leonard P Fisher* | 1963-64 | Frederich E Oliver* | 1996-97 | David T Bell |
| 1931-32 | Lynn W Fry* | 1964-65 | Robert A Reiff* | 1997-98 | Ronald N Williams* |
| 1932-33 | Charles A Fisher* | 1965-66 | Dean W Bolgos* | 1998-99 | Lynne P Lande |
| 1933-34 | Howard L Spedding (ST,LG)* | 1966-67 | Sheridan W Springer (LG)* | 1999-2000 | Peter F Schork |
| 1934-35 | Frank S Hait* | 1967-68 | Charles H Dever* | 2000-01 | Harry L Cross |
| 1935-36 | Walter W Springer* | 1968-69 | Fred C Ziesemer* | 2001-02 | Larry E French |
| 1936-37 | Warren F Cook* | 1969-70 | Donald A Duncanson* | 2002-03 | Gordon Beeman (DP) |
| 1937-38 | Ashley H Clague (LG)* | 1970-71 | Robert J Barden, Sr* | 2003-04 | Robert I Carr (DP) |
| 1938-39 | George Meader* | 1971-72 | Lyle O Paige* | 2004-05 | George J Gilligan |
| 1939-40 | Harold J Barnum* | 1972-73 | Fredrick A Mammel (DP,LG)* | 2005-06 | Alan Dailey (DP)* |
| 1930-41 | Russell MacKenzie* | 1973-74 | Clyde W Johnson (DP)* | 2006-07 | J Thomas Lovell (DP)* |
| 1941-42 | Nichols J Prakken* | 1974-75 | Donald G Olsen (DP,LG)* | 2007-08 | Robert J Barden, Jr (DP) |
| 1942-43 | Louis H Hollway* | 1975-76 | C Merle Crawford (DP)* | 2008-09 | Lynne P Lande (DP) |
| 1943-44 | W Horace Campbell* | 1976-77 | J Lee Blaylock* | 2009-10 | Ann E Mattson (DP) |
| 1944-45 | James J O'Kane (LG)* | 1977-78 | J Michael Forsythe | 2010-11 | Ronald D Gardner (DP) |
| 1945-46 | Wendell J LaCoe* | 1978-79 | Jack W Elliott* | 2011-12 | Federico I Sanchez (DP) |
| 1946-47 | Viggo O Nelson (LG)* | 1979-80 | Richard O Brunvand | 2012-13 | Mark S Wishka (DP) |
| 1947-48 | Raymond F Hutzel* | 1980-81 | Clarence E Dukes (DP,LG) | 2013-14 | John E Dahl (DP) |
| 1948-49 | George E Bowder (LG,G)* | 1981-82 | Robert H Nichols (DP,LG)* | 2014-15 | John B Goff (DP) |
| 1949-50 | Albert L Stickney* | 1982-83 | Jerry M Brown (DP) | 2015-16 | Elizabeth Ford |
| 1950-51 | Waldo W Buss* | 1983-84 | Edward F Conlin | 2016-17 | Alan J. Burg (DP) |
| 1951-52 | George F Smalley* | 1984-85 | Dale R Leslie (DP,DLG) | 2017-18 | Gretchen Preston |
| 1952-53 | Murray D Wanty* | 1985-86 | Raymond J Smit (MP) | 2017-19 | William V Hampton (DP) |

* Deceased

(MP) Merit President (1986-1998)

(G) Governor

(LG) Lt Governor

(DP) Distinguished President (since 1972)

(DLG) Distinguished Lt. Governor (since 1972)

(ST) State Trustee

PAST PRESIDENTS OF OTHER KIWANIS CLUBS

Patricia M Buhner.....Ann Arbor Eastern
 Alan J Burg.....Tecumseh
 David J Drake.....Shorewood St. Clair Shores
and Southfield
 Douglas O Hanton.....Saginaw Northwest

Charles Phibbs.....Ann Arbor Western
 Kurt R Schmerberg.....Saline
 C Robert Snider.....Ann Arbor Eastern
 Julianne C Williams.....Dexter

HALL OF HONOR

In 1985 the Board of Directors established the club's Hall of Honor to honor members, past and present, who have assumed leadership roles in our club and/or have exemplified the Objectives of Kiwanis through their dedication to our club and its benevolent activities. This honor is the most prestigious tribute that our club can bestow. Nominees must also have been a Kiwanian for at least 20 years (with at least 10 years in our club) and have attended at least 80 percent of club meetings while a member of our club.

Members of the Hall of Honor and their years of induction are:

| | | | | | |
|---------------------|------|-------------------|------|---------------------|------|
| Leland D Bachman | 2006 | C Nicholas Dever | 2014 | Gene D Maybee | 1988 |
| Robert J Barden, Sr | 1997 | Dana A Dever | 2009 | Raymond C McCalla | 1997 |
| Robert J Barden, Jr | 2014 | Clarence E Dukes | 2006 | James Morgan | 1986 |
| Kathleen Barden | 2007 | Donald Duncanson | 1990 | Robert H Nichols | 1996 |
| John R Bassett | 2014 | Larry E French | 2014 | Charles F North | 2012 |
| Gordon Beeman | 2017 | Willard J Frey | 2012 | James L O'Kane | 1985 |
| Richard S Benedek | 2017 | George J Gilligan | 2017 | Donald G Olsen | 1992 |
| Lyman W Bittman, Jr | 1996 | Eugene A Glysson | 2003 | Nicholas J Prakken | 1985 |
| Jerry M Brown | 2017 | W Charles Gregory | 1986 | Robert A Reiff | 1999 |
| Robert I Carr | 2017 | Fred J Heusel | 1986 | Peter F Schork | 2009 |
| Ashley H Clague | 1985 | L Joseph Jedele | 2003 | Clifford G Sheldon | 1999 |
| Fourney W Clement | 2012 | Ralph C Keyes | 1990 | Sheridan W Springer | 1986 |
| F Huston Colvin | 1986 | Lloyd E Kitchens | 2003 | Fred E Stein | 1985 |
| C Merle Crawford | 1997 | Lynne P Lande | 2007 | Mac E Watterworth | 1996 |
| Harry L Cross | 2014 | Dale R Leslie | 1999 | Ronald N Williams | 1999 |
| Ray E Cross | 2012 | J Thomas Lovell | 2009 | Ronald C Wolf | 1988 |
| Michael F Dabbs | 2006 | Fredrick A Mammel | 1999 | Max M Ziegler, Jr | 2003 |
| Alan M Dailey | 2014 | Ann E Mattson | 2017 | Douglas F Ziesemer | 2006 |

the Y
 FOR YOUTH DEVELOPMENT
 FOR HEALTHY LIVING
 FOR SOCIAL RESPONSIBILITY

A PLACE FOR ALL

When you join the Y, you're committing to more than simply becoming healthier. You are supporting the values and programs that strengthen your community. At the Y, children learn what they can achieve, families spend quality time together and we all build relationships that deepen our sense of belonging. *Financial assistance available.*

www.annarborymca.org · 400 West Washington Street · 734.996.9622



The Kiwanis Center

The evolution of the Kiwanis Center from its original downtown location on the southwest corner of First and Washington Streets to the new Kiwanis Center at 100 North Staebler Road is a tribute to the foresight and dedication to community service by the members and volunteers of the Kiwanis Club of Ann Arbor.

On April 11, 1966, the club voted unanimously to purchase the distinct beige, brick warehouse and flour mill at 200 S. First St., which once housed the Swisher Wholesale Grocery Store and then the Sears Roebuck & Co. Farm Store. The purchase was made possible through the generosity of John E. Swisher, Jr., whose father was a past president of the club (1925), and through contributions from club members and people in the local community. The club named the building the Kiwanis Activities Center (KAC). In 2015, following the purchase of an additional facility (Kiwanis Center West), the KAC was renamed the Kiwanis Center Downtown (KCD). The new KCW opened on June 13, 2015, for Saturday sales. Later that year sales were expanded to include Fridays and Saturdays from 9 am to 1 pm. In September 2016, the club membership voted to authorize the Board of Directors to consider proposals for the sale of KCD. In 2017, the club accepted an offer to sell KCD, with the closing taking place in January of 2018. All club activities were relocated to KCW by December 31, 2017, at which time KCW was renamed The Kiwanis Center.



The Kiwanis Activity Center — 1966-2017

The Kiwanis Center at 100 North Staebler Rd is a 123,000 sq-ft office and warehouse building on a 17.4-acre lot. Approximately 71,000 square feet of the building is dedicated to Kiwanis purposes, including the Kiwanis Thrift Sale; Kiwanis offices and meeting rooms; intake, sorting, and warehousing of donated sale items; plus maintenance and utilities. The remaining 52,000 square feet is warehouse and office space rented to other users. Seven and one-half acres of undeveloped wetlands and woods on the property have been designated as the Ann Arbor Kiwanis Environmental Education Preserve (A2KEEP). That project is under development and will include ponds, woodland, and marsh areas interwoven by paths and planned display projects. Another 2.5-acre portion of the property fronting on Jackson Road is being offered for sale as a commercial out lot.

| Kiwanis Center Floor Space | |
|-----------------------------------|--------------------|
| | <u>Square feet</u> |
| Kiwanis activities | |
| Offices and meeting rooms | 5,000 |
| The Thrift Sale | 30,000 |
| Intake, sorting, testing | 9,000 |
| Warehousing, dock | 18,000 |
| Maintenance, utilities | 9,000 |
| | <hr/> 71,000 |
| Rental areas: | |
| Offices | 7000 |
| Warehouse | 45,000 |
| | <hr/> 52,000 |

users. Seven and one-half acres of undeveloped wetlands and woods on the property have been designated as the Ann Arbor Kiwanis Environmental Education Preserve (A2KEEP). That project is under development and will include ponds, woodland, and marsh areas interwoven by paths and planned display projects. Another 2.5-acre portion of the property fronting on Jackson Road is being offered for sale as a commercial out lot.

Having our Kiwanis Thrift Sale operating again out of one location has allowed for a better shopping experience for our customers and for much improved efficiency in the receiving, sorting, and presenting of merchandise by our club members, volunteers, and staff.



*A Positive Approach
to Debt Recovery*



arborps.com

Carol Molton

Client Services Representative

carolm@arborps.com

PHONE: 800.710.4821

FAX: 734.663.5794

Arbor Professional Solutions

2090 S. MAIN STREET
ANN ARBOR, MI 48103



**Trusted financial advisors
to the University community
for more than 25 years.**



Retirement Income Solutions

Helping to grow and preserve your wealth

734-769-7727 | risadvisory.com

© 2019 Retirement Income Solutions is an Independent Investment Advisory firm, not affiliated with TIAA, Fidelity, or the university.

KIWANIS INTERNATIONAL

3636 Woodview Trace, Indianapolis, IN 48268-3196
Tel: 1-800-KIWANIS (1-800-549-2647): Fax: 1-317-879-0204

Charter Club: The Kiwanis Club of Detroit #1 received its charter on January 21, 1915, the date regarded as the birth date of Kiwanis.

International President: Daniel Vigneron, Howald, Luxembourg

Organization: Districts are organized into Divisions. The chief executive officers of a District and a Division are the Governor and Lt. Governor, respectively. The Kiwanis Club of Ann Arbor is in Division 6 of the Michigan District (K12).

The Kiwanis International Foundation is a not-for-profit, tax-exempt corporation that supports national and international programs outside the Kiwanis International budget.

MICHIGAN DISTRICT OF KIWANIS

315 Kiwanis Drive, P.O. Box 231, Mason, MI 48854
Tel: 1-517-676-3837, Toll-free: 1-877-645-4926; Fax: 1-517-676-6600

Governor Sarah Kew
Phone: 586-531-5505 Email: governor@mikiwanis.org

Exec Dir Greg Smith
Mobile: 586-530-5174 E-mail: districtoffice@mikiwanis.org

Lt Gov Charles A. Phibbs
Div 6 Mobile: 734-646-7825 Email: orvis50@yahoo.com

RONALD D. GARDNER
ATTORNEY AT LAW
SPECIALIZING — WILLS & TRUSTS
1601 BRIARWOOD CIRCLE, SUITE 200
TEL: 734-669-0424



KURT R. SCHMERBERG
VICE PRESIDENT
STATE CERTIFIED GENERAL APPRAISER

AFFINITY VALUATION GROUP, LLC
1310 S. Main St. #7, Ann Arbor, MI 48104
TOLL FREE: 800 305-8832 FAX: 800 354-9868
DIRECT: 734 747-7080 LOCAL FAX: 734 929-1260
Email: Kurt@affinityvaluation.com



*The new Lt. Gov. of Div. 6:
Our own Charlie Phibbs*

MEMBERS



Ackerman, Zach



Allshouse, Emily



Anglin, Mike



Argyle, Ray



Babcock, Bryce



Barden, Jr., Bob



Barden, Kathy



Barhydt, Rose Marie



Barrett, Mike



Bassett, John



Beeman, Gordon



Bell, Dave



Benedek, Dick



Blomquist, Jim



Bomar, Francine

Doug F. Ziesemer, CPA
Commercial & Residential Sales



Commercial Brokers

Each Office Independently Owned and Operated



325 W. Eisenhower, Ann Arbor, MI 48103
Direct 734.769.8111 Mobile 734.395.2092
Office 734.741.1000 Fax 734.623.8455
dfziesemer@aol.com
www.remaxcommercial.com



Kiwanis Foundation Lapel Pins
50 years of helping Clubs and Companies
Succeed with custom imprinting. Give-a Ways.
Pens, mugs, vinyl, emblems, magnets and
catalogs available.

West Hawk Industries
761-3100 Fax 761-8430

OLD NATIONAL BANK
Your bank. For life.™

Laura Radzik Koch, AVP
Retail Center Manager
Registered Real Life Finance Educator
NMLS# 1171993

2723 South State Street
Suite 110
Ann Arbor, MI 48104

T: 734.887.2610
F: 734.887.2601
laura.koch@oldnational.com

oldnational.com

MEMBERS



Brokaw, Ted



Brown, Jerry



Buhner, Pat



Burg, Alan



Burroughs, Dan



Carey, Jim



Carr, Bob



Carr, Joan



Conlin, Bob



Conlin, Ed



Cross, Harry



D'Angelo, Marianne



Dabbs, Mike



Dahl, Claire



Dahl, John

A Realtor and A Kiwanian

I've been a proud member of Kiwanis for 17 years and a Realtor® for 19 years. During that time, I've had the pleasure of working with several members including the Kossick's, the Barden family and Jerry McMahon for their real estate needs.

Specializing in all facets of real estate, I can help you with your first home or your last. From new beginnings to retirement, I can put your mind at ease and guide you through the home buying and selling process.

Call me any time — I'm here to Help!

734-717-5591

EWING PROS
REAL ESTATE



Jim Carey Realtor®

JCAREY@REINHARTREALTORS.COM
WWW.JAMESMCAREY.COM
500 E. Eisenhower Parkway, Suite 200
Ann Arbor, MI 48108

Reinhart
Charles Reinhart Company Realtors

MEMBERS



Dailey, Sue



Dever, Dan



Dever, Nick



Dick, Griff



Dittmar, Larry



Donner, Garry



Drake, Dave



Dries, Jim



Dukes, Clarey



Duquette, Kathy



Elling, Gary



Evans, Garry



Fegan, Tom



Fomby, Paula



French, Larry



Gallagher, Paul



Gallup, Al



Gardner, Ron



Gilligan, George



Goodkin, Mitch



Goss, Ryan



Grachek, Caroline



Gray, Bob



Greene, Bob



Gupta, Jyoti



Hadwin, Karen



Hampton, William



Hanton, Doug



Harper, Betty Jean



Hawkins, Harry

MEMBERS



Heller, Bill



Hendricks, Rick



Hillenburg, Ken



Hiller, Steve



Hughes, Dave



Johnson, Bob



Jones, Deb



Kavanagh, Gary K



Keyes, Sharon



Kidle, John



Kinney, Rip



Kinzinger, John



Koch, Laura



Kossick, Don



Kotch Duda, Andrea

www.ourhousemi.org

Our HOUSE

Support & Resources For
Washtenaw County Youth Aging Out Of Foster Care.

MORE INFO AT

VISTING VET, PLLC
Your home is my office

Betty Jean Harper
D. V. M.
Veterinary Home Visits
3409 Rentz Rd.
Ann Arbor, Mich 48103

734-475-9474

SPRINGER INSURANCE AGENCY

Home – Auto – Life – Business

115 Park St.
Chelsea, Michigan 48118
Phone: (734) 475-8689

MEMBERS



Krasnoff, Margaret



Lamkin, Burt



Lamkin, Sally



LaMoreaux, Dave



Lande, Lynne



Lavin, Eloise



LeRoy, Evan



Leslie, Dale



Linden, Terry



Lofstrom, Len



Lopatin, Dennis



Luke, Gerry



Mattson, Ann



Mattson, Jim



McMahon, Jerry



McNab-Cattell, Dot



Mehraban, Sara



Meisner, Greg



Meretta, Jim



Miller, Fred



Niemann, Wally

Carol's VIP Adventures

Carol Presley
Travel Coordinator
carolsvipadventures@gmail.com

2420 North Street
Milford, MI 48380
248-390-2340

carolsvipadventures.com

Ameriprise Financial

Dr. Sara Mehraban, Ph.D., CRPC®
Financial Advisor
Business Financial Advisor

Ameriprise Financial Services, Inc.
4750 Venture Dr. Suite #150
Ann Arbor, MI 48108-9505
T: 734.477.5233
D: 734.477.5224
F: 734.477.5288
sara.x.mehraban@ampf.com
ameripriseadvisors.com/sara.x.mehraban
CA Insurance #0C50218

An Ameriprise Financial franchise

MEMBERS



Okuley, Jeanette



Panning, Luke



Petroski, Martha



Phibbs, Charlie



Powers, Dennis



Presley, Carol



Preston, Gretchen



Rabidoux, Sandra



Reed, Steve



Reynolds, Jim



Robb, Bill



Robb, Michele



Roberts, Bud



Robinson, Jean



Rupp, Brittany



Salemi, Tony



Sampelle, John



Sanchez, Fred



Schechtman, Perry



Schenk, John



Schmerberg, Kurt



Schork, Pete



Shaw, Ken



Sheldon, Cliff



Smit, Dick



Smith, Susan



Snider, Bob



Soyars, Caroline



Stewart, Mary



Streich, Kim

MEMBERS



Summers, Carla



Supica, Max



Talcott, Jane



Taylor, RJ



Tse, Leo



Webb, Ellen



Wilder, Kathie



Williams, Julanne



Williams, Mel



Winkler, Chris



Wishka, Mark



Wolfington, Jim



Ziegler, Jr., Max



Ziesemer, Doug



James L. Wolfington
Vice President
Commercial Loan Officer

Phone - (734)385-1131
Fax - (734)385-1931
jwolfington@csbonline.com

1010 South Main St.
P.O. Box 10 • Chelsea, MI 48118-0010



Lynne Lande, L.M.S.W.
Staff Clinical Social Worker
LLande@SCCMich.org
Main: 248-474-4701 Fax: 248-474-1518

SAMARITAN COUNSELING CENTER
of Southeastern Michigan

29887 West Eleven Mile Road
Farmington Hills, Michigan 48336-1309

Norton's 
FLOWERS & GIFTS
Since 1892

Full Service
All Occasions
Local Delivery
Worldwide Dlvry

www.nortonsflowers.com * 800-682-8667

| | | |
|--|---|--|
| <p>Ann Arbor 2558 W. Stadium SE Corner at Jackson 734-469-9100 Mon-Sat 9-6 Closed Sun</p> | <p>Flowers * Plants Greeting Cards Balloons * Crystal Religious and Inspirational Gifts</p> | <p>Ypsilanti 2900 Washtenaw 1 mi. East of US-23 734-434-2700 Mon-Sat 8-7 Sun 11-3</p> |
|--|---|--|



2019 Past Presidents Picnic, June 27, 2019.



Just some of the fine art available at the Kiwanis Thrift Sale

DOWNTOWN HOME & GARDEN

210 S. Ashley, Ann Arbor, MI 48104
downtownhomeandgarden.com
phone: (734) 662-8122
fax: (734) 662-8102



Leslie
 SCIENCE & NATURE
 Center
 1381 Traver Rd
 Ann Arbor, MI 48105
 734-997-1553
 www.leslie.org

**Creating Moments
 of Discovery**



**Ann Arbor
 HANDS-ON
 Museum**
 220 E Ann St
 Ann Arbor, MI 48104
 734-995-5439
 www.aahom.org

EMPLOYEES



Baker, Liesel



Bowman, Alex



Corr, Chris



Ellis, Dylan



Gasbarro, Mario



Gubachy, Dan



Hoang, Phong



Kennedy, Ralph



Lovett, Ethan



Mahmud, Tom



Maten, Steve



Marshall, Cathy



Peterson, Sonia



Salamin, Tanya



Schwartz, Mary



Weiss, Josh



Lisa Lemble
Operations Manager

4531 Concourse Drive
Ann Arbor, MI 48108
(734) 260-9026 cell
(734) 761-2576 x202 office
(734) 327-6127 fax

www.gretchenshouse.com email: lisa.lemble@gretchenshouse.com

JERRY'S PAINTING

Interior and Exterior

734-383-7653

MEMBERS

KIWANIS INTERNATIONAL PROHIBITS THE USE OF CLUB MAILING LISTS FOR SOLICITATIONS OR COMMERCIAL MAILINGS

The Membership Growth and Education Committee and the Board of Directors have established an honorary emerita/emeritus status for selected, long-term members who may no longer be able to participate in most club activities. The title "Emerita Member" or "Emeritus Member" appears next to the names of those members who have accepted our invitation to receive this honor.

- Ackerman, Zachary D (Zach)** 2017; Director of Business Development, Denison Consulting, 121 W Washington #201, 48104; Home: 2180 Medford St, Apt 16, 48104; cell: 734-883-8391; zaackerman@gmail.com
- Allshouse, Emily** 2015; HR Specialist, AU Optronics Corp. America (AUO), 37085 Grand River Ave, Ste 340, Farmington 48335; Home: 22611 Braeside Cir, Apt 207, Farmington Hills 48335; cell: 517-673-0860; emily.allshouse@gmail.com
- Anglin, Michael D (Mike)** 2004; Spouse: Kathleen; Retired Educator; Home: 549 S First St 48103; cell: 734-883-6983; mikeanglin07@gmail.com
- Argyle, Ray L** 2009; Retired Fisheries Biologist; Home: 2688 Gloucester Way 48104; 734-973-9166; cell: 734-546-7198; rayarg41@gmail.com
- Babcock, Bryce W** 2009; Retired Engineer; Home: 142 Tower Dr, Saline 48176; 734-429-2249; babcockjb@comcast.net
- Barden, Jr., Robert J (Bob)** 1986; Spouse: Marti; Retired Business Owner; Home: 7368 Strieter Ct 48103; 734-665-2250; rjbarden@arborps.com
- Barden, Kathleen (Kathy)** 1987; Retired Business Owner; Home: 3036 Hideaway Beach Dr, Brighton 48114; 810-229-7517; cell: 734-645-0491; KathleenBarden19@gmail.com
- Barhydt, Rose Marie**, Emerita Member; 2006; Retired Teacher/Administrator; Home: Story Point, 6230 S State St, Apt 271, Saline 48176; cell: 704-604-5509; rosemariebarhydt@gmail.com
- Barrett, Michael J (Mike)**, Emeritus Member; 2005; Spouse: Joan; Retired Teacher; Home: 404 S Glendale Dr 48103; 734-665-9452; barretts404@comcast.net
- Bassett, John R** 1994; Retired Educator; Home: Story Point, 6230 S State St, Apt 221, Saline 48176; 734-585-5662; cell: 734-707-6699; jayrbass@umich.edu
- Beeman, Gordon L** 1985; Spouse: Anna; Retired Attorney; Home: 2295 Chaucer Dr 48103; 734-995-1788; cell: 734-864-6150; glbeeman@umich.edu
- Bell, David T (Dave)** 1988; Spouse: Judy; Retired Clergy; Home: 2 Eastbury Ct 48105; 734-994-0018; cell: 734-646-8475; dave@interfaithspirit.org
- Benedek, Richard S (Dick)** 1963; Spouse: Elissa; Retired Attorney; Home: 3607 Chatham Way 48105; 734-663-7128; cell 734-604-8856; epb@umich.edu
- Blomquist, James M (Jim)** 2003; Spouse: Donna; Retired Accountant; 418 Cottonwood Ln, Saline 48176; 734-316-7256; jblom48105@comcast.net
- Bomar, Francine M** 2018; Spouse: Horace; Retired Administrator; Home: 5160 Christine Dr 48103; 734-761-7487; cell: 734-645-3638; fbomar@umich.edu

MEMBERS

- Brokaw, Theron M (Ted)** 2013; Spouse: Deborah; Manager-Financial Reporting, Comerica Bank, 26000 Six Mile Rd, Livonia 48152; 734-632-7071; cell: 313-806-0216; Home: 2521 Mallard Ct 48105; 734-663-9722; tmbrokaw@comerica.com
- Brown, Jerry M** 1977; Spouse: Lyn; Retired Business Owner; cell: 810-523-5259; Home: 641 Scio Church Rd 48103; 734-994-5005; edgbrown@aol.com
- Buhrer, Patricia M (Pat)** 1988; Spouse: Arno; Retired Registered Nurse & Bereavement Specialist; Home: 755 Patricia Ave 48103; 734-996-0332; annarborite@earthlink.net
- Burg, Alan J** 1999; Spouse: Ken Hillenburg; Retired Educator; Home: 2842 Leslie Park Circle 48105; 517-403-7365; alan.burg@me.com
- Burroughs, Daniel L (Dan)** 2002; Spouse: Adrienne; Retired Teacher, Ann Arbor Public Schools; Home: 2343 Peters Rd 48103; 734-663-3831; cell: 734-604-8992; danlbrgrhs@gmail.com
- Carey, James M (Jim)** 2003; Realtor, Charles Reinhart Co. Realtors; office phone: 734-769-3800; Home: 1330 Astor Ave, #1713, 48104, cell: 734-717-5591; jcarey@provide.net
- Carr, Beatrice Joan (Joan)** 2005; Office Assist, Ann Arbor Figure Skating Club, 2121 Oak Valley Dr, 48103; 734-213-6768; Home: 242 Victoria Dr, Dexter 48130; cell: 734-320-4581; bjoan.carr@gmail.com
- Carr, Robert I (Bob)** 1982; Spouse: Jeannette; Retired Prof of Civil Engineering at UM & Consulting Civil Engineer; Home: 542 Heritage Dr 48105; 734-665-8287; ricarr@umich.edu
- Conlin, Edward F (Ed)**, Emeritus Member; 1962; Spouse: Doris; Retired, Retail Management; Home: 2115 Nature Cove Ct, Apt 108, 48104; 734-975-1976; ed0810@aol.com
- Conlin, Jr, Robert J (Bob)** 1990; Spouse: Julie; President, R J Conlin, Inc., 3025 Boardwalk Dr, Suite 100, 48108; 734-205-1532; Home: 2521 Towner Blvd 48104; 734-973-8538; conlin@rjconlin.com
- Cross, Harry L** 1991; Spouse: Carmen; Retired; Home: 3207 N Wagner Rd 48103; 734-769-3241; cell: 734-395-8097; hlcross@umich.edu
- D'Angelo, Marianne Elizabeth** 2016; Licensed Clinical Psychologist, Founder/Owner, Dexter Psychological Services, 8011 Main St., Dexter 48130; fax: 734-235-0087; cell: 734-395-9380; Home: 7680 Hudson Ct., Dexter, 48130; doctormdangelo@gmail.com
- Dabbs, Michael F (Mike)** 1981; Spouse: Pamela; Retired Executive; Home: 3124 Fawnmeadow Ct 48105; Landline and fax: 734-668-4884; cell: 734-883-4884; mfdabbs10@gmail.com
- Dahl, Claire K** 2011; Spouse: John; Retired High School Teacher; Home: 5196 Doral Ct 48108; 734-470-6196; cell: 734-395-8742; apqueen.claire@gmail.com
- Dahl, John E** 2004; Spouse: Claire; Retired Human Resources Manager; Home: 5196 Doral Ct 48108; 734-470-6196; cell: 734-395-3840; jedwardd20@gmail.com
- Dailey, Suzanne (Sue)** 2014; Retired, UofM; Home: 6889 Wellington Dr, Dexter 48130; 734-426-4267; sudailey@umich.edu

MEMBERS

- Dever, C Nicholas (Nick)** 1974; Spouse: Nancy; Retired Attorney; Home: 13877 E Old US 12, Chelsea 48118; cell: 734-368-3069; ndever46@gmail.com
- Dever, Dana A (Dan)** 1977; Spouse: Sharon Smith; Attorney, DeLoof, Dever, Wright, & Milliman, PLLC, 301 N Main St, Suite 250, 48104; 734-994-1295; cell: 734-646-8228; ddwmlaw.com; Home: 6600 Bethel Church Rd, Saline 48176; 734-944-9963; danaadever@aol.com
- Dick, G. Griffith (Griff)** 2014; Spouse: Jeanne Kuo; Retired Attorney; Home: 600 Westwood Ave 48103; cell: 734-355-2339
- Dittmar, Larry E** 2017; Spouse: Prudy; Retired Educator; Home: 5599 Gallery Park Dr, 48103; 734-662-8811; lpdittmar66@gmail.com
- Donner, Garrett J (Garry)** 1994; Spouse: Karen; President, Random Games & Toys, 416 W Huron St 48103; 734-761-9140; cell: 734-476-1322; Home: 6451 Gallery Dr, Canton 48187; 734-416-1815; garryrgt@gmail.com
- Drake, David J (Dave)** 1968; Spouse: Marilyn; Retired Investment Planner; Home: 4897 Doral Dr 48108; 734-623-4433; djdstatman@gmail.com
- Dries, James L (Jim)** 2018; Spouse: Cathie; Retired Chief Deputy Clerk, Washtenaw County; Home: 3840 Michael Rd 48103; 734-662-6256; cell: 734-972-6010; jdries27@gmail.com
- Dukes, Clarence E (Clarey)**, Emeritus Member; 1965; Retired Dental Education Administrator, UofM; Home: 2424 Dayton Dr 48108; 734-677-1157; clarpeg5566@gmail.com
- Duquette, Kathy J** 2019; Spouse: Don; Retired Fundraiser for UofM; Home: 505 E Huron St, #603, 48104; cell: 734-239-3495; kduquett@umich.edu
- Elling, Gary R** 1985; Spouse: Liz; Retired Engineer; Home: 1402 Maywood Ave 48103; cell: 734-223-2999; garyelling@comcast.net
- Evans, Garrett H (Garry)** 2001; Spouse: Mary; Retired Prof of Civil & Environmental Engineering, UofM; Home: 1720 Coburn Ct 48108; cell: 734-730-6181; mar99gar@hotmail.com
- Fegan, Thomas J (Tom)**, Emeritus Member; 1965; Retired County Planner; Home: University Senior Living, 2865 S Main St 48103
- Fomby, Paula** 2017; Spouse: Richard Miech; Research Assoc. Prof, UofM Institute for Social Research, 426 Thompson St, 48106; 734-763-3850; Home: 1430 Granger Ave 48104; 734-845-9728; cell: 303-349-4098; pfomby@gmail.com
- French, Larry E** 1994; Spouse: Linda; Retired Financial Consultant; Home: 2201 Twin Islands Ct 48108; 734-994-6599; cell: 734-276-1253; flarry117@gmail.com
- Gallagher, Paul Thomas** 2019; Attorney, Gallagher & Gallagher, PLC, 7920 Jackson Rd, Ste B, 48103, 734-996-1070; Home: 6 Jefferson CT, 48103, 734-645-2191; paul@gallagherlex.com
- Gallup, Albert E (Al)** 2001; Spouse: Karen; Retired High School Principal, Ann Arbor Public Schools; Home: 1201 Bydding Rd 48103; 734-662-1559; buffigal@gmail.com

MEMBERS

- Gardner, Ronald D (Ron)** 2001; Spouse: Diana; Attorney, Gardner & Associates PC, 1601 Briarwood Circle, Suite 200, 48108; 734-669-0424; cell; 734-904-4369; fax: 734-665-6179; Home: 159 Kingsbrook Ave 48103; 734-663-6611; rgardner035@gmail.com
- Gilligan, George J** 1988; Spouse: Mary; Retired Wealth Manager; cell: 734-417-9138; Home: 1450 Glastonbury Rd 48103; 734-994-5820; gilligangeorge6@gmail.com
- Goodkin, Mitchell A (Mitch)** 2016; Spouse: Barb; Retired Lawyer and Retired Licensed Professional Engineer; Home: 2658 Esch Ave, 48104; 734- 971-0899; cell 734-417-2340; mitchjdpe1@gmail.com
- Goss, Ryan H** 2001; General Manager, Muehlig Funeral Chapel, 403 S Fourth Ave 48104; 734-663-3375; Home: 772 Jackson Ln, Milan 48160; cell: 734-985-1168; ryan.goss@dignitymemorial.com
- Grachek, Caroline Marie** 2017; Curriculum Assistant, UM Ross School of Business, 700 E University 48104, Home: 618 S Main, Apt. 625, 48104; cell: 734-624-5599; cmgrache@umich.edu
- Gray, Robert H (Bob)** 2007; Spouse: Susan Smith; Emeritus Professor, UofM; Home: 2360 Londonderry Rd 48104; 734-668-0798; cell: 734-604-4977; Pinckney Lake Home: phone: 810-231-1412; rhgray@umich.edu
- Greene, Robert (Bob)**, Emeritus Member; 2003; Spouse: Elaine; Retired Engineer; Home: 1281 Laurel View Dr 48105; 734-665-5890; greenrob@sbcglobal.net
- Gupta, Jyoti** 2019; Spouse: Vinay; Development Director, The Women's Center, 510 S Maple Rd, 48103; 734-973-6779; Home: 3092 Walnut Ridge Dr. 48103; 734-332-9515; cell: 734-260-4174; jyotivgupta@gmail.com
- Hadwin, Karen A** 2018; Retired UofM Hospital Administrator; Home: 11834 Eriksen Dr, Pinckney 48169; cell: 808-286-1995; khadwin@hotmail.com
- Hampton, William V** 2013; Spouse: Esther; Retired, City Government; Home: 1184 Wendy Ct 48103; 734-665-6347; cell: 734-417-6902; wvhamp@comcast.net
- Hanton, Douglas O (Doug)**, Emeritus Member; 1965; Spouse: Ann; Retired Banker; 7238 Eaton Ct, Dexter 48130; 734-580-2107; dahanton@sbcglobal.net
- Harper, Betty Jean Roseum** 1993; Visiting Vet; Office & Home: 3409 Rentz Rd 48103; office: 734-475-9474; home: 734-433-1550
- Hawkins, Harry Payne** 2018; Spouse: Jan; General Manager, West Hawk Industries, 1717 S State, 48104; 734-761-3100; Home: 1790 Arlington, 48104; 734-662-0107; cell: 734-646-8467; sales@westhawkpromo.com
- Heller, Frederic W (Bill)** 2015; Spouse: Diane; Retired Attorney; Home: 4225 Hawthorn Place 48103; 734-253-2063; cell: 734-945-9575; fwheller@concentric.net
- Hendricks, Richard D (Rick)** 1978; Spouse: Deborah; Retired Accountant; Home: 3325 Brassow Rd, Saline 48176; cell: 734-649-3232; rdhendricks51@gmail.com
- Hillenburg, Kenneth L (Ken)** 2011; Spouse: Alan Burg; Retired Clinical Prof, School of Dentistry, Univ of Detroit Mercy; Home: 2842 Leslie Park Circle 48105; 517-673-6000; hillenburg@me.com

MEMBERS

- Hiller, Steven J (Steve)** 2004; Spouse: Wendy; Chief Assistant Prosecutor, Washtenaw County, 200 N Main St, Suite 300, 48107; 734-222-6603; cell: 734-474-6663; Home: 1175 Morehead Ct 48103; 734-761-2476; stevenjhiller@gmail.com
- Hughes, David A (Dave)** 2007; Spouse: Bonnie. Retired Engineer; Home: 3520 Paisley Ct 48105; 734-665-2674; hughesda@comcast.net
- Johnson, Robert M (Bob)** 1998; Spouse: Linda; Retired Clinical Toxicologist; Home: 1522 Arborview Blvd 48103; cell: 734-330-3247; johnsonr07@comcast.net
- Jones, Deborah A (Deb)** 2013; Spouse: Steven; Vice President-Trust & Investment Mgt, Bank of Ann Arbor, 125 S Fifth St 48104; 734-327-1139; fax: 734-669-2493; Home: 1136 S Seventh 48103; 734-996-2334; debjones@boaa.com
- Kavanagh, Gary K** 2016; Owner, Tropical Interiors; Office and Home: 4701 Ann Arbor-Saline Rd. 48103; cell: 734-662-2289; garykevin09@gmail.com
- Keyes, Sharon** 1998; Spouse: Landis; Retired; Home: 609 Sunset Rd 48103; 734-662-7702; cell: 734-476-3265; keyes.sharon@gmail.com
- Kidle, John M** 1985; Spouse: Marykay; Retired Banker; Home: 7646 Purple Martin Way, Dexter 48130; 734-665-6162; cell: 734-756-7056; jkidle@gmail.com
- Kinney, Richard E (Rip)** 1995; Retired High School Coach/Counselor, Pioneer High School; Home: 1942 Peppermill Way 48103; 734-663-0826; rip.kinney@juno.com
- Kinzinger, John F** 2018; Spouse: Jane; Retired Engineer Supervisor, Ford Motor Co.; Home: 1717 W Huron River Dr 48103; cell: 734-645-8647; johnalva@aol.com
- Koch, Laura** 2019; Spouse: Jeffrey Koch; Assist Vice Pres, Old National Bank, 2723 S State, Ste 110, 48104; 734-887-2610; Home: 2750 S MI State Rd 52, Chelsea 48118-9690; cell: 734-972-6227; Laura.Koch@oldnational.com
- Kossick, Donald J (Don)** 1995; Spouse: Karen; Retired Educator; Home: 1405 E Park Place 48104; 734-665-2758; cell: 734-272-7953; kkoss@comcast.net
- Kotch Duda, Andrea** 2009; Spouse: Walt; Senior Vice President, Investments, Raymond James & Associates, Inc.; 31500 Northwestern Hwy, Suite 150, Farmington Hills 48334, 248-932-5450; cell: 313-719-9034; Home: 15034 Fox, Redford 48239; 313-531-4363; andrea.kotchduda@raymond-james.com
- Krasnoff, Margaret J** 2015; Spouse: Justin; Attorney, DeLoof, Dever, Wright, & Milliman PLLC, 301 N Main St, Ste 250, 48104; 734-994-1295; cell: 734-834-7811; mjk@ddwmlaw.com; Home: 5555 Gallery Park Dr 48103; 734-665-2236; margaretjkrasnoff@gmail.com
- Lamkin, Burton (Burt)**, Emeritus Member; 1998; Spouse: Sally; Retired Educator; Home: 900 Egret Dr, Chelsea 48118; 734-562-2307; bla3939@aol.com
- Lamkin, Sally A**, Emerita Member; 1998; Spouse: Burt; Retired Educator; Home: 900 Egret Dr, Chelsea 48118; 734-562-2307; bla3939@aol.com

MEMBERS

- LaMoreaux, David (Dave)** 2015; Spouse: Linda; Retired Project Manager, NSF *International*; Home: 1600 Arbordale 48103; 734-761-4322; cell: 734-717-2474; dtlamx@gmail.com
- Lande, Lynne P** 1987; Psychotherapist, Samaritan Counseling Center of Southeastern Michigan, 29887 W Eleven Mile, Farmington Hills 48336; cell: 734-649-0583; Home: 1845 E Joy Rd 48105; lynnelande@me.com
- Lavin, Eloise** 2015; Spouse: Mark; Owner, Lavin Consulting, LLC; Office & Home: 2020 Scio Church Rd. 48103-6061; cell: 734-255-0242; eloise@lavinconsulting.net
- LeRoy, Evan C** 2008; Spouse: Anna; Portfolio Manager, Retirement Income Solutions, 2301 Platt Rd, Ste 300, 48104; 734-769-7727; Home: 996 Marshall Lakes Dr, Dexter 48130; cell: 269-501-3299; evleroy@gmail.com
- Leslie, Dale R** 1979; Retired Retail Store Owner; cell: 734-660-1023; Home: 1159 Joyce Lane 48103; daleleslie@comcast.net
- Linden, Terry M** 2016; Owner, Empire of Ideas, Inc., P. O. Box 1961, Ann Arbor 48106-1961; Home: 811 S 5th St, Apt 1, 48103-4869; cell: 734-369-6269; TerryEmpireOfIdeas@gmail.com
- Lofstrom, Lennart (Len)** 2018; Spouse: Betty; Retired Dentist; Home: 3630 W Greenook Dr 48103, 734-426-8918; cell: 734-645-2691; lnlofstrom@aol.com
- Lopatin, Dennis E** 2019; Emeritus Professor (Immunologist), UofM School of Dentistry; Home: 660 Burr Oak Dr, 48103; cell: 734-904-0605; dlopatin6@gmail.com
- Luke, Gerald L (Gerry)** 2016; Spouse: Phyllis. Retired, Engine Manufacturing Engineering Manager, Ford Motor. Home: 5139 Polo Fields Dr., 48103; 734-214-5292; cell: 734-660-1972; gerryluke@mac.com
- Mattson, Ann E** 1990; Spouse: Jim; Retired Judge, 15th District Court; Home: 1716 Ridge Rd, Chelsea 48118; 734-475-2879; cell: 734-358-4425; mattana2@aol.com
- Mattson, James A (Jim)** 2010; Spouse: Ann; Retired, UofM Credit Union; Home: 1716 Ridge Rd, Chelsea 48118; 734-475-2879; mattana2@aol.com
- McMahon, Gerald F (Jerry)** 1992; Jerry's Painting; Office & Home: 1472 Borgstrom Rd, Ypsilanti 48197; 734-482-5408; cell: 734-383-7653; jerrymcmah@aol.com
- McNab-Cattell, Dorothy M (Dot)** 2008; Retired Educator; Home: 351 Barton Shore Dr. 48105; 734-665-0702; cell: 734-476-7300; dotcatt734@gmail.com
- Mehraban, Sara** 2011; Financial Advisor, Ameriprise Financial Services, 4750 Venture Dr, Ste 150, 48108; 734-477-5233; fax: 734-477-5288; sara.x.mehraban@ampf.com
- Meisner, Gregory P (Greg)** 2015; Spouse: Gretchen Preston; Retired Research Scientist; Home: 4660 W Ellsworth Rd 48103; cell: 734-717-8253; gpmeisner@hotmail.com
- Meretta, James L (Jim)** 1978; Spouse: Kristy; Retired Trust Advisor; Home: 700 Lans Way St 48103; 734-663-2534; cell: 734-476-6128; jmeretta@sbcglobal.net

MEMBERS

- Miller, Frederick H (Fred)** 2014; Spouse: Gae; President, Fred Miller Associates LLC; Home: & Office: 1459 Covington Dr 48103; cell: 734-904-6811; fmiller634@gmail.com
- Niemann, Walter W (Wally)** 1952; Retired Dentist; Home: 5353 McAuley Dr., Apt. 323, Ypsilanti, 48197; cell: 734-646-4157; wwniemann@sbcglobal.net; website: DDSWally.com; ddswwally youtube
- Okuley, Jeanette M**, Emerita Member; 1989; Home: 3250 Kingwood St 48103; 734-996-3593; okuleyjm@att.net
- Panning, Luke** 2015; Spouse: Katherine; Financial Advisor, Edward Jones, 213 N Maple Rd 48103; 734-761-5309; fax: 888-311-2232; cell: 616-990-7083; Home: 1217 Island Dr, #203, 48105; luke.panning@gmail.com
- Petroski, Martha J** 2009; Retired; Home: 2326 Packard St 48104; 734-761-3740; cell: 734-320-0146; marthp3@gmail.com
- Phibbs, Charles A (Charlie)** 1990; Retired, Sales Electrical Construction, McNaughton-McKay Electric Co; Home: 1610 Dexter Ave #2, 48103; cell: 734-646-7825; orvis50@yahoo.com
- Powers, Dennis M** 2011; Spouse: Jeanie; Principal, DM Powers & Associates, 317 S Division St 48104; 978-886-4554; Home: 2018 Carhart Ave 48104; 734-741-5140; carhart2018@aol.com
- Presley, Carol Lynn** 2018; Owner, Carol's VIP Adventures; Home and Business: 2420 North St, Milford 48380; cell: 248-390-2340; carolsvipadventures@gmail.com
- Preston, Gretchen** 2008; Spouse: Greg Meisner; Owner, Gretchen's House Child Development Centers, 4531 Concourse Dr 48108; 734-761-2576; Home: 4660 W Ellsworth Rd 48103; cell: 734-260-9027; gretchen.preston@gretchenshouse.com
- Rabidoux, Sandra M (Sandy)** 2017; Spouse: Mark; Paralegal, Mark K Rabidoux, PLC, PO Box 1287, 48106, 734-994-6523; fax: 734-261-2580; Home: 1714 Tudor Dr, 48103; cell: 248-225-3908; sm-mamo@sbcglobal.net
- Reed, Steven A (Steve)** 1993; Owner, Reed Law Group PC, 2178 S State St, Suite A, 48104; 734-761-5860; fax: 734-761-5861; Home: 200 Briarcrest Dr, #120, 48104; steve@reedlawgroup.com
- Reynolds, James A (Jim)** 2002; Spouse: Ligia; Retired Professor, EMU; Home: 1475 Maywood Ave 48103; 734-665-0012; cell: 734-546-0932; jaliro@comcast.net
- Robb, Michele D** 2010; Owner, MDR Consulting, 3588 Plymouth Rd, #255, 48105, 734-358-0223; Home: 2529 Meade Ct, 48105, cell: 734-358-0223; mdrobb@comcast.net
- Robb, William C (Bill)** 1999; Spouse: Phyllis; Retired Manager; Home: 566 Heritage Dr 48105; 734-769-3286; cell: 734-389-5232; wrobb@comcast.net
- Roberts, Edward C. III (Bud)** 2016; Retired; Home: 6655 Jackson Rd, Scio Farms Estates #98, 48103; 734-426-5102; cell: 734-320-3898
- Robinson, Jean M** 2000; Retired Medical Social Worker; Home: 1020 Cedar Bend Dr 48105; 734-662-6303; jean.robinson@mygait.com

MEMBERS

- Rupp, Brittany** 2019; Research Assistant, UofM, 2800 Plymouth Rd, 48109-2800; Home: 2174 Stone Rd, 48105-2535; cell: 845-421-3495; brupp95@gmail.com
- Salemi, Tony** 2016; Retired Manager; Home: 4705 Sawgrass Dr, E, 48108; cell: 954-242-1067; tons48108@gmail.com
- Sampselle, John L**, Emeritus Member; 1988; Spouse: Carolyn; Retired Finance Manager; Home: 1230 Bardstown Trail 48105; 734-761-1859; cell: 734-239-1442; jsampselle@gmail.com
- Sanchez, Federico I (Fred)** 1980; Property/Facilities Mgt; Home: 2645 Gladstone Ave 48104; cell: 734-277-7077; fsanchez@aol.com
- Schechtman, Perry** 1988; Dept Administrator, UofM Department of Ophthalmology, 1000 Wall St 48105; 734-763-4658; Home: 1428 Coventry Sq Dr 48103; 734-662-0050; cell: 734-649-1782; pschecht@umich.edu
- Schenk, John E** 2011; Spouse: Nancy; Retired Engineer; Home: 3309 Yellowstone Dr 48105; 734-663-9249; cell: 734-255-1797; jeschenk@comcast.net
- Schmerberg, Kurt R** 1980; Spouse: Jane; Vice-President, Affinity Valuation Group LLC, 1310 S Main St, Suite 7, 48104; 734-747-7080; Home: 800 Mt Vernon Ave 48103; 734-662-5928; kurt@provide.net
- Schork, Peter F (Pete)** 1988; Spouse: Annette; President & CEO, Ann Arbor State Bank, 125 W William, 48104; 734-761-1480; fax: 734-761-4780; cell: 734-417-6733; Home: 852 Sciomeadow Dr 48103; Peterschork@gmail.com
- Shaw, Kenneth A (Ken)** 2001; Self-employed Computer Programmer; Home: 910 Heather Way 48104; 734-971-1445; khaw@comcast.net
- Sheldon, Clifford G (Cliff)** 1976; Spouse: Ingrid; Retired Banker; Home: 1416 Folkstone Ct 48105; 734-665-5893; cliff.sheldon@gmail.com
- Smit, Richard L (Dick)** 2011; Spouse: Dee; Retired Civil Engineer; Home: 1441 Greenview Dr 48103; 734-995-1157; dsmit2@comcast.net
- Smith, Susan M** 2017; Spouse: Bob Gray; Retired Actuary; Home: 2360 Londonderry Rd., 48104; Lake home: 810-231-1412; cell: 734-834-0374; smithsms@umich.edu
- Snider, C Robert (Bob)**, Emeritus Member; 1978; Spouse: Luz; Retired Meteorologist; 165 Kingsbrook Ave 48103; 734-665-8890; cell: 734-255-5584; luzvictoria@ameritech.net; crbobsnider@gmail.com
- Soyars, Caroline R** 2018; Program Manager, UofM, Room 1305, G. G. Brown Laboratory, 2350 Hayward St 48109; 734-764-9366; Home: 211 Stevens Dr, Apt 302, Ypsilanti 48197; cell: 630-857-0651; csoyars@umich.edu
- Stewart, Mary** 2017; Spouse: Andrew Tay; Manager, Warm The Children; 734-945-4955; Home: 2988 S Foxridge Ct 48105; cell: 734-945-4955; mkcstewart61@gmail.com
- Streich, Kimberly (Kim)** 2019; Philanthropy Manager, Arbor Hospice, 2366 Oak Valley Dr, 48103; 734-794-5120; kstreich@hom.org

MEMBERS

- Summers, Carla Jo** 2019; Spouse: Morris Wertenberger; Retired Nurse; Home: 1112 Harold Circle, 48103; cell: 734-430-6909; disnetkid0717@gmail.com
- Supica, Max** 2000; Spouse: Sue; Retired, Logistics, Ford Motor Co; Home: 220 Katherine Way, Dexter, 48130; cell 734-649-6837; maxsupica@aol.com
- Talcott, M Jane (Jane)** 2007; Exec Director, Washtenaw Camp Placement; 734-971-4537; Home: 6886 Ernst Rd, Manchester 48158; 734-428-8890; cell: 734-678-1696; talcoj@yahoo.com
- Taylor, Robert J (RJ)**, Emeritus Member; 1950; Retired Salesman; Home: 6230 S State St, Apt 6, Saline 48176; cell: 734-355-4530; rjtaylor25@gmail.com
- Tse, Lai Yu Leo (Leo)** 2018; UM Research Fellow, Mech. Engin. 2350 Hayward St, 48109; Home: 2227 S State St, Apt #115, 48104; cell: 607-661-8823; tselaiyu@umich.edu
- Webb, Ellen F** 1991; Owner, Ellen's Quilt Creations; Home: & Office: 650 Cherry Grove, Canton 48188; 734-927-4008; cell: 734-516-7975; ellen@ellensquiltcreations.com
- Wilder, Kathie E** 2014; Retired Development Officer; Home: 623 Susan Dr 48103; cell: 734-660-5135; kwildera2@gmail.com
- Williams, Julianne C** 2001; Spouse: Jeff; Owner, Fountain Communications; Office & Home: 6566 Lexington, Whitmore Lake 48189; cell: 734-358-2603; julanne1@me.com
- Williams, Melvin D (Mel)** 1993; Emeritus Professor of Anthropology, UofM; 734-764-7153; cell: 412-302-9108; fax: 734-763-6077; Home: 3 Parkview Place, #1, 48103; 734-665-9537; mddoublu@umich.edu
- Winkler, Christopher B (Chris)** 2007; Spouse: Noel Ann; Research Scientist Emeritus, UofM Transportation Research Institute, 2901 Baxter Rd 48109; 734-936-1061; Home: 65 Barton Lane 48105; 734-761-9409; cell: 734-678-6849; cbw@umich.edu
- Wishka, Mark S** 1998; Spouse: Narda; Retired Wealth Adviser; Home: 211 Third St 48103; cell: 734-945-9400; mswishka@comcast.net
- Wolfington, James L (Jim)** 2004; Spouse Ernest Kalina; Vice President, Chelsea State Bank, 1010 S Main St, Chelsea 48118; 734-385-1131; fax: 734-475-7740; Home: 110 N Revena Blvd 48103; jwolfington@csbonline.com
- Ziegler, Jr, Max M** 1967; Spouse: Carol; Retired Banker; Home: 2117 Carol Dr 48103; 734-662-3303; cell: 734-649-3979; antiquesz@aol.com
- Ziesemer, Douglas F (Doug)** 1978; Spouse: Pam; Realtor, RE/MAX Platinum Realtors, 325 W Eisenhower Pkwy 48103; 734-769-8111; fax: 734-623-8455; cell: 734-395-2092; Home: 3535 Meadow Grove Trail 48108; dfziesemer@aol.com



Remembering Bob Barden, Sr., member of the Kiwanis Club of Ann Arbor for 58 years



*Robert J. Barden, Sr.
KCAA Past President and
Recipient of the Frank O. Staiger
Distinguished Kiwanian Award*

KNIGHT'S MARKET



420 Miller Ave. • Ann Arbor, MI 48103 • (734) 665-6494

Prime Beef • Amish Chicken • Pork



FAMILY FUNERAL HOME &
CREMATION SERVICE, INC.

Carpenter Road Chapel
2400 Carpenter Road
Ann Arbor, MI 48108
(734) 971-2345
(734) 971-3057 Fax
info@niefuneralhomes.com

Liberty Road Chapel
3767 W. Liberty Road
Ann Arbor, MI 48103
(734) 302-1000
Fax (734) 302-7440
www.niefuneralhomes.com

Kiwanis Young Professionals (KYP) Washtenaw County



KYP formed as a club satellite of KCAA in January of 2016. The KYP mission statement is:

Build an inclusive group of young professionals who focus on service, stewardship, and development in the Washtenaw County area while mindfully observing the Objects of Kiwanis (page 1).

KYP meets in the evening on a monthly basis at various local restaurants. These times are used to plan unique volunteer projects and social events.

Active KYP club members are: Emily Allshouse, Caroline Grachek, Luke Panning, Brittany Rupp, Caroline Soyars, Leo Tse, and Julanne Williams.

Find more information including KYP meeting times at:

<https://a2kiwanisfoundation.org/young-professionals/>

<https://kiwanisyp.org/>

Duda

WEALTH ADVISORS

of

RAYMOND JAMES®

ANDREA KOTCH DUDA, CFP®

Senior Vice President, Investments

31500 Northwestern Hwy., Suite 150 // Farmington Hills, MI 48334

TF 800.548.8008 // 248.932.5450 // Fax 866.522.9601

andrea.kotchduda@raymondjames.com

raymondjames.com/andreakotchduda

CFP Board owns the CFP® and CERTIFIED FINANCIAL PLANNER™ marks in the United States.

© 2018 Raymond James & Associates, Inc., member New York Stock Exchange/SIPC. 18-BR35N-0187 TA 8/18



The Kiwanis Center

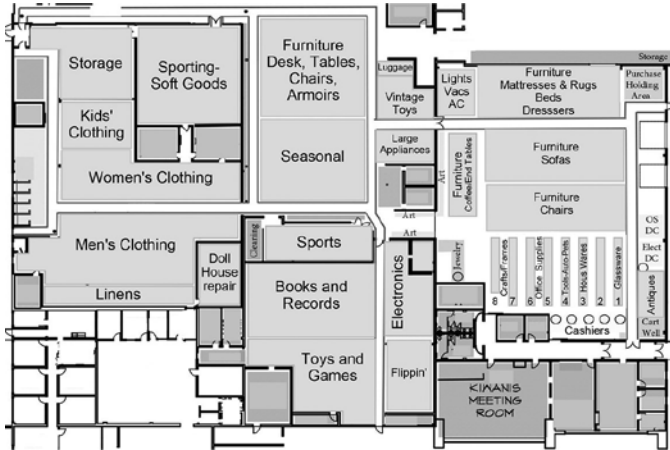

Layout of the Sales Floor of the Kiwanis Thrift Sale

WE DID IT !



**\$1,037,700 in sales
in 2018-2019**

2019-2020 KIWANIS CLUB SCHOLARSHIP PROGRAM WASHTENAW COMMUNITY COLLEGE SCHOLARSHIPS

This year, the Kiwanis Club of Ann Arbor has provided 20, full-ride scholarships for graduates of the Ann Arbor Public schools attending Washtenaw Community College in the 2019-20 academic year. Funding for this program derives from contributions by the club and by individual members, and from matching funds from the Ray and Eleanor Cross Foundation.

Each of the 20 scholarships awarded is for \$3500. The club has also contributed an additional \$2000 to an emergency fund, for a total contribution in 2019-20 of \$72,000. Each scholarship will cover the student's expenses for tuition, books, and fees for the entire year. Our contribution to the emergency fund will help support students who experience unexpected, hardship expenses. The Washtenaw Community College Foundation administers the funds we donate.

Eight of the 20 scholarships awarded this year are for first-year students with financial needs, who are Ann Arbor residents and 2019 graduates of the Ann Arbor Public Schools. The other 12 scholarships were awarded to students who are also AAPS graduates and have successfully completed their first year at WCC, but would likely be unable to continue their studies without additional financial support.

Six of the 2019-20 Kiwanis-WCCF scholars were able to attend our Scholarship Day program on October 21, 2019. They are:



Latitude Brown



Miguel Cisneros



Michael Kelley



Abdul Kizito



Diego Morales



Eric Nordman

Other 2019-20 Kiwanis-WCCF scholarship recipients include *D' K' Len Brann, Yasmin Guadalupe, Ashley Lawrence, Khan Luong, Jason Massey, Muzzammil Riaz, Jeanie Rodriguez, Jean Valenzuela Sanchez, Makenzie Smith, and Andrew Waddles.**

* The names of some scholarship recipients were not available at the time of publication due to student-privacy restrictions.

MUSIC CAMP SCHOLARSHIPS

The Kiwanis Club of Ann Arbor also provides Music Camp scholarships to deserving middle-school students from the Ann Arbor Public Schools. The six recipients for 2019 are:



Charis Crawford



Zion Dottery



Alexandria Miller



Leo Nelson



Griffin Siersma



Chana Weiss

VOLUNTEERS

*Our Kiwanis Volunteers
Are the People Who
Make It All Work*



Aiken, Erin



Bagchi, Carol



Bartlett, Lisa



Bignall, Gloria



Bingham, Eve



Birkle, Aaron



Birkle, Lea



Birkle, Mike



Boone, Elizabeth



Burbridge, Cecile



Buttrum, Carole



Canham, Steven



Cebulski, Linda



Choate, Susan



Clear, Janet



Clemence, Mary



Connellan, Sandra



Conway, Pamela



Cooper, Nancy



Coughlin, Patty



Cramer, Susan



Crittenden, Corey



Damon, Jill



Danforth, Jim



Day, Mary Beth



Dever, Nancy



Dittmar, Prudy



Doyle, Bernie



Evans, Mary



Ferguson, Mary



Finch, Billy



Frederick, Muriel



Gallup, Karen

VOLUNTEERS



Gerlinger, Rick



Gorecki, Christine



Gravlin, Katherine



Haas, Jared



Hammerschmidt, Cynthia



Hammerschmidt, Jerry



Harback, Mike



Hart, Kim



Hill, Mary



Hitchcock, Kate



Jackson, Anne



Johnson, Linda



Jones, Ken



Kochis, Jeremy



Krueger, Susan



Laird, Carole



Lillie, Joan



Lillie, Rob



Lipson, Andrea



Lutton, Louise



Lyman, Fran



MacDonald, Margaret



Madison, Donald



Marshall, Cathy



Marshall, Dennis



Mast, Gregory



Masters, Joan



Maten, Glenda



Maten, Ralph



Mathews, Joan



McNish, Jan



McParland, Shane



Meints, Rick



Meneghini, Linda



Messer, Joan



Misko, Susan

VOLUNTEERS



Moler, Kay



Mortensen, Cynthia



Olcott, Cynthia



Potthoff, Robin



Rescorla, Meg



Richard, Veronica



Robb, Phyllis



Rolka, Lynn



Rydson, Debbie



Schaffner, Paul



Schuman, Fred



Schuman, Rhonda



Service, Genia



Shaw, Ron



Sibole, Ann



Simonett, Stewart



Sisson, Marva



Smit, Dee



Soden, Sally



Springer, Sallie



Stein, Joan



Stephens, Gloria



Stephenson, Meg



Stewart, Gayle



Supica, Sue



Talik, Linda



Vogel, Cheryl



Vondenberger, Annette



Wells, Marcia



Wells, Sherrel



Ziegler, Carol



Ziesemer, Pamela

ZELLER FELLOWS

In 2011 Kiwanis International (KI) established the Walter Zeller Fellowship to commemorate Walter Zeller, who made the first gift of 25 silver dollars to establish the KI Foundation. The Zeller Fellowship recognizes a gift of at least \$1,250 to the ELIMINATE Project, an undertaking to raise \$110 million by 30 September 2015 to eliminate maternal neonatal tetanus in mothers and newborns in countries where this disease remains a threat.

On 22 August 2011, our Club membership pledged to donate \$100,000 to the KI worldwide ELIMINATE Project by 30 September 2015, a goal we met and exceeded by raising \$103,185. The names of Zeller Fellows are permanently displayed on a board on the top floor of the Kiwanis Center. Fellows to date are as follows ("c" denotes Charter Fellow; "d" denotes Diamond Fellow):

John R Bassett
Gordon Beeman (c)
Dick & Elissa Benedek
Robert Carr
Don Clewell
Harry L Cross
Alan Dailey
Andrea Kotch Duda
Clarence Dukes
Larry E French (c,d)
Diana Gardner

Ronald D Gardner (c)
George & Mary Gilligan
John Goff
Robert H Gray (c)
Dave Hughes
Robert M Johnson (c)
Fred Keppler
J Thomas Lovell
Ann E Mattson
Jim Mattson
Stephen A Pezda (c)

William Robb
John Sampelle
Clifford G Sheldon (c)
Susan M Smith
Sheridan W Springer (c)
William R Tasch
Jim & Linda Wight
Carl E Williams (c)
Mark & Narda Wishka



Every day has meaning in the definition of a life.



Peace
wvh

CLUB FUNDRAISING AND GIVING

The Kiwanis Club of Ann Arbor began raising money in 1925 by selling newspapers. In 1927 it teamed with King's Daughters, a local church guild, to hold periodic three-day rummage sales in vacant stores and, from 1948 to 1967, in the National Guard Armory. From February 1968 through 1990, sales were held in the Kiwanis Center Downtown (KCD) periodically, thence weekly on Saturday mornings. In January of 2012, through the generosity of Don Butcher, a former club member, and Jake Haas, the club acquired temporary use of an 8000-sq-ft warehouse at 840 Airport Plaza Dr. in which to store and sell furniture and other large items. Then, in 2014, the club's Foundation purchased a 17.4-acre lot, including a warehouse and office complex, located at 100 North Staebler Road, which became the Kiwanis Center West (KCW). Regular Saturday sales began at KCW on June 13, 2015. Sale of the KCD building was completed in January 2018. Consequently, all our Kiwanis activities, including the Thrift Sale, are now held at the Kiwanis Center (KC, previously KCW) at 100 North Staebler Road. Currently, the Kiwanis Thrift Sale is open 50 weeks of the year at KC from 9 AM to 1 PM on Fridays and Saturdays.

Thrift Sale merchandise comes from individuals or organizations who drop off items at KC, and through the pickup service that the club provides. Club members, volunteers, and employees then sort, price, display, and sell donated items. This work often requires conscientious sorting, creative merchandising, and tact. A sorter once found \$660 in an article of clothing; occasionally bills are found hidden in books. Items sold include automobiles, store mannequins, live piglets, tombstones, boats, and organs (musical). Once, four people bought the same sofa on the same day and showed up simultaneously to claim it. Someone mistakenly donated a neighbor's dishes. Members and volunteers have had their own coats and jackets inadvertently sold during a sale. The most successful single sale, a three-day event in 1985, grossed \$80,234. Between fiscal years 2006-07 and 2018-19, annual gross sales have increased from \$241,000 to over \$1,037,700.

Over the years the club has found additional ways to raise funds. It sells donated vehicles through a licensed dealer. It began selling selected items on eBay in 2002, and on craigslist in 2011. On these electronic sites, a few unusual items have sold for hundreds of dollars to more than one thousand dollars. In early January 2011, the club began selling surplus clothing and shoes to recycling agents. The club currently sells our surplus items to Midwest Recycling. This firm picks up the merchandise at the KC, sorts it, and sends it to developing countries for use by citizens there.

Since 1927, the club and its charitable Foundation (formed in 1964) have netted many millions of dollars from our Thrift Sales. The Foundation devotes these net proceeds to supporting many projects of charitable organizations that serve the local community and Washtenaw County. The success of the Thrift Sale depends on the hard work of many club members and dozens of volunteers.

In addition to donating money to charitable organizations, the Foundation gives merchandise to individuals and families in need through two Direct Assistance Programs. One program is operated by the Sales Management Oversight Committee, which, in 2018-2019, provided \$77,700 in direct giving. The club's Community Services Committee administers a second direct assistance program, the Voucher Program, in cooperation with participating local social agencies. In fiscal year 2018-2019, the Committee distributed \$98,300 worth of merchandise to 445 qualified clients of social agencies that serve the greater Ann Arbor community. Each year, the club's Foundation—together with contributions from club members and others, which are matched by monies from the Ray and Eleanor Cross Foundation—also awards academic scholarships and camperships to deserving area youth. This year, these awards totaled \$72,000 for full-ride academic scholarships to Washtenaw Community College for 20 graduating seniors from Ann Arbor high schools, plus \$44,900 for Summer Camperships for children and youth of Washtenaw County. The Foundation has also donated clothing to people in need worldwide, especially to orphanages and countries that have suffered natural disasters. Annually, the Thrift Sale's Book Department donates thousands of surplus children's books to teachers and libraries of K-12 schools in Ann Arbor and Detroit. In July of 2017, the Foundation assumed sponsorship of the Warm the Children program of Washtenaw County. This year our club raised and disbursed \$135,000 for winter clothing for 1500 area children and families.

Through all of these programs combined, the club and Foundation have donated over \$7.2 million in money and merchandise to charities and individuals since the club's inception in 1921.

HIXSON FELLOWS

Kiwanis International (KI) established the George F. Hixson Fellowship in 1983 to honor its first president. Fellows are selected in one of two ways. First, members of a club, upon making a lump-sum payment of at least \$1000 to the KI Foundation, may designate recipients during their lifetimes or posthumously. Second, a club itself may designate a recipient (e.g., a Club member or her/his spouse) by making a lump-sum payment of at least \$1000 to the KI Foundation.

To be considered for a Hixson Fellowship sponsored by our Club, a member must demonstrate exceptional dedication to the Club and its Objects during the course of a single year. This may be achieved in various ways, such as excellence as chair of a committee, outstanding success in recruiting, extraordinary involvement by a new member, or other comparable contributions to the Club. In exceptional circumstances, the Club may award a Fellowship to a nonmember, provided that the designee has made a contribution to the community commensurate with the Club's standards for Honorary Member status or has made a singular contribution of time and effort to the Club.

During three administrative years (1996-1999), our Club donated a total of \$104,000 to KI for the Worldwide Iodine Deficiency Disorder program. In 2015, we donated an additional \$103,000 to KI for the KIWANIS/UNICEF ELIMINATE project to eliminate maternal and neonatal tetanus. Consequently, KI has extended to our Club the privilege of awarding several dozen Hixson Fellowships. Upon the recommendation of the Member Recognition Committee and approval by the Board, the names of Fellows are permanently displayed in the Kiwanis Center. Fellows to date are as follows ("d" denotes a diamond Fellow):

| | | | |
|---------------------|----------------------|------------------------|-----------------------|
| Leland D Bachman | Dana A Dever | Donald D Kenney | Douglas K Olsen |
| Mary Bachman | Nick Dever | Donald J Kern | Marie Olsen |
| Eleanor Bandrofchak | Garrett J Donner | John M Kidle | Gretchen Preston |
| Kathleen Barden | David J Drake | Fred C King | William Robb |
| Bob Barden, Jr | Clarence E Dukes | Richard E Kinney | John Sampsele |
| Robert J Barden, Sr | Fulton B Eaglin | Lloyd Kitchens | Fred Sanchez |
| John Bassett | Simon Eaglin | Amanda Jane Kitchens | Peter F Schork |
| Gordon Beeman | S J (Sandy) Elden | Thelma Klapper | Clifford G Sheldon |
| David Bell | Gary R Elling | Paul Klingler | Ray Smit |
| Judith A Bell | Al Engerer | Donald J Kossick | Susan M Smith |
| Richard S Benedek | Herbert Estes | Adelaide Laetz | Robert Snider |
| Gloria Bignall | Garrett H Evans | Burton Lamkin | Sheridan W Springer |
| Richard G Bignall | Betsy Ford | Sally Lamkin | Walter L Springer |
| Lyman W Bittman | Muriel Frederick | Lynne P Lande | Katie Stadel |
| Earl T Bondie | Larry E French | Dale R Leslie (d) | Fred E "Bud" Stein |
| Al Bourk | Willard J Frey | Paul Lohr | Mary Stewart |
| Jerry M Brown | Al Gallup | Tom Lovell | Dick Stoll |
| Gene Buatti | Ronald D. Gardner | Elizabeth L Mammel | Doris M Strite |
| Alan Burg | Mario Gasbarro, Jr | Fredrick A Mammel | Jane Talcott |
| Daniel L Burroughs | George J Gilligan | Glenda Maten | Henry A VanderKaay |
| Don Butcher | Eugene A Glysson | Ralph Maten | Hugh Wanty |
| Letitia J Byrd | Marie M Glysson | Ann Mattson | Murray D Wanty |
| Robert I Carr | John Goff | Norma Barbour McCollum | Augusta Washington |
| F Huston Colvin | Robert H Gray | Amber Jean McEwen | Ellen Webb |
| C Merle Crawford | Katherine J Griswold | Donald McEwen | George Wild |
| Harry L Cross | William V Hampton | Gerald F McMahan | Kathie E Wilder |
| Ray Cross | Jerry Hartweg | Joseph C Medrano (d) | Ronald N Williams (d) |
| Marianne E D'Angelo | Mary Anne Hennigar | Gregory P. Meisner | Mark Wishka |
| Michael F Dabbs | Joyce B Herbert | James Morgan (d) | Ronald C Wolf |
| Claire Dahl | Kenneth L Hillenburg | Robert H Nichols | Carol Ziegler |
| John Dahl | Joe Jedele | Charles F North | Max M Ziegler, Jr |
| Alan M Dailey | Bob Johnson | James J O'Kane | Douglas F Ziesemer |
| Carl A Dailey | Deborah A Jones | Jeanette Okuley | |
| John D Devall, Jr | Arthur D Katz | Donald G Olsen | |

GENERAL CHARGES TO CLUB AND FOUNDATION COMMITTEES

Kiwanis Club of Ann Arbor committees are either committees of the Club (C), committees of the Foundation (F), or two separate committees of the Club and of the Foundation, respectively (C&F).

Archive (C&F): Locates, discovers, organizes, and archives the past, present and future records, photos, memorabilia, and stories of our Club and Foundation. Identifies effective means to safeguard and search the archives.

Attendance & Reception (C): Tabulates member attendance and organizes members to greet other members, guests, and visitors as they arrive for noon meetings. Introduces guests and visitors to the attendees.

Budget & Finance (C&F): Two separate committees develop annual budgets and quarterly updates for the Club and Foundation respectively. Each presents these budgets to the appropriate Board.

Building & Equipment (F): Oversees the maintenance, planning, safety, and security of the Kiwanis Center building, equipment, facilities, and vehicles.

Bylaws (C&F): Reviews and recommends changes to the Club and Foundation bylaws. Updates the Club and Foundation Manuals of Administrative Policies and Procedures as appropriate.

Centennial Celebration (C): Prepares for the 100th anniversary celebration of our Club during calendar year 2021. Explores ideas, develops plans, budget, and a schedule of events, and proposes a such for the Board's approval by April 2020.

Children & Youth Services (F): Initiates projects that benefit children and youth from birth to age 18, and grants funds to organizations that serve them. Awards college, music, and summer camperships.

Community Services (F): Oversees the Foundation's Direct Assistance Program, and helps clients and case managers redeem vouchers for Thrift Sale merchandise. Grants funds for a variety of community projects.

Ethics (C&F): Develops a Code of Conduct for all volunteers, members, and those interacting with Kiwanis that includes specific guidelines for behavior and a set of required procedures for addressing occurrences of inappropriate behavior in a timely fashion. Coordinates with Personnel Committee with respect to employees

Fines & Happy Dollars (C): Monitors, organizes, and proposes Fines and Happy Dollars and encourages all members to do so at our noon meetings. Collects and counts Fines and Happy Dollars and reports those totals to the Club Treasurer.

Grant Coordination (F): Oversees and administers the Foundation's grant-application process. Facilitates disbursements of grants.

Greater Years (F): Initiates projects and grants that benefit seniors. Grants funds to agencies that serve the senior community.

Honorary Members Selection (C): Nominates worthy community-minded citizens who exemplify the ideals of Kiwanis to become Honorary Members of the Club. Oversees the annual induction ceremony for Honorary Members and Honored Volunteers.

Hospitality (C&F): Informs membership about births, deaths, illnesses, accidents, and hospitalizations that involve current and past members and volunteers and their families. Sends cards or flowers as appropriate.

Human & Spiritual Values (C&F): Oversees and administers grants that center on spiritual value and human comfort. Oversees the Salvation Army bell-ringing project. Schedules weekly invocation presenters.

Interclubs (C): Encourages our Club's exchange visits to other Kiwanis clubs. Ensures that our Club completes two interclubs each month, including super interclubs.

Investment Oversight (F): Manages the invested reserve funds of the Foundation.

K-Family Leadership Programs (C): Oversees the maintenance and growth of K-Kids, Builders, Key, Circle K, and Aktion Clubs.

GENERAL CHARGES TO CLUB AND FOUNDATION COMMITTEES, *continued*

Kiwanis Environment Education Preserve (KEEP) (F): Develops, oversees, and maintains the environmental preserve at the Kiwanis Center.

Kiwanis of Michigan Foundation (C&F): Informs Club members about the role of KMF in serving children who are patients at the four children's hospitals supported by KMF.

Meals on Wheels (C): In conjunction with the U of M MOW program, delivers meals to the frail, elderly, and disabled Monday through Friday throughout the year.

Member Recognition (C): Provides appropriate recognition to members whose contributions have helped the Club achieve its Kiwanis objectives. Oversees attendance and member-award ceremonies.

Membership Digest (C&F): Prepares and arranges for the publication of the annual Membership Digest.

Membership Growth & Education (C): Develops and implements strategies to recruit, orient, introduce, support, and retain Club members.

Newsletter (C&F): Prepares the weekly (online) Club Newsletter for distribution to Club members, volunteers and friends of Kiwanis.

Nominating (C&F): Nominates officers (except Secretaries) and Directors to stand for annual election. Prepares and counts ballots for the Club's and Foundations annual meeting.

Operations Coordination (F): Provides ongoing coordination among the three (3) current Kiwanis business activities: Sale Management Oversight committee, Building & Equipment committee, and Tenant/Rental activities and needs.

Outreach (C): Promotes membership and volunteerism for our club by bringing community groups to the Kiwanis Center to hear presentations about what Kiwanis is and what we do, and to familiarize them with our thrift sale; conducts other community outreach activities.

Personnel (C&F): Develops, implements, and monitors personnel policies of the Club and Foundation, subject to the approval by the respective Boards.

Programs (C): Secures speakers for noon meetings.

Public Relations & Marketing (C&F): Communicates the mission, vision, activities, and programs of our Club and Foundation to members, volunteers, and the public through on-line and print media. Takes photographs at Club meetings and events for use in the Newsletter, the Membership Digest, and other Club needs. Oversees and coordinates our Thrift Sale, Club, and Foundation web pages.

Risk Management (C&F): Provides periodic reviews (at least annually) of our building, property, and operations; makes recommendations and oversee the implementation of risk management best practices, proper insurance coverage, and security systems; develops, identifies, and reviews the role of the Safety Officer.

Sale Management Oversight (F): Develops policies and implements procedures for managing all aspects of the Thrift Sale.

Scholarship (F): Provides financial scholarships to high school graduates in furtherance of their completion of a college or technical degree.

Social (C&F): Plans and implements periodic social events that foster camaraderie among Club members, volunteers, friends, and families.

Strategic & Long-Range Planning (C&F): Explores goals and the viability of the Club and Foundation for the next 10 years. (Inactive in 2019-20.)

Technology (C&F): Identifies and evaluates, technology needs to support Club and Foundation activities. Develops and makes recommendations for continuous improvement.

2019-2020 COMMITTEE ROSTERS

Kiwanis Club of Ann Arbor committees are either committees of the Club (C), committees of the Foundation (F), or two separate committees of the Club and of the Foundation, respectively (C&F).

| | | | | |
|---|--|---|---|--|
| <p>ARCHIVE (C&F) Hillenburg, Co-Ch Krasnoff, Co-Ch Barden, K Lofstrom Wilder</p> <p>ATTENDANCE & RECEPTION (C) Gray, Co-Ch LeRoy, Co-Ch (A) = Attendance taker (C) = Lunch Cashier</p> <p>October Lofstrom Mattson, A Brown (C) Sanchez (A)</p> <p>November Carr, B J Kinzinger Leslie (C) Dries (A)</p> <p>December Burroughs Duquette Drake (C) Koch (A)</p> <p>January Blomquist Hadwin Evans (C) Winkler (A)</p> <p>February Goodkin Bomar Ziegler (C) Dahl, C (A)</p> <p>March Powers Smit Miller (C) Argyle (A)</p> <p>April Donner Shaw LaMoreaux (C) Kossick (A)</p> <p>May Donner Kotch Duda Kidle (C) Sanchez (A)</p> | <p>June Lofstrom Summers Sampselle (C) Smit (A)</p> <p>July Dailey Keyes French (C) Babcock (A)</p> <p>August Dick LeRoy Miller (C) Ziegler (A)</p> <p>September Duquette Luke Dahl, J (C) Gray (A)</p> <p>BUDGET & FINANCE (C&F) Meisner, Ch (ex officio) Dabbs Dever, D (ex officio) Gilligan (ex officio) Johnson (ex officio) Koch Krasnoff (ex officio) LeRoy (ex officio) Schork Sheldon Smith Wishka</p> <p>BUILDING & EQUIPMENT (F) Dever, N, Co-Ch Gilligan, Co-Ch Schenk, Co-Ch Gray Goodkin Robb, W Sanchez</p> <p>BYLAWS (C&F) Krasnoff, Ch Beeman Dever, N Meisner Wilder</p> <p>CENTENNIAL CELEBRATION (C) Leslie, Ch Barden, K Bomar Brown Burg</p> | <p>Burroughs Carr, R Conlin, R Cross Dever, N Duquette French Gallagher Hampton Hillenburg Hughes Johnson Kidle Koch Mattson, A Mattson, J Panning Phibbs Presley Rabidoux Sheldon Stewart Streich Wilder Williams, J Ziesemer All past presidents</p> <p>CHILDREN & YOUTH SERVICES (F) Burroughs, Co-Ch Carey Dabbs, Co-Ch Babcock Dahl, C Dahl, J Dittmar Evans Hadwin Hiller Kidle Kinzinger Koch Duda LaMoreaux Luke McNab-Cattell Miller Preston Stewart Wilder Williams, J</p> <p>COMMUNITY SERVICES (F) Carr, R, Co-Ch, Grants Webb, Co-Ch, Vouchers Benedek Carey Dailey Evans Goodkin Hughes Lamkin, B Lamkin, S</p> | <p>LaMoreaux Presley Robinson Smith Summers Voucher Helpers Beeman Bomar Brown Burg Carey Carr, B J Carr, R Dahl, C Evans Goodkin Hillenburg Johnson Koch Lamkin, S Lande Lavin Leslie Meisner Miller Presley Preston Roberts Robinson Smith Stewart Summers Ziegler Non Club Members Cooper, Nancy Evans, Mary Rydzok, Deb Smit, Dee Springer, Sally</p> <p>ETHICS (C&F) Lande, Ch Beeman Mattson, A Robinson</p> <p>EXECUTIVE (C&F) Dever, D, Ch (ex officio) Hampton (ex officio) Krasnoff (ex officio) Meisner (ex officio) Wilder (ex officio)</p> <p>FINES & HAPPY DOLLARS (C) Sanchez, Ch Dahl, C Dever, D Dittmar Leslie</p> | <p>GRANT COORDINATION (F) Krasnoff, Ch Dabbs, Asst Ch Burroughs Carr, R Donner French Goodwin Koch Kossick McNab-Cattell Robinson Stewart</p> <p>GREATER YEARS (F) Robinson, Ch Lande Leslie Meretta Presley</p> <p>HONORARY MEMBERS SELECTION (C) Brown, Ch Anglin Hiller Krasnoff Mattson, A Robinson Sheldon</p> <p>HOSPITALITY (C&F) Hampton, Ch Oct – Hampton Nov – Barden, K. Dec – Lande Jan – Leslie Feb – Dahl, J Mar – Hughes Apr – Ziegler May – Talcott Jun – Sanchez Jul – Dahl, C Aug – Presley Sep – Kossick</p> <p>HUMAN & SPIRITUAL VALUES (C&F) Donner, Ch Babcock Brown Dick Evans Hampton Lamkin, B</p> |
|---|--|---|---|--|

2019-2020 COMMITTEE ROSTERS, *continued*

INTERCLUB (C)

Phibbs

INVESTMENT OVERSIGHT (F)

Gilligan, Ch
Dahl, J
French
Kotch Duda
LeRoy
Meretta
Schork
Ziegler

KEEP (F)

Dever, D, Co-Ch
Krasnoff, Co-Ch
Dever, N
Dick
Evans
Gilligan

K-FAMILY LEADERSHIP (C)

Kossick, Ch.
Allshouse
Daily
Goodkin
Sampselle
Schork
Stewart
Wilder

KIWANIS OF MICHIGAN FOUNDATION (C&F)

French, Ch
Carey
Wilder

MEALS ON WHEELS (C)

Anglin, Co-Ch
Winkler, Co-Ch
Argyle
Beeman
Bell
Burroughs
Carey
Dahl, C
Dahl, J
Drake
French
Gallagher
Gallup
Hughes
Johnson
LaMoreaux
Leslie
McNab-Cattell
Robb, W
Schenk

Sheldon

Smit
Ziegler
Non Club Members
Barden, Marti
Bell, Judy
Drake, Marilyn
Gallup, Karen
Herndon, Amy Jo
Herndon, Paul
Huck, James
Johnson, Linda
Sudderdorf, Sandy

MEMBER RECOGNITION (C)

Carr, R, Ch
Benedek
Buhner
Burg
Cross
Dahl, C
French
Gray
Lande
Mattson, A
Schork
Webb
Ziegler

MEMBERSHIP DIGEST (C&F)

Winkler, Ch
Bassett
Gray
Keyes
Wilder

MEMBERSHIP GROWTH & EDUCATION (C)

Lande, Co-Ch
Bomar, Co-Ch
Barden, K
Benedek
Burroughs
Duquette
Gray
Shaw
Stewart
Wilder

NEWSLETTER (C&F)

Rabidoux, Ch
Oct - Rabidoux/Brown
Nov - Leslie
Dec - TBD
Jan - Beeman
Feb - Sheldon
Mar - Lande
Apr - LaMoreaux
May - Kidle
June - Mattson, A
Jul - Rabidoux
Aug - Brown
Sept - Rabidoux

NOMINATING (C&F)

Hampton, Ch
Barden, K
Carr, R
Leslie
Phibbs
Schork
Sheldon
Webb

OPERATIONS COORDINATION (F)

Krasnoff, Ch
Dever, D (ex officio)
Dever, N (ex officio)
Gilligan (ex officio)
Schenk (ex officio)
Schork (ex officio)
Non Club Members
Gasbarro, Mario
Salamin, Tanya

OUTREACH (C)

Barden, K, Ch
Peterson, Sonia, Asst Ch
Allshouse
Bomar
Brown
Burg
Dahl, C
Dever, D
Gray
Hillenburg
Krasnoff
Lande
Leslie
Smith
Webb
Wilder

PERSONNEL (C&F)

Beeman, Ch
Dever, D, (ex officio)
Barden, R
Dabbs
Dahl, J
Mattson, A
Meisner
Sheldon
Stewart
Ziegler

PROGRAMS (C)

LeRoy, Ch
Jones
Leslie

PUBLIC RELATIONS & MARKETING (C&F)

Burg, Co-Ch
Hillenburg, Co-Ch
Allshouse
Argyle
Bomar
Burroughs
Carr, R
Dries
Gray
Koch
LeRoy
Robb, W
Roberts
Sampselle
Wilder
Williams, J

RISK MANAGEMENT (C&F)

Schork, Ch
Beeman (ex officio)
Brown
Burg
Dever, D (ex officio)
Dever, N (ex officio)
French
Gilligan (ex officio)
Goodwin
Gray (ex officio)
Hadwin
Krasnoff (ex officio)
Meisner (ex officio)
Schenk (ex officio)
Stewart
Non Club Members
Gasbarro, Mario (ex officio)
Salamin, Tanya
Schwartz, Mary

SALES MANAGEMENT OVERSIGHT (F)

Dever, D, Ch
Dahl, J
Gilligan
Gray
Stewart
Webb
Zieseemer
Non Club Member
Gasbarro, Mario
Peterson, Sonia

SCHOLARSHIP (F)

Burroughs, Co-Ch
Dries, Co-Ch
Cross
Dahl, C
Schork
Smith
Stewart
Talcott

SOCIAL (C&F)

Stewart, Ch
D'Angelo
Presley
Webb

STRATEGIC & LONG RANGE PLANNING (C&F)

Inactive in 2019-20

TECHNOLOGY (C&F)

Gray, Ch
Bomar
Goodkin
Hillenburg
Kidle
Robb, W
Winkler

MEMBERS' BIRTHDAYS

JANUARY

2 Blomquist
5 Duquette
5 Lavin; Phibbs
8 Barrett
15 Argyle
24 Babcock
27 Dries; Niemann
29 Fomby
31 Luke

FEBRUARY

2 Kossick
3 Williams, M
6 Taylor
8 Krasnoff
9 Reed; Reynolds
12 Koch
16 Webb
18 Cross
23 Sanchez
24 Burroughs

MARCH

1 Dahl, J
3 Beeman; Kotch Duda
12 LaMoreaux
15 Hughes
17 Kinney
18 Robb, M
21 Mehraban; Petroski
22 Rabidoux
23 Conlin, R
25 Smith
26 Snider
29 Gupta

APRIL

1 Lamkin, B
4 Hillenburg
5 Bassett
6 Dailey; Gilligan
6 Robinson; Schork
10 Carey
23 Jones
24 Powers

MAY

14 Ziesemer
15 Mattson, A
16 Grachek
17 French
18 Gardner
19 Bell
20 Fegan
22 Dittmar
23 Linden
24 Lofstrom
27 Brokaw
28 Wolfington

JUNE

2 Kavanagh; Rupp
6 Soyars
15 Tse
17 Salemi
25 Gallup
26 McMahon
29 Bomar; Stewart

JULY

4 Brown
7 Roberts
8 Barden, K
8 Talcott
10 Hampton
11 Harper; Williams, J
13 Goss
16 Preston
17 Summers
21 Kinzinger
23 Anglin
24 LeRoy

AUGUST

2 Streich
5 Hadwin
7 Ackerman
9 Meisner
11 Hendricks
25 Dukes
26 Supica
28 Burg; Okuley

SEPTEMBER

4 Conlin, E
6 Dever, D
10 Buhner
11 Shaw
12 Ziegler
13 Schmerberg
14 Gray
15 Barhydt; Lamkin, S
15 Panning; Smit
17 Wishka
23 Dick
24 Sheldon
25 Drake
26 Leslie

OCTOBER

1 Robb, W
4 Greene
5 Heller
11 Carr, B J
13 Carr, R; Kidle
15 Dabbs
16 Allshouse
17 Elling; Evans
22 Hanton
23 Schechtman
26 Lopatin
28 Wilder

NOVEMBER

7 McNab-Cattell; Miller
12 Presley
14 Barden, R
16 Schenk
17 Dahl, C; Mattson, J
17 Sampselle
21 Goodkin; Lande
25 Dever, N

DECEMBER

10 Hawkins; Hiller
13 Johnson
14 Gallagher
15 Keyes
20 Benedek
22 Donner
24 Winkler
27 D'Angelo
30 Meretta

MEMBERSHIP BY PROFESSION

ACCOUNTANT

Blomquist
Hendricks
Lavin

ACTUARY

Smith

ADMINISTRATOR / DIRECTOR / MGR SUPERVISOR

Bomar
Dabbs
Dahl, J
Dailey
Dries
Goss
Gupta
Hadwin
Hampton
Keyes
LaMoreaux
Leslie
Mattson, J
Okuley
Robb, W
Salemi
Sampsel
Sanchez
Schechtman
Soyars
Stewart
Streich
Talcott
Wilder

APPRAISER / REALTOR

Carey
Schmerberg
Ziegler

ATTORNEY / PARALEGAL

Beeman
Benedek
Dever, D
Dever, N
Dick
Gallagher
Gardner
Goodkin
Heller
Krasnoff
Rabidoux
Reed

CIVIL SERVANT

Snyder (Meteorologist)

CONSULTANT

Ackerman
Conlin, R
Cross
Fegan

DENTIST / ORTHODONTIST

Hillenburg
Lofstrom
Niemann

DESIGNER

Donner (Toys and games)

EDUCATOR

Anglin
Barhydt
Barrett
Bassett
Burg
Burroughs
Dahl, C
Dittmar
Dukes
Evans
Gallup
Grachek
Gray
Kinney
Kossick
Lamkin, B
Lamkin, S
Lopatin
McNab-Cattell
Petroski
Reynolds
Williams, M

ENGINEER

Babcock
Carr, R
Elling
Greene
Hughes
Kinzinger
Luke
Meisner
Schenk
Smit
Supica

EXECUTIVE / BUSINESS OWNER

Barden, K
Barden, R
Brown
Hawkins
Kavanagh
Linden
Miller
Powers
Presley
Preston
Robb, M
Roberts
Webb
Williams, J

FINANCIAL PLANNER / BANKER

Brokaw
Drake
Hanton
Jones
Kidle
LeRoy
Mehraban
Meretta
Panning
Koch
Schork
Sheldon
Wolffington

HISTORIC

PRESERVATIONIST
Duquette

HUMAN RESOURCES

Allshouse

INVESTMENT ADVISOR

French
Gilligan
Kotch Duda
Wishka
Ziesemer

JUDGE / JUDICIAL

Hiller
Mattson, A

NURSE

Buhrer
Summers

OFFICE ASSIST

Carr, B J

PASTOR / RELIGION

Bell

PSYCHOLOGIST / THERAPIST

D'Angelo
Lande

RESEARCH SCIENTIST

Argyle
Fomby
Johnson
Rupp
Tse
Winkler

RETAILER /

WHOLESALER

Conlin, E
Phibbs
Taylor

SERVICE PROVIDER

McMahon (Painter)
Shaw (Computer Prog)

SOCIAL WORKER

Robinson

VETERINARIAN

Harper

ADVERTISER INDEX

| | | | |
|-------------------------------|---------------------------|----------------------------|-------------|
| Attorney | 10 | Investment Service | 9,10,15, 30 |
| Banking | 11, 17, inside back cover | Marketing | 11 |
| Child Care | 19 | Museum | 18 |
| Debt Recovery | 9 | Realtor | 11, 12 |
| Educational Institution | back cover | Recreation | 7 |
| Flowers & Gifts | 17 | Restaurants | 3 |
| Food & Beverages | 4, 29 | Service Organization | 1, 5, 36 |
| Foster Youth Services | 14 | Service, Painting | 19 |
| Funeral Home | 29 | Therapist | 17 |
| Gardening Supplies | 18 | Travel | 15 |
| Insurance | 14 | Veterinarian | 14 |

*The Kiwanis Club
of Ann Arbor
looks forward to our
Centennial
Celebration*

2021 A CENTURY OF SERVICE



KIWANIS CLUB OF ANN ARBOR

TRADITIONAL CLUB ACTIVITIES

DECEMBER 2019

2-Day Christmas Sale
Salvation Army Bell Ringing
Club Christmas Party

JANUARY 2020

Detroit #1 Birthday Party
Detroit, MI

APRIL 4, 2020

Spring Divisional

MAY 2020

Club Annual Meeting & Elections
Perfect Attendance Awards

JUNE 18-21, 2020

International Convention
Indianapolis, Indiana, USA

AUGUST 2020

Club Family Picnic

AUGUST 20-23, 2020

District Convention
Flint, Michigan

SEPTEMBER 2020

Installation of Officers & Directors
Legion of Honor Awards

bank^{of} ann arbor



How can we help you?
734.662.1600 boaa.com

 Member FDIC



WCC Foundation thanks the Kiwanis
Club of Ann Arbor for supporting
the Kiwanis-WCC Scholarship.

WCCNET.EDU/FOUNDATION

WCC *Foundation*

4800 E. Huron River Drive, Suite 304
Ann Arbor, MI 48105-4800

734-973-3665