

2018-2019 Membership Digest



Kiwaniis[®]

CLUB OF ANN ARBOR

*Celebrating 98 Years of Community Service
and Camaraderie*

**MAKE A DIFFERENCE IN THE LIVES
OF CHILDREN IN THIS COMMUNITY**



www.a2kiwanis.org

Kiwanis Club of Ann Arbor 2018-2019

OFFICERS

President William V. Hampton
 Vice President Dana A. Dever
 Immed. Past Pres Alan J. Burg
 Treasurer Gregory P. Meisner
 Asst. Treasurer, Club Larry E. French
 Asst. Treasurer, Sales Robert M. Johnson
 Secretary Kathie E. Wilder
 623 Susan Drive, Ann Arbor, MI 48103
 Cell phone: 734-660-5135
 E-mail: kwildera2@gmail.com
 Asst. Secretary Robert H. Gray
 Cell phone: 734-604-4977

DIRECTORS

Peter F. Schork Sept. 30, 2019
 Ellen F. Webb Sept. 30, 2019
 Marianne E. D'Angelo Sept. 30, 2020
 Margaret J. Krasnoff Sept. 30, 2020
 Gordan L. Beeman Sept. 30, 2021
 Mary Stewart Sept. 30, 2021

Kiwanis Center

100 North Staebler Road, Suite C
 Ann Arbor, MI 48103-9755

Administration Phone: 734-368-9738

Answering Service for Pickups: 734-665-0450

Website: www.a2kiwanis.org

MEETING TIMES OF NEARBY KIWANIS CLUBS

Monday

- * Kiwanis Club of Ann Arbor - Kiwanis Center, 100 North Staebler Road 12:10 PM
- * Chelsea - Chelsea Hospital, Main Dining Room, 775 S Main 6:15 PM
- * Howell - Block Brewing Company, 1140 S Michigan Ave, Howell, 1st & 3rd Mon. 5:30 PM
- * Saline - Brecon Village, 200 Brecon Dr, 1st & 3rd Mon 5:45 PM
- * South Lyon - 228 N Warren St, South Lyon, 2nd and 4th Mon 6:30 PM

Tuesday

- * Ann Arbor Western - Quarter Bistro, 300 S. Maple Rd. 12:10 PM
- * Belleville Area - Kabob Garden, 277 E Columbia Ave, 2nd & 4th Tues 6:00 PM
- * Hamburg - Hamburg Coney Restaurant, 9580 Chilson Commons, Pinckney 7:30 AM
- * Plymouth - Zack's of Plymouth, 9468 Main St, Plymouth, 1st & 3rd Tues. 6:30 PM

Wednesday

- * Manchester - Kingsley-Jenter (K-J) House, 302 E Main St, 4th Wed. 6:00 PM
- * Ypsilanti - EMU Student Center Building, 900 Oakwood St., Ypsilanti Noon

Thursday

- * Brighton - Homewood Suites, 8060 Challis Rd, 1st & 3rd Thurs. (1st) 7:15 AM; (3rd) 6:30 PM
- * Colonial Plymouth - The Courthouse Grille, 41661 Plymouth Rd Noon
- * Whitmore Lake - Whitmore Lake Community Center, 9101 Main St., 1st & 3rd Thurs. 7:00 PM

The Objects of Kiwanis International and Our Club Are:

- TO GIVE PRIMACY to the human and spiritual rather than to the material values of life.
- TO ENCOURAGE the daily living of the Golden Rule in all human relationships.
- TO PROMOTE the adoption and the application of high social, business, and professional standards.
- TO DEVELOP, by precept and example, a more intelligent, aggressive, and serviceable citizenship.
- TO PROVIDE, through Kiwanis clubs, a practical means to form enduring friendships, to render altruistic service, and to build better communities.
- TO COOPERATE in creating and maintaining that sound public opinion and high idealism which makes possible the increase of righteousness, justice, patriotism, and good will.

DIVISION 6 AND OTHER NEARBY SUPER INTERCLUBS, 2018-2019

October 23.....Ann Arbor Western	April 15Chelsea
November TBD	May TBD
December 3 Ann Arbor	June TBD
January TBD	July TBD
February 4 HOWELL	August 22-25 District Convention
March TBD	September TBD



WARM THE CHILDREN

Providing New Winter Clothing for Local Children in Need

In July, 2017, the Kiwanis Club of Ann Arbor became the new sponsor of the Warm the Children program. For 22 years in Washtenaw County, the Warm the Children program has helped to provide new warm winter clothing for children in need. Without your help, many of these children would have to face our cold Michigan winter without coats, hats, boots or mittens. A little of your time or just a few dollars will go a long way!

**YOU CAN MAKE A DIFFERENCE IN THE LIVES OF CHILDREN.
FOR VOLUNTEER OR DONATION OPPORTUNITIES, PLEASE VISIT:
A2Kiwanis.org/WarmTheChildren**

BE A SHOPPER: See the eyes of the children light up!!

BE A DONOR:

In person: At any Old National Bank branch
in Washtenaw County

By mail: Warm the Children c/o Old National Bank
2723 S State Street
Ann Arbor MI 48104

CLUB HISTORY OF COMMUNITY SERVICE

The Kiwanis Club of Ann Arbor was organized on May 13, 1921, and chartered on June 13, 1921, with 60 charter members. As of September 30, 2018, the club was the largest Kiwanis club in Michigan, with 133 members (including emerita and emeritus members). Since its founding, the club had inducted 1261 members.

In 1922 the club began working with the University of Michigan Hospital to provide recreation and education for young patients. In 1934 this activity was adopted as a Michigan District project and named for Forney W. Clement, a former District Secretary and member of our club. Subsequently, the project was extended to Mary Free Bed Hospital in Grand Rapids (1961), Northern Michigan Hospitals, Inc. in Petoskey (1977), and Children's Hospital of Michigan in Detroit (1980s). Our club members make an annual gift to the Michigan District to support the Clement project at these four hospitals, and also contribute monthly to the Mott Pot to provide additional support to for the Clement project at the U of M Mott Children's Hospital.

In 2017, by vote of our Board and club members, our club became the sponsoring agency for Ann Arbor Warm The Children program, with an annual commitment of \$2500.

Proceeds from rummage sales and other fund-raising efforts have enabled the club to fund the activities of many charitable organizations. Most club donations range between \$500 and \$4000. The club has made a few major gifts of \$5000 to \$25,000 to several community organizations to help support their activities.

- * Capital campaigns
 - * AA YMCA
 - * American Red Cross
 - * Arbor Hospice
- * Special Projects
 - * AA Fire Department's "Smoke House"
 - * AA Hands On Museum
 - * AA Library Bookmobile
 - * Dawn Farm (new van)
 - * Help Source
- * Salvation Army
- * Washtenaw Intermediate School District (Green House Project)
- * Hope Dental Clinic
- * "Neutral Zone" for teens
- * Peace Neighborhood Center
- * Washtenaw Area Council for Children
- * Family Learning Institute Bookmobile

In addition to raising money to help charitable organizations, club members have participated in many local hands-on activities. Examples include:

- * greenhouse project at High Point
- * "Christmas-in-April"
- * donating blood
- * dictionaries for 4th-graders
- * "Bring Geography to School"
- * "Kids Against Hunger"
- * serving as Warm The Children "shoppers"
- * "Terrific Kids" at Mitchell School
- * "Meals on Wheels"
- * valentines for Mott Children's Hospital
- * Special Day's Children's Cancer Camp
- * Fourth of July parade in downtown AA
- * hosting parties at Mott Children's Hospital for Christmas and special occasions

The club has also participated in projects that benefit people outside the local area: Examples include:

- * donated funds and goods to help victims of earthquakes, floods, hurricanes, and tsunamis
- * collected and mailed boxes of clothing to Poland, Dominican Republic, and Nigeria
- * collected and sent boxes of prescription eyeglasses to Third World countries
- * donated \$104,000 to the worldwide Iodine Deficiency Disorder project sponsored by KI
- * donated \$103,185 in 2015 to the Kiwanis/unicef worldwide ELIMINATE project to eliminate maternal and neonatal tetanus.

CLUB MEMBERSHIP

Those who join our club are invited to join by current members. The weekly Monday-night meetings are an excellent forum for prospective members to meet club members. The club covers the cost of two meals for each prospective member.

Members who wish to sponsor prospective members ask them to fill out and sign a Membership Application form. Sponsors sign the form and return it to the Secretary. The Secretary arranges for information about the applicant to be published in two consecutive issues of the Club Newsletter, and forwards the completed application to the facilitator of the Past Presidents, who arranges for the applicant to be interviewed by a Past President.

After an interviewer recommends acceptance of the application, the Secretary submits the application to the Board of Directors for approval. After the Board's approval, the Secretary notifies the applicant and requests payment of dues. Upon payment of dues, the Secretary places a new-member badge in the badge rack, and the President schedules a formal induction ceremony, with the applicant and sponsor present.

Annual club dues for 2018-2019 are \$180. Sponsors mentor new members to help them complete several tasks required to earn a regular-member badge. New members qualify for the regular-member badge once they:

- have been oriented about the club
- have their picture taken by the club photographer
- work on a sale activity
- join a committee
- give a 3-minute speech about themselves
- actively work on a club committee
- participate in two additional club activities, such as:
 - * greet guests and members at a noon meeting
 - * attend a Board meeting
 - * attend an interclub
- participate in at least one Kiwanis-sponsored community activity, such as:
 - * Warm The Children program
 - * Salvation Army bell ringing
 - * Meals on Wheels delivery



Stay healthy,
live well!

- PERSONAL TRAINING
- CLASSES
- CORPORATE HEALTH
- STUDIO MEMBERSHIPS

905 W Eisenhower PKWY., Suite 108
Adjacent to the Colonade
734.222.5080

a2fitnesspros
TRAINING STUDIO

a2fitnesspro.com



How To Maintain Perfect Attendance

A member who chooses to maintain perfect attendance can do so by attending all regularly scheduled club meetings or by making up missed meetings. One member participation credit may be earned for personal attendance at the following meetings or activities during the calendar month or 7 days immediately preceding or following the month that a club meeting is missed:

- a regular, round-table, Board, or special meeting of any other Kiwanis-family club
- a regular (not a special) meeting of our club's Board of Directors
- a regular, scheduled meeting of one of our club's formal committees
- a service project of our club or of a Kiwanis-family organization sponsored by our club (maximum of 1 credit/day/project)
- an international, district, or division Board meeting, convention, conference, or scheduled meeting (maximum of 1 credit per event)
- a club function held to improve the health, welfare, morale, or esprit de corps of club members (maximum of 1 credit/month)
- absence from a regular club meeting as a result of travel to or from an international or district convention or conference (travel must be within 7 days before or after the event)
- a visit to the international office, a regional service center, or a district office (maximum of 1 credit/quarter)
- one credit is given for each regular meeting missed as a result of performing jury duty



Fresh Donuts
Baked Daily
662-3244
602 S. ASHLEY ST.
ANN ARBOR, MI 48103

IN MEMORIAM



R. Letitia J. Byrd



E. Ann Frey



Todd B. Jones



Lloyd E. Kitchens



Sheridan W. Springer



James L. Wheaton

2018-2019

HONORARY MEMBERS

Jim Balmer
Greg Bazick
Margaret Leary
Dr. Jeanice Swift
David Szczygiel

HONORED VOLUNTEERS

Carol Bagchi
Janet Clear
Susan Cramer
Prudy Dittmar
Mary Hill
Fred Schuman
Rhonda Schuman
Gloria Stephens

Members with 10 or more years of
PERFECT ATTENDANCE
 through September 30, 2018

55 Dick Benedek	29 Lynne Lande	18 Rip Kinney	13 Don Kossick
51 Max Ziegler	27 Jerry Brown	17 Sally Lamkin	12 Max Supica
48 Bob Barden, Sr.	27 George Gilligan	16 Bob Barden, Jr.	12 Mark Wishka
46 Joe Medrano	27 Rick Hendricks	16 Dave Bell	11 Bob Gray
44 Nick Dever	26 Harry Cross	16 Wally Niemann	11 Bob Greene
43 Cliff Sheldon	26 Mike Dabbs	15 Burt Lamkin	11 Dave Hughes
39 Dale Leslie	25 Peter Schork	14 Dave Drake	11 John Kidle
38 Fred Sanchez	24 Pat Buhner	14 Gary Elling	10 Ron Gardner
38 Doug Ziesemer	23 Larry French	14 Al Gallup	10 Bob Johnson
36 Clar Dukes	23 Doug Hanton	14 Bill Robb	10 Ann Mattson
35 Bob Carr	22 John Bassett	14 Ellen Webb	
35 Jim Meretta	22 Gordon Beeman	13 Dan Burroughs	
32 Paul Klinger	22 Dan Dever	13 John Dahl	
30 Kathy Barden-Perlberg	22 Garry Donner	13 Sharon Keyes	

FIRST- AND SECOND-GENERATION CLUB MEMBERS

Current members whose parent was, or currently is, a member of our club include:

Kathleen Barden-Perlberg and Robert J Barden, Jr, daughter and son of Robert J Barden, Sr
 Harry L Cross, son of Ray E Cross
 C Nicholas Dever and Dana A Dever, sons of Charles H Dever
 David J Drake, son of Don D Drake
 Paul D Klinger, son of Robert B Klinger
 Lynne P Lande, daughter of Nicholas J Prakken
 Michele D Robb, daughter of William C Robb
 Nicolette R Williams, daughter of Julanne C Williams
 Douglas F Ziesemer, son of Fred C Ziesemer

**Do what you love.
For others.**



United Way
of Washtenaw County

VOLUNTEERS

Find the perfect opportunity to give back to your community at...

NON PROFIT AGENCIES

Post your needs and reach potential volunteers at...

EMPLOYERS

Put your team to work doing community service at...

VolunteerWashtenaw.org

PAST PRESIDENTS

1921-21	Fred J Heusel*	1953-54	Mac E Watterworth*	1986-87	Clifford G Sheldon (DP)
1921-22	Robert Norris*	1954-55	Herbert E Welhenes*	1987-88	Fulton B Eaglin (DP)
1922-23	Walter R Drury*	1955-56	Emerson F Powrie*	1988-89	Douglas F Ziesemer (DP)
1923-24	Harry W Nichols*	1956-57	W Charles Gregory*	1989-90	Michael F Dabbs (DP)
1924-25	John E Swisher*	1957-58	Loren W Campbell*	1990-91	Lyman W Bittman (DP)*
1925-26	Lewis D Reiman (LG,G)*	1958-59	Gene D Maybee*	1991-92	Lloyd E Kitchens (MP,LG)*
1926-27	Jay G Pray*	1959-60	Fred J Schmid*	1992-93	Eugene A Glysson*
1927-28	Arthur E Crippen (LG)*	1960-61	F Huston Colvin*	1993-94	Kathy Barden-Perlberg (DP)
1928-29	Clifford C Glover*	1961-62	Walter E Kneer*	1994-95	Gary R Elling (MP)
1929-30	Floyd A Sergeant*	1962-63	Fred E Stein*	1995-96	Leland D Bachman (DP)*
1930-31	Leonard P Fisher*	1963-64	Frederich E Oliver*	1996-97	David T Bell
1931-32	Lynn W Fry*	1964-65	Robert A Reiff*	1997-98	Ronald N Williams*
1932-33	Charles A Fisher*	1965-66	Dean W Bolgos*	1998-99	Lynne P Lande
1933-34	Howard L Spedding (ST,LG)*	1966-67	Sheridan W Springer (LG)*	1999-2000	Peter F Schork
1934-35	Frank S Hait*	1967-68	Charles H Dever*	2000-01	Harry L Cross
1935-36	Walter W Springer*	1968-69	Fred C Ziesemer*	2001-02	Larry E French
1936-37	Warren F Cook*	1969-70	Donald A Duncanson*	2002-03	Gordon Beeman (DP)
1937-38	Ashley H Clague (LG)*	1970-71	Robert J Barden, Sr	2003-04	Robert I Carr (DP)
1938-39	George Meader*	1971-72	Lyle O Paige*	2004-05	George J Gilligan
1939-40	Harold J Barnum*	1972-73	Fredrick A Mammel (DP,LG)*	2005-06	Alan Dailey (DP)*
1930-41	Russell MacKenzie*	1973-74	Clyde W Johnson (DP)*	2006-07	J Thomas Lovell (DP)*
1941-42	Nichols J Prakken*	1974-75	Donald G Olsen (DP,LG)*	2007-08	Robert J Barden, Jr (DP)
1942-43	Louis H Hollway*	1975-76	C Merle Crawford (DP)*	2008-09	Lynne P Lande (DP)
1943-44	W Horace Campbell*	1976-77	J Lee Blaylock*	2009-10	Ann E Mattson (DP)
1944-45	James J O'Kane (LG)*	1977-78	J Michael Forsythe	2010-11	Ronald D Gardner (DP)
1945-46	Wendell J LaCoe*	1978-79	Jack W Elliott*	2011-12	Federico I Sanchez (DP)
1946-47	Viggo O Nelson (LG)*	1979-80	Richard O Brunvand	2012-13	Mark S Wishka (DP)
1947-48	Raymond F Hutzel*	1980-81	Clarence E Dukes (DP,LG)	2013-14	John E Dahl (DP)
1948-49	George E Bowder (LG,G)*	1981-82	Robert H Nichols (DP,LG)*	2014-15	John B Goff (DP)
1949-50	Albert L Stickney*	1982-83	Jerry M Brown (DP)	2015-16	Elizabeth Ford (DP)
1950-51	Waldo W Buss*	1983-84	Edward F Conlin	2016-17	Alan J. Burg (DP)
1951-52	George F Smalley*	1984-85	Dale R Leslie (DP,DLG)	2017-18	Gretchen Preston
1952-53	Murray D Wanty*	1985-86	Raymond J Smit (MP)	2017-18	William V Hampton

* Deceased

(MP) Merit President (1986-1998)

(DP) Distinguished President (since 1972)

(ST) State Trustee

(G) Governor

(LG) Lt Governor

(DLG) Distinguished Lt. Governor (since 1972)

PAST PRESIDENTS OF OTHER KIWANIS CLUBS

Patricia M Buhner.....Ann Arbor Eastern
 Alan J Burg.....Tecumseh
 David J Drake.....Shorewood St. Clair Shores
and Southfield
 Douglas O Hanton.....Saginaw Northwest

Joseph C Medrano.....Dexter
 Charles Phibbs.....Ann Arbor Western
 Kurt R Schmerberg.....Saline
 C Robert Snider.....Ann Arbor Eastern
 Julianne C Williams.....Dexter

HALL OF HONOR

In 1985 the Board of Directors established the club's Hall of Honor to honor members, past and present, who have assumed leadership roles in our club and/or have exemplified the Objectives of Kiwanis through their dedication to our club and its benevolent activities. This honor is the most prestigious tribute that our club can bestow. Nominees must also have been a Kiwanian for at least 20 years (with at least 10 years in our club) and have attended at least 80 percent of club meetings while a member of our club.

Members of the Hall of Honor and their years of induction are:

Leland D Bachman	2006	C Nicholas Dever	2014	Gene D Maybee	1988
Robert J Barden, Sr	1997	Dana A Dever	2009	Raymond C McCalla	1997
Robert J Barden, Jr	2014	Clarence E Dukes	2006	James Morgan	1986
K Barden-Perlberg	2007	Donald Duncanson	1990	Robert H Nichols	1996
John R Bassett	2014	Larry E French	2014	Charles F North	2012
Gordon Beeman	2017	Willard J Frey	2012	James L O'Kane	1985
Richard S Benedek	2017	George J Gilligan	2017	Donald G Olsen	1992
Lyman W Bittman, Jr	1996	Eugene A Glysson	2003	Nicholas J Prakken	1985
Jerry M Brown	2017	W Charles Gregory	1986	Robert A Reiff	1999
Robert I Carr	2017	Fred J Heusel	1986	Peter F Schork	2009
Ashley H Clague	1985	L Joseph Jedele	2003	Clifford G Sheldon	1999
Fourney W Clement	2012	Ralph C Keyes	1990	Sheridan W Springer	1986
F Huston Colvin	1986	Lloyd E Kitchens	2003	Fred E Stein	1985
C Merle Crawford	1997	Lynne P Lande	2007	Mac E Watterworth	1996
Harry L Cross	2014	Dale R Leslie	1999	Ronald N Williams	1999
Ray E Cross	2012	J Thomas Lovell	2009	Ronald C Wolf	1988
Michael F Dabbs	2006	Fredrick A Mammel	1999	Max M Ziegler, Jr	2003
Alan M Dailey	2014	Ann E Mattson	2017	Douglas F Ziesemer	2006



 FOR YOUTH DEVELOPMENT
 FOR HEALTHY LIVING
 FOR SOCIAL RESPONSIBILITY

A PLACE FOR ALL

When you join the Y, you're committing to more than simply becoming healthier. You are supporting the values and programs that strengthen your community. At the Y, children learn what they can achieve, families spend quality time together and we all build relationships that deepen our sense of belonging. *Financial assistance available.*

www.annarborymca.org · 400 West Washington Street · 734.996.9622



The Kiwanis Center

The evolution of the Kiwanis Center from its original downtown location on the southwest corner of First and Washington Streets to the new Kiwanis Center at 100 North Staebler Road is a tribute to the foresight and dedication to community service by the members and volunteers of the Kiwanis Club of Ann Arbor.

On April 11, 1966, the club voted unanimously to purchase the distinct beige, brick warehouse and flour mill at 200 S. First St., which once housed the Swisher Wholesale Grocery Store and then the Sears Roebuck & Co. Farm Store. The purchase was made possible through the generosity of John E. Swisher, Jr., whose father was a past president of the club (1925), and through contributions from club members and people in the local community. The club named the building the Kiwanis Activities Center (KAC). In 2015, following the purchase of an additional facility (Kiwanis Center West), the KAC was renamed the Kiwanis Center Downtown (KCD). The new KCW opened on June 13, 2015, for Saturday sales. Later that year sales were expanded to include Fridays and Saturdays from 9 am to 1 pm. In September 2016, the club membership voted to authorize the Board of Directors to consider proposals for the sale of KCD. In 2017, the club accepted an offer to sell KCD, with the closing scheduled for January of 2018. All club activities were relocated to KCW by December 31, 2017, at which time KCW was renamed The Kiwanis Center.



The Kiwanis Activity Center — 1966-2017

The Kiwanis Center at 100 North Staebler Rd is a 123,000 sq-ft office and warehouse building on a 17.4-acre lot. Approximately 71,000 square feet of the building is dedicated to Kiwanis purposes, including the Kiwanis Thrift Sale; Kiwanis offices and meeting rooms; intake, sorting, and warehousing of donated sale items; plus maintenance and utilities. The remaining 52,000 square feet is warehouse and office space rented to other

users. Seven and one-half acres of undeveloped wet lands and woods on the property have been designated as the Ann Arbor Kiwanis Environmental Education Preserve (A2KEEP). That project is under development and will include ponds, woodland, and marsh areas interwoven by paths and planned display projects. Another 2.5-acre portion of the property fronting on Jackson Road is being offered for sale as a commercial out lot.

Having our Kiwanis Thrift Sale operating again out of one location has allowed for a better shopping experience for our customers and for much improved efficiency in the receiving, sorting, and presenting of merchandise by our club members, volunteers, and staff.

Kiwanis Center Floor Space

	<u>Square feet</u>
Kiwanis activities	
Offices and meeting rooms	5,000
The Thrift Sale	30,000
Intake, sorting, testing	9,000
Warehousing, dock	18,000
Maintenance, utilities	9,000
	71,000
Rental areas:	
Offices	7000
Warehouse	45,000
	52,000



*A Positive Approach
to Debt Recovery*



arborps.com

Carol Molton

Client Services Representative

carolm@arborps.com

PHONE: 800.710.4821

FAX: 734.663.5794

Arbor Professional Solutions

2090 S. MAIN STREET
ANN ARBOR, MI 48103

Helping to grow and protect your wealth.

Trusted financial advisors to the university and Ann Arbor community for more than 25 years. We can manage TIAA and Fidelity accounts of university employees and retirees without transferring assets.

734-769-7727 | risadvisory.com



Retirement Income Solutions

Helping to grow and preserve your wealth

© 2017 Retirement Income Solutions is an Independent Investment Advisory firm, not affiliated with TIAA, Fidelity, or the university.

KIWANIS INTERNATIONAL

3636 Woodview Trace, Indianapolis, IN 48268-3196
Tel: 1-800-KIWANIS (1-800-549-2647): Fax: 1-317-879-0204

Charter Club: The Kiwanis Club of Detroit #1 received its charter on January 21, 1915, the date regarded as the birth date of Kiwanis.

International President: Florencio C. "Poly" Lat, Pasay City, Metro Manila, Philippines

Organization: Districts are organized into Divisions. The chief executive officers of a District and a Division are the Governor and Lt. Governor, respectively. The Kiwanis Club of Ann Arbor is in Division 6 of the Michigan District (K12).

The Kiwanis International Foundation is a not-for-profit, tax-exempt corporation that supports national and international programs outside the Kiwanis International budget.

MICHIGAN DISTRICT OF KIWANIS

315 Kiwanis Drive, P.O. Box 231, Mason, MI 48854
Tel: 1-517-676-3837, Toll-free: 1-877-645-4926; Fax: 1-517-676-6600

Governor Larry Memmer
Phone: 517 926-6226 Email: governor@mikiwanis.org

Exec Dir Greg Smith
Mobile: 586-530-5174 E-mail: districtoffice@mikiwanis.org

Lt Gov Jacqueline Otto
Div 6 Mobile: 734-368-2251 Email: jackiotto@yahoo.com

RONALD D. GARDNER
ATTORNEY AT LAW
SPECIALIZING — WILLS & TRUSTS
1601 BRIARWOOD CIRCLE, SUITE 200
TEL: 734-669-0424



KURT R. SCHMERBERG
VICE PRESIDENT
STATE CERTIFIED GENERAL APPRAISER

AFFINITY VALUATION GROUP, LLC
1310 S. Main St. #7, Ann Arbor, MI 48104
TOLL FREE: 800 305-8832 FAX: 800 354-9868
DIRECT: 734 747-7080 LOCAL FAX: 734 929-1260
Email: Kurt@affinityvaluation.com

Ellen's Quilt Creations
email: ellen@ellensquiltcreations.com

(734) 927-4008

650 Cherry Grove Rd
Canton, MI 48188

web-site: www.ellensquiltcreations.com
ebay store: Ellen's Quilt Creations

MEMBERS



Ackerman, Zach



Allshouse, Emily



Anglin, Mike



Argyle, Ray



Babcock, Bryce



Barden, Jr., Bob



Barden, Sr., Bob



Barden-Perlberg, Kathy



Barhydt, Rose Marie



Barrett, Mike



Bassett, John



Beeman, Gordon



Bell, Dave



Benedek, Dick



Blomquist, Jim

Doug F. Ziesemer, CPA
Commercial & Residential Sales

RE/MAX
Commercial Brokers
Each Office Independently Owned and Operated

325 W. Eisenhower, Ann Arbor, MI 48103
Direct 734.769.8111 Mobile 734.395.2092
Office 734.741.1000 Fax 734.623.8455
dfziesemer@aol.com
www.remaxcommercial.com



Kiwanis Foundation Lapel Pins
50 years of helping Clubs and Companies
Succeed with custom imprinting. Give-a Ways.
Pens, mugs, vinyl, emblems, magnets and
catalogs available.
West Hawk Industries
761-3100 Fax 761-8430



Emily Allshouse
Account Executive

Kemner Iott Benz
Insurance/Financial Services

Office: 734.971.1000
Direct: 734.929.3877
Cell: 734.652.4289

We Know Insurance. You Know Us. Let's Talk.

Adrian • Ann Arbor
Cassopolis • Howell

eallshouse@kemneriottbenz.com
www.kemneriottbenz.com

MEMBERS



Bomar, Francine



Brokaw, Ted



Brown, Jerry



Buhrer, Pat



Bulkley, Jon



Burg, Alan



Burroughs, Dan



Carey, Jim



Carr, Bob



Conlin, Bob



Conlin, Ed



Cross, Harry



Dabbs, Mike



Dahl, Claire



Dahl, John

A Realtor and A Kiwanian

I've been a proud member of Kiwanis for 16 years and a Realtor® for 18 years. During that time, I've had the pleasure of working with several members including the Kossick's, the Barden family and Jerry McMahon for their real estate needs.

Specializing in all facets of real estate, I can help you with your first home or your last. From new beginnings to retirement, I can put your mind at ease and guide you through the home buying and selling process.

Call me any time — I'm here to Help!

734-717-5591

EWINGPROS



Jim Carey Realtor®

JCAREY@REINHARTREALTORS.COM

WWW.JAMESMCAREY.COM

500 E. Eisenhower Parkway, Suite 200

Ann Arbor, MI 48108

Reinhart
Charles Reinhart Company Realtors

MEMBERS



Dailey, Sue



D'Angelo, Marianne



Dever, Dan



Dever, Nick



Dick, Griff



Dittmar, Larry



Donner, Garry



Drake, Dave



Dries, Jim



Dukes, Clary



Elling, Gary



Evans, Garry



Fegan, Tom



Fomby, Paula



French, Larry

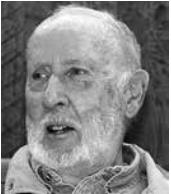

Gallup, Al



Gardner, Ron



Gilligan, George



Goodkin, Mitch



Grachek, Caroline



Gray, Bob



Greene, Bob



Hadwin, Karen



Hampton, William



Hanton, Doug



Harper, Betty Jean



Hawkins, Harry



Heller, Bill



Hendricks, Rick



Hillenburg, Ken

MEMBERS



Hiller, Steve



Hughes, Dave



Johnson, Bob



Jones, Deb



Kavanagh, Gary K



Keyes, Sharon



Kidle, John



Kinney, Rip



Klinger, Paul

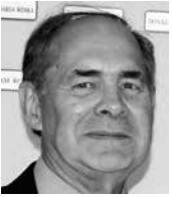

Kossick, Don



Kotch-Duda, Andrea



Krasnoff, Margaret



Lamkin, Burt



Lamkin, Sally



LaMoreaux, Dave

www.ourhousemi.org

Our HOUSE

SUPPORT & RESOURCES FOR
Washtenaw County Youth Aging Out Of Foster Care.

MORE INFO AT

VISTING VET, PLLC
Your home is my office

Betty Jean Harper
D. V. M.
Veterinary Home Visits
3409 Rentz Rd.
Ann Arbor, Mich 48103

734-475-9474

SPRINGER INSURANCE AGENCY

Home – Auto – Life – Business

115 Park St.
Chelsea, Michigan 48118
Phone: (734) 475-8689

MEMBERS



Lande, Lynne



Lavin, Eloise



Lavin, Mark



LeRoy, Evan



Leslie, Dale



Linden, Terry



Luke, Gerry



Mattson, Ann



Mattson, Jim



McKeown, John



McMahon, Jerry



McNab-Cattell, Dot



Medrano, Joe



Mehraban, Sara



Meisner, Greg

Carol's VIP Adventures

Carol Presley
Travel Coordinator
carolsvipadventures@gmail.com

2420 North Street
Milford, MI 48380
248-390-2340

carolsvipadventures.com

Tropical Interiors
Interior Landscaping &
Plant Maintenance

▶ Gary Kavanagh

4701 Ann Arbor-Saline Rd.
Ann Arbor, MI 48103
734/662-2289

Ameriprise Financial

Dr. Sara Mehraban, Ph.D., CRPC®
Financial Advisor
Business Financial Advisor

Ameriprise Financial Services, Inc.
4750 Venture Dr. Suite #150
Ann Arbor, MI 48108-9505
T: 734.477.5233
D: 734.477.5224
F: 734.477.5288
sara.x.mehraban@ampf.com
ameripriseadvisors.com/sara.x.mehraban
CA Insurance #0C50218

An Ameriprise Financial franchise

MEMBERS



Meretta, Jim



Miller, Fred



Niemann, Wally



Okuley, Jeanette



Panning, Luke



Petroski, Martha



Phibbs, Charlie



Powers, Dennis



Presley, Carol



Preston, Gretchen



Rabidoux, Sandra



Reed, Steve



Reynolds, Jim



Robb, Bill



Robb, Michele



Roberts, Bud



Robinson, Jean



Salemi, Tony



Sampsel, John



Sanchez, Fred



Schechtman, Perry



Schenk, John



Schmerberg, Kurt



Schork, Pete



Shaw, Ken



Sheldon, Cliff



Smit, Dick



Smith, Susan



Snider, Bob



Soyars, Caroline

MEMBERS



Stewart, Mary



Supica, Max



Talcott, Jane



Taylor, RJ



Tse, Leo



Webb, Ellen



Wilder, Kathie



Williams, Julanne



Williams, Mel



Williams, Nicolette



Winkler, Chris



Wishka, Mark



Wolfington, Jim



Ziegler, Jr., Max



Ziesemer, Doug



James L. Wolfington
Vice President
Commercial Loan Officer

Phone - (734)385-1131
Fax - (734)385-1931
jwolfington@csbonline.com

1010 South Main St.
P.O. Box 10 • Chelsea, MI 48118-0010



Lynne Lande, L.M.S.W.
Staff Clinical Social Worker
LLande@SamaritanCounselingMichigan.com
Main: 248-474-4701 Fax: 248-474-1518

SAMARITAN COUNSELING CENTER
of Southeastern Michigan

29887 West Eleven Mile Road
Farmington Hills, Michigan 48336-1309

Norton's  Full Service
All Occasions
Local Delivery
Worldwide Dlvry

FLOWERS & GIFTS
Since 1892

www.nortonsflowers.com * 800-682-8667

<p>Ann Arbor 2558 W. Stadium SE Corner at Jackson 734-469-9100 Mon-Sat 9-6 Closed Sun</p>	<p>Flowers * Plants Greeting Cards Balloons * Crystal Religious and Inspirational Gifts</p>	<p>Ypsilanti 2900 Washtenaw 1 mi. East of US-23 734-434-2700 Mon-Sat 8-7 Sun 11-3</p>
--	---	--



2018 Past Presidents Picnic, June 27, 2018.



*Remembering Sheridan Springer:
Recipient of the Frank O. Staiger
Distinguished Kiwanian Award*

DOWNTOWN HOME & GARDEN

210 S. Ashley, Ann Arbor, MI 48104
downtownhomeandgarden.com
phone: (734) 662-8122
fax: (734) 662-8102

Inspire a lifetime of curiosity in one day



734.995.5439
aahom.org

EMPLOYEES



Bowman, Alex



Corr, Chris



Gasbarro, Mario

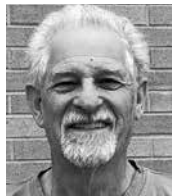

Gubachy, Dan



Hoang, Phong



Kennedy, Ralph



Lovett, Evan



Salamin, Tanya



Scott, Nick

Lisa Lemble
Operations Manager

4531 Concourse Drive
Ann Arbor, MI 48108
(734) 260-9026 cell
(734) 761-2576 x202 office
(734) 327-6127 fax

www.gretchenshouse.com email: lisa.lemble@gretchenshouse.com

"...fresh, thoughtfully prepared, and carefully cooked." —Ann Arbor Observer

cardamom
FRESH INDIAN

1739 Plymouth Road 734.662.2877
cardamomA2.com



MEMBERS

KIWANIS INTERNATIONAL PROHIBITS THE USE OF CLUB MAILING LISTS FOR SOLICITATIONS OR COMMERCIAL MAILINGS

The Membership Growth and Education Committee and the Board of Directors have established an honorary emerita/emeritus status for selected, long-term members who may no longer be able to participate in most club activities. The title "Emerita Member" or "Emeritus Member" appears next to the names of those members who have accepted our invitation to receive this honor.

- Allshouse, Emily** 2015; Commercial Account Executive, Kemner Iott Benz Insurance Agency; 955 W. Eisenhower Cir., Suite G, 48103; Home: 1028 Rabbit Run Cir, Apt 206, 48103, 517-673-0860; cell: 734-652-4289; emily.allshouse@gmail.com
- Anglin, Michael D (Mike)** 2004; Spouse: Kathleen; Retired Educator; Home: 549 S First St 48103; 734-741-9786; cell: 734-883-6983; mikeanglin07@gmail.com
- Argyle, Ray L** 2009; Spouse: Diane; Retired Fisheries Biologist; Home: 2688 Gloucester Way 48104; 734-973-9166; cell: 734-546-7198; rayarg41@gmail.com
- Babcock, Bryce W** 2009; Retired Engineer; Home: 142 Tower Dr, Saline 48176; 734-429-2249; babcockjb@comcast.net
- Barden, Jr., Robert J (Bob)** 1986; Spouse: Marti; Pres-CEO, Arbor Professional Solutions, P.O. Box 7820, 48107-7820; 734-665-6173; Home: 7368 Strieter Ct 48103; 734-665-2250; rjbarden@arborps.com
- Barden, Sr., Robert J (Bob)**, Emeritus Member; 1961; Spouse: Marge; Retired Credit Bureau Executive; Home: 4001 Glacier Hills, #222; 734-663-4835 (send mail to P O Box 7820)
- Barden-Perlberg, Kathleen (Kathy)** 1987; Spouse: Richard Perlberg; Director, Arbor Professional Solutions, P O Box 7820, 48107-7820; cell: 734-645-0491; fax: 810-229-3320; Home: 3036 Hideaway Beach Dr, Brighton 48114; 810-229-7517; kathyperlberg@gmail.com
- Barhydt, Rose Marie** 2006; Retired Teacher/Administrator; Home: 662 Peninsula Ct 48105; 734-662-4398; cell: 704-604-5509; rosemariabarhydt@gmail.com
- Barrett, Michael J (Mike)**, Emeritus Member; 2005; Spouse: Joan; Retired Teacher; Home: 404 S Glendale Dr 48103; 734-665-9452; barretts404@comcast.net
- Bassett, John R** 1994; Spouse: June; Retired Educator; Home: 1100 Clague Ave 48103; 734-662-1872; cell: 734-707-6699; jayrbass@umich.edu
- Beeman, Gordon L** 1985; Spouse: Anna; Retired Attorney; Home: 2295 Chaucer Dr 48103; 734-995-1788; cell: 734-864-6150; glbeeman@umich.edu
- Bell, David T (Dave)** 1988; Spouse: Judy; Retired Clergy; Home: 2 Eastbury Ct 48105; 734-994-0018; cell: 734-646-8475; dave@interfaithspirit.org
- Benedek, Richard S (Dick)** 1963; Spouse: Elissa; Retired Attorney; Home: 3607 Chatham Way 48105; 734-663-7128; cell: 734-604-1445; fax: 734-665-9383; epb@umich.edu
- Blomquist, James M (Jim)** 2003; Spouse: Donna; Retired Accountant; 418 Cottonwood Ln, Saline 48176; 734-316-7256; jblom48105@comcast.net
- Bomar, Francine M** 2018; Spouse: Horace; Retired Administrator; Home: 5160 Christine Dr 48103; 734-761-7487; cell: 734-645-3638; fbomar@umich.edu

MEMBERS

- Brokaw, Theron M (Ted)** 2013; Spouse: Deborah; Manager-Financial Reporting, Comerica Bank, 26000 Six Mile Rd, Livonia 48152; 734-632-7071; cell: 313-806-0216; Home: 2521 Mallard Ct 48105; 734-663-9722; tmbrokaw@comerica.com
- Brown, Jerry M** 1977; Spouse: Lyn; Retired Business Owner; cell: 810-523-5259; Home: 641 Scio Church Rd 48103; 734-994-5005; edgbrown@aol.com
- Buhrer, Patricia M (Pat)** 1988; Spouse: Arno; Retired Registered Nurse & Bereavement Specialist; Home: 755 Patricia Ave 48103; 734-996-0332; annarborite@earthlink.net
- Bulkley, Jonathan W (Jon)**, Emeritus Member; 1986; Spouse: Trudy; Retired Prof., UofM School of Environment and Sustainability, and Department of Civil & Environmental Engineering, College of Engineering; Home: 1915 Scottwood Ave 48104; 734-769-3115; jbulkley@umich.edu
- Burg, Alan J** 1999; Spouse: Ken Hillenburg; Retired Educator; Home: 2842 Leslie Park Circle 48105; 517-403-7365; alan.burg@me.com
- Burroughs, Daniel L (Dan)** 2002; Spouse: Adrienne; Retired Teacher, Ann Arbor Public Schools; Home: 2343 Peters Rd 48103; 734-663-3831; cell: 734-604-8992; danlbrghs@gmail.com
- Carey, James M (Jim)** 2003; Realtor, Charles Reinhart Co. Realtors; office phone: 734-769-3800; Home: 1330 Astor Ave, #1713 48104, cell: 734-717-5591; jcarey@provide.net
- Carr, Robert I (Bob)** 1982; Spouse: Jeannette; Retired Prof of Civil Engineering at UM & Consulting Civil Engineer; Home: 542 Heritage Dr 48105; 734-665-8287; ricarr@umich.edu
- Conlin, Edward F (Ed)**, Emeritus Member; 1962; Spouse: Doris; Retired, Retail Management; Home: 2115 Nature Cove Ct, Apt 108, 48104; 734-975-1976; ed0810@aol.com
- Conlin, Jr, Robert J (Bob)** 1990; Spouse: Julie; President, R J Conlin, Inc., 3025 Boardwalk Dr, Suite 100, 48108; 734-205-1532; Home: 2521 Towner Blvd 48104; 734-973-8538; conlin@rjconlin.com
- Cross, Harry L** 1991; Spouse: Carmen; Retired; Home: 3207 N Wagner Rd 48103; home: 734-769-3241; cell: 734-395-8097; hlcross@umich.edu
- D'Angelo, Marianne Elizabeth** 2016; Licensed Clinical Psychologist, Founder/Owner, Dexter Psychological Services, 8011 Main St., Dexter 48130; fax: 734-235-0087; cell: 734-395-9380; Home: 7680 Hudson Ct., Dexter, 48130; doctormdangelo@gmail.com
- Dabbs, Michael F (Mike)** 1981; Spouse: Pamela; Retired Executive; Home: 3124 Fawnmeadow Ct 48105; Landline and fax: 734-668-4884; cell: 734-883-4884; mfdabbs10@gmail.com
- Dahl, Claire K** 2011; Spouse: John; Retired High School Teacher; Home: 5196 Doral Ct 48108; 734-470-6196; cell: 734-395-8742; apqueen.claire@gmail.com
- Dahl, John E** 2004; Spouse: Claire; Retired Human Resources Manager; Home: 5196 Doral Ct 48108; 734-470-6196; cell: 734-395-3840; jedwardd20@gmail.com
- Dailey, Suzanne (Sue)** 2014; Retired, UofM; Home: 6889 Wellington Dr, Dexter 48130; 734-426-4267; sudailey@umich.edu

MEMBERS

- Dever, C Nicholas (Nick)** 1974; Spouse: Nancy; Retired Attorney;
Home: 13877 E Old US 12, Chelsea 48118; cell: 734-368-3069; ndever46@gmail.com
- Dever, Dana A (Dan)** 1977; Spouse: Sharon Smith; Attorney, DeLoof, Dever, Wright, & Milliman, PLLC,
301 N Main St, Suite 250, 48104; 734-994-1295; cell: 734-646-8228; dad@dhdwlaw.com;
Home: 6600 Bethel Church Rd, Saline 48176; 734-944-9963; danaadever@aol.com
- Dick, G. Griffith (Griff)** 2014; Spouse: Jeanne Kuo; Retired Attorney; Home: 600 Westwood Ave 48103;
cell: 734-355-2339
- Dittmar, Larry E** 2017; Spouse: Prudy; Retired Educator; Home; 5599 Gallery Park Dr, 48103;
734-662-8811; lpdittmar66@gmail.com
- Donner, Garrett J (Garry)** 1994; Spouse: Karen; President, Random Games & Toys, 416 W Huron St
48103; 734-761-9140; cell: 734-476-1322; Home: 6451 Gallery Dr, Canton 48187; 734-416-1815;
garryrgt@gmail.com
- Drake, David J (Dave)** 1968; Spouse: Marilyn; Retired Investment Planner; Home: 4897 Doral Dr 48108;
734-623-4433; djdstatman@gmail.com
- Dries, James L (Jim)** 2018; Spouse: Cathie; Retired Chief Deputy Clerk, Washtenaw County;
Home: 3840 Michael Rd 48103; 734-662-6256; cell: 734-972-6010; jdries27@gmail.com
- Dukes, Clarence E (Clarey)**, Emeritus Member; 1965; Retired Dental Education Administrator, UofM;
Home: 2424 Dayton Dr 48108; 734-677-1157; clarpeg5566@gmail.com
- Elling, Gary R** 1985; Spouse: Liz; Retired Engineer; cell: 734-223-2999; Home: 1402 Maywood Ave 48103;
734-995-2175; garyelling@comcast.net
- Evans, Garrett H (Garry)** 2001; Spouse: Mary; Retired Prof of Civil & Environmental Engineering, UofM;
Home: 1720 Coburn Ct 48108; cell: 734-223-6760; mar99gar@hotmail.com
- Fegan, Thomas J (Tom)**, Emeritus Member; 1965; Retired County Planner; Home: University Senior
Living, 2865 S Main St 48103
- Fomby, Paula** 2017; Spouse: Richard Miech; Research Assoc. Prof., UofM Institute for Social Research,
426 Thompson St, 48106; 734-763-3850; Home: 1430 Granger Ave 48104; 734-845-9728;
cell: 303-349-4098; pfomby@gmail.com
- French, Larry E** 1994; Spouse: Linda; Retired Financial Consultant; Home: 2201 Twin Islands Ct 48108;
734-994-6599; cell: 734-276-1253; lefrench@comcast.net
- Gallup, Albert E (Al)** 2001; Spouse: Karen; Retired High School Principal, Ann Arbor Public Schools;
Home: 1201 Bydding Rd 48103; 734-662-1559; algallup1@gmail.com
- Gardner, Ronald D (Ron)** 2001; Spouse: Diana; Attorney, Gardner & Associates PC, 1601 Briarwood Circle,
Suite 200, 48108; 734-669-0424; cell: 734-904-4369; fax: 734-665-6179; Home: 159 Kingsbrook Ave
48103; 734-663-6611; rgardner035@gmail.com
- Gilligan, George J** 1988; Spouse: Mary; Retired Wealth Manager; cell: 734-417-9138;
Home: 1450 Glastonbury Rd 48103; 734-994-5820; gilligangeorge6@gmail.com

MEMBERS

- Goodkin, Mitchell A (Mitch)** 2016; Spouse: Barb; Retired Lawyer and Retired Licensed Professional Engineer; Home: 2658 Esch Ave, 48104; 734- 971-0899; cell 734-417-2340; mitchjdpe1@gmail.com
- Goss, Ryan H** 2001; Funeral Director, Nie Family Funeral Home, 2400 Carpenter Rd 48108; 734-971-2345; Home: 772 Jackson Ln, Milan 48160; 734-985-1168; ryangoss@niefuneralhomes.com
- Grachek, Caroline Marie** 2017; Curriculum Assistant, UM Ross School of Business, 700 E University 48104, Home: 618 S Main, Apt. 625, 48104; cell: 734-624-5599; cmgrache@umich.edu
- Gray, Robert H (Bob)** 2007; Spouse: Susan Smith; Emeritus Professor, UofM; Home: 2360 Londonderry Rd 48104; 734-668-0798; cell: 734-604-4977; Pinckney Lake Home: phone: 810-231-1412; rhgray@umich.edu
- Greene, Robert (Bob)** 2003; Spouse: Elaine; Retired Engineer; Home: 1281 Laurel View Dr 48105; 734-665-5890; greenrob@sbcglobal.net
- Hadwin, Karen A** 2018; Retired UofM Hospital Administrator; Home: 11834 Eriksen Dr, Pinckney 48169; cell: 808-286-1995; khadwin@hotmail.com
- Hampton, William V** 2013; Spouse: Esther; Retired, City Government; Home: 1184 Wendy Ct 48103; 734-665-6347; cell: 734-417-6902; wvhamp@comcast.net
- Hanton, Douglas O (Doug)** 1965; Spouse: Ann; Retired Banker; 7238 Eaton Ct, Dexter 48130; 734-580-2107; dahanton@sbcglobal.net
- Harper, Betty Jean Roseum** 1993; Visiting Vet; Office & Home: 3409 Rentz Rd 48103; office: 734-475-9474; home: 734-433-1550
- Hawkins, Harry Payne** 2018; Spouse: Jan; General Manager, West Hawk Industries, 1717 S State, 48104, 734-761-3100; Home: 1790 Arlington, 48104, 734-662-0107; cell: 734-646-8467; sales@westhawkpromo.com
- Heller, Frederic W (Bill)** 2015; Spouse: Diane; Retired Attorney; Home: 4225 Hawthorn Place 48103; 734-253-2063; cell: 734-945-9575; fwheller@concentric.net
- Hendricks, Richard D (Rick)** 1978; Spouse: Deborah; Retired Accountant; Home: 3325 Brassow Rd, Saline 48176; 734-429-8549; rdhendricks51@gmail.com
- Hillenburg, Kenneth L (Ken)** 2011; Spouse: Alan Burg; Retired Clinical Prof, School of Dentistry, Univ of Detroit Mercy, Home: 2842 Leslie Park Circle 48105; 517-673-6000; hillenburg@me.com
- Hiller, Steven J (Steve)** 2004; Spouse: Wendy; Chief Assistant Prosecutor, Washtenaw County, 200 N Main St, Suite 300, 48107; 734-222-6603; cell: 734-474-6663; Home: 1175 Morehead Ct 48103; 734-761-2476; stevenjhiller@sbcglobal.net
- Hughes, David A (Dave)** 2007; Spouse: Bonnie. Retired Engineer; Home: 3520 Paisley Ct 48105; 734-665-2674; hughesda@comcast.net
- Johnson, Robert M (Bob)** 1998; Spouse: Linda; Retired Clinical Toxicologist; Home: 1522 Arborview Blvd 48103; cell; 734-330-3247; johnsonr07@comcast.net

MEMBERS

- Jones, Deborah A (Deb)** 2013; Spouse: Steven; Vice President-Trust & Investment Mgt, Bank of Ann Arbor, 125 S Fifth St 48104; 734-327-1139; fax: 734-669-2493; Home: 1136 S Seventh 48103; 734-996-2334; debjones@boaa.com
- Kavanagh, Gary K** 2016; Owner, Tropical Interiors; Office and Home: 4701 Ann Arbor-Saline Rd. 48103; cell: 734-662-2289; garykevin09@gmail.com
- Keyes, Sharon** 1998; Spouse: Landis; Retired; Home: 609 Sunset Rd 48103; 734-662-7702; cell: 734-476-3265; keyes.sharon@gmail.com
- Kidle, John M** 1985; Spouse: Marykay; Retired Banker; Home: 7646 Purple Martin Way, Dexter 48130; 734-665-6162; cell: 734-756-7056; jkidle@gmail.com
- Kinney, Richard E (Rip)** 1995; Retired High School Coach/Counselor, Pioneer High School; Home: 1942 Peppermill Way 48103; 734-663-0826; rip.kinney@juno.com
- Klinger, Paul D** 1966; Spouse: Pamela; Retired, UofM; Home: 2569 Easy St 48104; cell: 734-649-1009; pklinger@umich.edu
- Kossick, Donald J (Don)** 1995; Spouse: Karen; Retired Educator; Home: 1405 E Park Place 48104; 734-665-2758; cell: 734-272-7953; kkoss@comcast.net
- Kotch-Duda, Andrea** 2009; Spouse: Walt; Senior Vice President, Investments, Raymond James & Associates, Inc.; 31500 Northwestern Hwy, Suite 150, Farmington Hills 48334, 248-932-5450; cell: 313-719-9034; Home: 15034 Fox, Redford 48239; 313-531-4363; andrea.kotchduda@raymondjames.com
- Krasnoff, Margaret J** 2015; Spouse: Justin; Attorney, DeLoof, Dever, Wright, & Milliman PLLC, 301 N Main St, Ste 250, 48104; 734-994-1295; cell: 734-834-7811; mjkd@ddwmlaw.com; Home: 5555 Gallery Park Dr 48103; 734-665-2236; margaretkrasnoff@gmail.com
- Lamkin, Burton (Burt)** 1998; Spouse: Sally; Retired Educator; Home: 900 Egret Dr, Chelsea, 48118; 734-562-2307; bla3939@aol.com
- Lamkin, Sally A** 1998; Spouse: Burt; Retired Educator; Home: 900 Egret Dr, Chelsea, 48118; 734-562-2307; bla3939@aol.com
- LaMoreaux, David (Dave)** 2015; Spouse: Linda; Retired Manager, NSF *International*; Home: 1600 Arbordale 48103; 734-761-4322; cell: 734-717-2474; dtlamx@gmail.com
- Lande, Lynne P** 1987; Psychotherapist, Samaritan Counseling Center of Southeastern Michigan, 29887 W Eleven Mile, Farmington Hills 48336; cell: 734-649-0583; Home: 1845 E Joy Rd 48105; lynnelande@me.com
- Lavin, Eloise** 2015; Spouse: Mark; Owner, Lavin Consulting, LLC; Office & Home: 2020 Scio Church Rd. 48103-6061; cell: 734-255-0242 eloise@lavinconsulting.net
- Lavin, Mark T** 2018; Spouse: Eloise; Retired Operations Consultant; Home: 2020 Scio Church Rd. 48103-6061; cell: 734-255-0015; eloise.lavin@gmail.com
- LeRoy, Evan C** 2008; Spouse: Anna; Portfolio Manager, Retirement Income Solutions, 2301 Platt Rd, Ste 300, 48104; 734-769-7727; Home: 996 Marshall Lakes Dr, Dexter 48130; cell: 269-501-3299; evleroy@gmail.com

MEMBERS

- Leslie, Dale R** 1979; Retired Retail Store Owner; cell: 734-660-1023; Home: 1159 Joyce Lane 48103; daleleslie@comcast.net
- Linden, Terry M** 2016; Owner, Empire of Ideas, Inc., P. O. Box 1961, Ann Arbor 48106-1961; Home: 811 S Fifth St, Apt 1, 48103-4869; cell: 734-369-6269; TerryEmpireOfIdeas@gmail.com
- Luke, Gerald L (Gerry)** 2016; Spouse: Phyllis. Engine manufacturing engineering manager, retired, Ford Motor. Home: 5139 Polo Fields Dr., 48103; 734-214-5292; cell: 734-660-1972; gerryluke@mac.com
- Mattson, Ann E** 1990; Spouse: Jim; Retired Judge, 15th District Court; Home: 1716 Ridge Rd, Chelsea 48118; 734-475-2879; cell: 734-358-4425; mattana2@aol.com
- Mattson, James A (Jim)** 2010; Spouse: Ann; Retired, UofM Credit Union; Home: 1716 Ridge Rd, Chelsea 48118; 734-475-2879; mattana2@aol.com
- McKeown, John R**, Emeritus Member; 1982; Retired Manufacturers' Representative; Methodist Retirement Center, 801 W Middle St., Chelsea 48118
- McMahon, Gerald F (Jerry)** 1992; Jerry's Painting; Office & Home: 1472 Borgstrom Rd, Ypsilanti 48197; 734-482-5408; cell: 734-383-7653; jerrymcmah@aol.com
- McNab-Cattell, Dorothy M (Dot)** 2008; Retired Educator; Home: 351 Barton Shore Dr. 48105; 734-665-0702; cell: 734-476-7300; dotcatt734@gmail.com
- Medrano, Joseph C (Joe)** 1970; Retired Educator; Home: 1963 Knollwood Bend, Ypsilanti 48198; 734-480-1516; jdrano32@yahoo.com
- Mehraban, Sara** 2011; Financial Advisor, Ameriprise Financial Services, 1590 Eisenhower Place 48108; 734-477-5233; fax: 734-477-5288; sara.x.mehraban@ampf.com
- Meisner, Gregory P (Greg)** 2015; Spouse: Gretchen Preston; Retired Research Scientist; Home: 4660 W Ellsworth Rd 48103; cell: 734-717-8253; gmeisner@hotmail.com
- Meretta, James L (Jim)** 1978; Spouse: Kristy; Retired Trust Advisor; Home: 700 Lans Way St 48103; 734-663-2534; cell: 734-476-6128; jmeretta@sbcglobal.net
- Miller, Frederick H (Fred)** 2014; Spouse: Gae; President, Fred Miller Associates LLC; Home: & Office: 1459 Covington Dr 48103; cell: 734-904-6811; fmiller634@gmail.com
- Niemann, Walter W (Wally)** 1952; Retired Dentist; Home: 5353 McAuley Dr., Apt. 323, Ypsilanti, 48197; cell: 734-646-4157; wwniemann@sbcglobal.net; website: DDSWally.com; ddswwally youtube
- Okuley, Jeanette M**, Emerita Member; 1989; Home: 3250 Kingwood St 48103; 734-996-3593; okuleyjm@att.net
- Panning, Luke** 2015; Spouse: Katherine; Financial Advisor, Edward Jones, 213 N Maple Rd 48103; 734-761-5309; fax: 888-311-2232; cell: 616-990-7083; Home: 1217 Island Dr, #203, 48105; luke.panning@gmail.com
- Petroski, Martha J** 2009; Retired; Home: 2326 Packard St 48104; 734-761-3740; cell: 734-320-0146; marthp3@gmail.com

MEMBERS

- Phibbs, Charles A (Charlie)** 1990; Retired, Sales Electrical Construction, McNaughton-McKay Electric Co; Home: 1610 Dexter Ave #2, 48103; cell: 734-646-7825; orvis50@yahoo.com
- Powers, Dennis M** 2011; Spouse: Jeanie; Principal, DM Powers & Associates, 317 S Division St 48104; 978-886-4554; Home: 2018 Carhart Ave 48104; 734-741-5140; carhart2018@aol.com
- Presley, Carol Lynn** 2018; Owner, Carol's VIP Adventures; Home and Business: 2420 North St, Milford 48380; cell: 248-390-2340; carolsvipadventures@gmail.com
- Preston, Gretchen** 2008; Spouse: Greg Meisner; Owner, Gretchen's House Child Development Centers, 4531 Concourse Dr 48108; 734-761-2576; Home: 4660 W Ellsworth Rd 48103; cell: 734-260-9027; gretchen.preston@gretchenshouse.com
- Rabidoux, Sandra M (Sandy)** 2017; Spouse: Mark; Paralegal, Mark K Rabidoux, PLC, PO Box 1287, 48106, 734-994-6523; fax: 734-261-2580; Home: 1714 Tudor Dr, 48103; cell: 248-225-3908; smmamo@sbcglobal.net
- Reed, Steven A (Steve)** 1993; Owner, Reed Law Group PC, 2178 S State St, Suite A, 48104; 734-761-5860; fax: 734-761-5861; Home: 200 Briarcrest Dr, #120, 48104; steve@reedlawgroup.com
- Reynolds, James A (Jim)** 2002; Spouse: Ligia; Retired Professor, EMU; Home: 1475 Maywood Ave 48103; 734-665-0012; cell: 734-546-0932; jaliro@comcast.net
- Robb, Michele D** 2010; Owner, MDR Consulting, 3588 Plymouth Rd, #255, 48105, 734-358-0223; Home: 2529 Meade Ct, 48105, cell: 734-358-0223; mdrobb@comcast.net
- Robb, William C (Bill)** 1999; Spouse: Phyllis; Retired Manager; Home: 566 Heritage Dr 48105; 734-769-3286; cell: 734-389-5232; wrobb@comcast.net
- Roberts, Edward C. III (Bud)** 2016; Retired; Home: 6655 Jackson Rd, Scio Farms Estates #98, 48103; 734-426-5102; cell: 734-320-3898
- Robinson, Jean M** 2000; Retired Medical Social Worker; Home: 1020 Cedar Bend Dr 48105; 734-662-6303; jean.robinson@mygait.com
- Salemi, Tony** 2016; Retired Manager; Home: 4705 Sawgrass Dr, E, 48108; cell: 954-242-1067; tonys48108@gmail.com
- Sampelle, John L** 1988; Spouse: Carolyn; Retired Finance Manager; Home: 1230 Bardstown Trail 48105; 734-761-1859; cell: 734-239-1442; jsampelle@gmail.com
- Sanchez, Federico I (Fred)** 1980; Property/Facilities Mgt; Home: 2645 Gladstone Ave 48104; cell: 734-277-7077; fsanchez@aol.com
- Schechtman, Perry** 1988; Dept Administrator, UofM Department of Ophthalmology, 1000 Wall St 48105; 734-763-4658; Home: 1428 Coventry Sq Dr 48103; 734-662-0050; cell: 734-649-1782; pschecht@umich.edu
- Schenk, John E** 2011; Spouse: Nancy; Retired Engineer; Home: 3309 Yellowstone Dr 48105; 734-663-9249; cell: 734-255-1797; jeschenk@comcast.net

MEMBERS

- Schmerberg, Kurt R** 1980; Spouse: Jane; Vice-President, Affinity Valuation Group LLC, 1310 S Main St, Suite 7, 48104; 734-747-7080; fax: 734-929-1260; Home: 800 Mt Vernon Ave 48103; 734-662-5928; kurt@provide.net
- Schork, Peter F (Pete)** 1988; Spouse: Annette; President & CEO, Ann Arbor State Bank, 125 W William, 48104; 734-761-1480; fax: 734-761-4780; cell: 734-417-6733; Home: 852 Sciomeadow Dr 48103; Peterschork@gmail.com
- Shaw, Kenneth A (Ken)** 2001; Self-employed Computer Programmer; Home: 910 Heather Way 48104; 734-971-1445; khaw@comcast.net
- Sheldon, Clifford G (Cliff)** 1976; Spouse: Ingrid; Retired Banker; Home: 1416 Folkstone Ct 48105; 734-665-5893; cliff.sheldon@gmail.com
- Smit, Richard L (Dick)** 2011; Spouse: Dee; Retired Civil Engineer; Home: 1441 Greenview Dr 48103; 734-995-1157; dsmit2@comcast.net
- Smith, Susan M** 2017; Spouse: Bob Gray; Retired Actuary; Home: 2360 Londonderry Rd., 48104; Lake home: 810-231-1412; cell: 734-834-0374; smithsms@umich.edu
- Snider, C Robert (Bob)**, Emeritus Member; 1978; Spouse: Luz; Retired Meteorologist; 165 Kingsbrook Ave 48103; 734-665-8890; cell: 734-255-5584; luzvictoria@ameritech.net; crbobsnider@gmail.com
- Soyars, Caroline R** 2018; Program Manager, UofM, Room 3320, G. G. Brown Laboratory, 2350 Hayward St 48109; 734-764-9366; Home: 4985 Pitchpine Ln W, Apt #3D, Ypsilanti 48197; cell: 630-857-0651; csoyars@umich.edu
- Stewart, Mary** 2017; Spouse: Andrew Tay; Manager, Warm The Children; 734-945-4955; Home: 2988 S. Foxridge Ct 48105; cell: 734-945-4955; mkcstewart61@gmail.com
- Supica, Max** 2000; Spouse: Sue; Retired, Logistics, Ford Motor Co; Home: 220 Katherine Way, Dexter, 48130; cell 734-649-6837; maxsupica@aol.com
- Talcott, M Jane (Jane)** 2007; Exec Director, Washtenaw Camp Placement; 734-971-4537; Home: 6886 Ernst Rd, Manchester 48158; 734-428-8890; cell: 734-678-1696; talcoj@yahoo.com
- Taylor, Robert J (RJ)**, Emeritus Member; 1950; Retired Salesman; Home: 6230 S State St, Apt 166, Saline 48176; cell: 734-355-4530; rjtaylor25@gmail.com
- Tse, Lai Yu Leo (Leo)** 2018; UM Research Fellow, Mech. Engn. 2350 Hayward St, 48109; Home: 2227 S State St. Apt #115, 48104; cell: 607-661-8823; tselaiyu@umich.edu
- Webb, Ellen F** 1991; Owner, Ellen's Quilt Creations; Home: & Office: 650 Cherry Grove, Canton 48188; 734-927-4008; cell: 734-516-7975; ellen@ellensquiltcreations.com
- Wilder, Kathie E** 2014; Retired Development Officer; Home: 623 Susan Dr 48103; cell: 734-660-5135; kwildera2@gmail.com
- Williams, Julianne C** 2001; Spouse: Jeff; Owner, Fountain Communications; Office & Home: 6566 Lexington, Whitmore Lake 48189; cell: 734-358-2603; julanne1@me.com

MEMBERS

Williams, Melvin D (Mel) 1993; Emeritus Professor of Anthropology, UofM; 734-764-7153; cell: 412-302-9108; fax: 734-763-6077; Home: 3 Parkview Place, #1, 48103; 734-665-9537; mddoubly@umich.edu

Williams, Nicolette R 2016; Special Education Teacher, Farms Intermediate School, 581 Taylor Rd, Hartland 48353; Home: 6566 Lexington Dr, Whitmore Lake 48189; cell: 734-604-5090; nwilli35@emich.edu

Winkler, Christopher B (Chris) 2007; Spouse: Noel Ann; Research Scientist Emeritus, UofM Transportation Research Institute, 2901 Baxter Rd 48109; 734-936-1061; Home: 65 Barton Lane 48105; 734-761-9409; cell: 734-678-6849; cbw@umich.edu

Wishka, Mark S 1998; Spouse: Narda; Private Wealth Advisor, CDFA, CFP, ChFC, CLU, CASL, CRPC, CLTC, RHU, REBC; Clarity Financial Advisors, an affiliate of Ameriprise Financial, 1310 S Main St, Suite 10, 48104; 734-995-3996; cell: 734-945-9400; fax: 734-995-6364; Home: 211 Third St 48103; 734-663-3635; mswishka@comcast.net

Wolfington, James L (Jim) 2004; Spouse: Ernest Kalina; Vice President, Chelsea State Bank, 1010 S Main St, Chelsea 48118; 734-385-1131; fax: 734-475-7740; Home: 110 N Revena Blvd 48103; jwolfington@csbonline.com

Ziegler, Jr, Max M 1967; Spouse: Carol; Retired Banker; Home: 2117 Carol Dr 48103; 734-662-3303; cell: 734-649-3979; antiquesz@aol.com

Ziesemer, Douglas F (Doug) 1978; Spouse: Pam; Realtor, RE/MAX Platinum Realtors, 2745 Aspen Dr, 48108; 734-769-8111; fax: 734-623-8455; cell: 734-395-2092; Home: 2745 Aspen Rd 48108; dfziesemer@aol.com



Every day has meaning in the definition of a life.



Peace
wvh



52 KCAA members and guests saw the Tigers lose to the Twins, 4 to 3, on August 11



KC is ready for Halloween

KNIGHT'S MARKET



420 Miller Ave. • Ann Arbor, MI 48103 • (734) 665-6494

Prime Beef • Amish Chicken • Pork

LAVIN 

CONSULTING, LLC

*Accounting & Operational
Consulting Services*

Eloise M. Lavin, President

(734) 255-0242 eloise@lavinconsulting.net

Kiwanis Young Professionals (KYP) Washtenaw County



KYP formed as a club satellite of KCAA in January of 2016. The KYP mission statement is:

Build an inclusive group of young professionals who focus on service, stewardship, and development in the Washtenaw County area while mindfully observing the Objects of Kiwanis (page 1).

KYP meets in the evening on a monthly basis at various local restaurants. These times are used to plan unique volunteer projects and social events.

Active KYP club members are: Emily Allshouse, Caroline Grachek, Evan LeRoy, Luke Panning, Caroline Soyars, Leo Tse, Julanne Williams, Nicolette Williams, and Melissa Zho (Circle K).

Find more information and KYP meeting times at:

<https://a2kiwanisfoundation.org/young-professionals/>

Duda

WEALTH ADVISORS
of

RAYMOND JAMES®

ANDREA KOTCH DUDA, CFP®

Senior Vice President, Investments

31500 Northwestern Hwy., Suite 150 // Farmington Hills, MI 48334

TF 800.548.8008 // 248.932.5450 // Fax 866.522.9601

andrea.kotchduda@raymondjames.com

raymondjames.com/andreakotchduda

CFP Board owns the CFP® and CERTIFIED FINANCIAL PLANNER™ marks in the United States.

© 2018 Raymond James & Associates, Inc., member New York Stock Exchange/SIPC. 18-BR35N-0187 TA 8/18



The Kiwanis Center

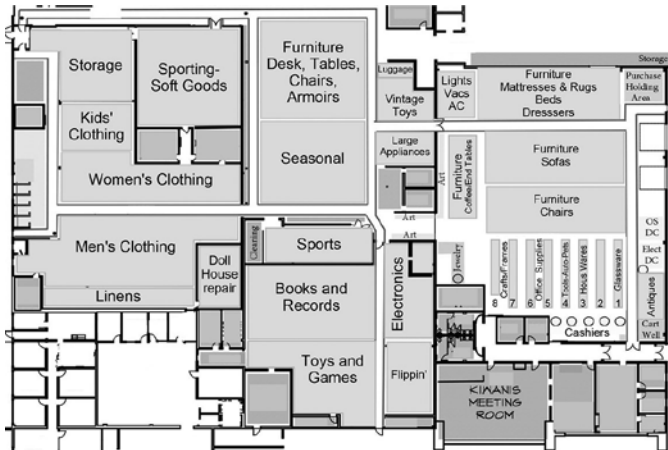

Layout of the Sales Floor of the Kiwanis Thrift Sale

I love to help!

You have worked hard to build for your retirement, now let the professionals at Bank of Ann Arbor Trust and Investment Management Group help you by providing portfolio management.

While Bank of Ann Arbor is not affiliated with Fidelity or TIAA-CREF, our relationship with them allows us the ability to select investments, execute trades, and manage your retirement accounts.

I welcome the opportunity to meet face-to-face with you to review your financial situation and discuss the ways that our team can **help you reach your goals.**



Deb Jones
Vice President & Business
Development Officer

Direct: 734.327.1139
Cell: 734.604.5575
debjones@boaa.com

125 S. 5th Ave.
Ann Arbor, MI 48104
boaa.com

bank of
ann arbor

2018 KIWANIS CLUB SCHOLARSHIP RECIPIENTS COLLEGE SCHOLARSHIPS



Top Row: Ahmed Ahmed, Lanah Almatroud, Elaina Baker, Tej Grewal Bergin, Terah Lee Blakemore, Antonio Brann, John Creal, Trevor Cross, Fatoumata K. Diakite

Row 2: Trevor Dial, Larissa Aissata Diarra, Lawrence Martin Eiden II, Tony Fata, Katherine Fehrle, Alexis Danielle Harrison, Shivani Jayendraprasad, Lia McGrath Kahan, Daniel Kennedy

Row 3: Casey J. Klobucar, Aaron Kofsky, Matthew Krivan, Linden Henry Kronberg, Kyla Lewis, Domanique Littlefield, Casimir Mankowski, Bess Rachel Markel, Charity Master

Row 4: Emily Mattson, Michelle Merritt, Myles C. Miller, Timothy Mladin, Asia Parsons, Chloe Elise Press, Deondre C. Pruitt, Mahogany Richmond, Anna Schafer

Bottom Row: Michael Shkolnik, Clayton Skinner, Hevin White, Elizabeth Anne Whybark, Sara Katherine Whybark, Megan Zhao, Christopher Zou

Not Pictured: Ashlyn Strain

MUSIC CAMP SCHOLARSHIPS



DeMarcus
Franklin



Sarita
Gankin



Kyla
Graves



Jumong
Jang



Mia
Sanborn



Shravan
Swaminathan

VOLUNTEERS

*Our Kiwanis Club
Volunteers Are
the Greatest*



Aiken, Erin



Bagchi, Carol



Bartlett, Lisa



Bignall, Gloria



Bingham, Eve



Birkle, Aaron



Birkle, Lea



Birkle, Mike



Boone, Elizabeth



Brown, Pamela



Burbridge, Cecile



Buttrum, Carole



Cebulski, Linda



Choate, Susan



Clear, Janet



Clemence, Mary



Cramer, Susan



Damon, Jill



Danforth, Jim



Daprich, Dan



Daprich, Patricia



Day, Mary Beth



Dever, Nancy



Dittmar, Prudy



Doyle, Bernie



Evans, Linda



Evans, Mary



Ferguson, Mary

VOLUNTEERS



Finch, Billy



Frederick, Muriel



Gallup, Karen



Gerlinger, Rick



Gravlin, Katherine



Haas, Jared



Harback, Mike



Hartman, Alice



Hill, Mary



Hitchcock, Kate



Hyde, Robert (Bob)



Ignatoski, Phillip



Ishmeal, Elaine



Johnson, Linda



Jones, Ken



Krueger, Susan



Lillie, Joan



Lillie, Rob



Lutton, Louise



Lyman, Fran



MacDonald, Margaret



Masters, Joan



Maten, Glenda



Maten, Ralph



Mathews, Joan



McNish, Jan



Meneghini, Linda



Messer, Joan



Misko, Susan



Mortensen, Cynthia

VOLUNTEERS



Neff, Merry



Nuhn, Rob



Olcott, Cynthia



Penkalski, Sandra



Potthoff, Robin



Raggett, James



Raubolt, Dan



Rescorla, Meg



Richard, Veronica



Rolka, Lynn



Rydzon, Debbie



Schaffner, Paul



Schuman, Fred



Schuman, Rhonda



Service, Genia



Shaw, Ron



Sibole, Ann



Smit, Dee



Soden, Sally



Springer, Sallie



Stephens, Gloria



Stephenson, Meg



Stine, David



Stuber, Elsa



Summers, Carla



Supica, Sue



Vondenberger, Annette



Wells, Marcia



Wells, Sherrel



Ziegler, Carol

ZELLER FELLOWS

In 2011 Kiwanis International (KI) established the Walter Zeller Fellowship to commemorate Walter Zeller, who made the first gift of 25 silver dollars to establish the KI Foundation. The Zeller Fellowship recognizes a gift of at least \$1,250 to the ELIMINATE Project, an undertaking to raise \$110 million by 30 September 2015 to eliminate maternal neonatal tetanus in mothers and newborns in countries where this disease remains a threat.

On 22 August 2011, our Club membership pledged to donate \$100,000 to the KI worldwide ELIMINATE Project by 30 September 2015, a goal we met and exceeded by raising \$103,185. The names of Zeller Fellows are permanently displayed on a board on the top floor of the Kiwanis Center. Fellows to date are as follows (“c” denotes Charter Fellow; “d” denotes Diamond Fellow):

John R Bassett
Gordon Beeman (c)
Dick & Elissa Benedek
Robert Carr
Don Clewell
Harry L Cross
Alan Dailey
Andrea Kotch Duda
Clarence Dukes
Larry E French (c,d)
Diana Gardner

Ronald D Gardner (c)
George & Mary Gilligan
John Goff
Robert H Gray (c)
Dave Hughes
Robert M Johnson (c)
Fred Keppler
J Thomas Lovell
Ann E Mattson
Jim Mattson
Stephen A Pezda (c)

William Robb
John Sampselle
Clifford G Sheldon (c)
Susan M Smith
Sheridan W Springer (c)
William R Tasch
Jim & Linda Wight
Carl E Williams (c)
Mark & Narda Wishka



Clarity Financial Advisors

Ameriprise Private Wealth Advisory Practice

Mark S. Wishka, CFP®, ChFC®, CRPC®, CDFA®, CLU®, RHU®, REBC®, CLTC®, CASL®
Financial Advisor, CERTIFIED FINANCIAL PLANNER™ practitioner

Clarity Financial Advisors

A private wealth advisory practice of Ameriprise Financial Services, Inc.

1310 S. Main St., Ste 10 • Ann Arbor, MI 48104

734.995.3996

mark.s.wishka@ampf.com, CA Insurance #0E25930

Find us on 



The Compass is a trademark of Ameriprise Financial, Inc. Member FINRA and SIPC

©2018 Ameriprise Financial, Inc., All rights reserved.

2142284ACMR0618

CLUB FUNDRAISING AND GIVING

The Kiwanis Club of Ann Arbor began raising money in 1925 by selling newspapers. In 1927 it teamed with King's Daughters, a local church guild, to hold periodic three-day rummage sales in vacant stores and, from 1948 to 1967, in the National Guard Armory. From February 1968 through 1990, sales were held in the Kiwanis Center Downtown (KCD) periodically, thence weekly on Saturday mornings. In January of 2012, through the generosity of Don Butcher, a former club member, and Jake Haas, the club acquired temporary use of an 8000-sq-ft warehouse at 840 Airport Plaza Dr. in which to store and sell furniture and other large items. Then, in 2014, the club's Foundation purchased a 17.4-acre lot, including a warehouse and office complex, located at 100 North Staebler Road, which became the Kiwanis Center West (KCW). Regular Saturday sales began at KCW on June 13, 2015. Sale of the KCD building was completed in January 2018. Consequently, all our Kiwanis activities, including the Thrift Sale, are now held at the Kiwanis Center (KC, previously KCW) at 100 North Staebler Road. Currently, the Kiwanis Thrift Sale is open 50 weeks of the year at KC from 9 AM to 1 PM on Fridays and Saturdays.

Thrift Sale merchandise comes from individuals or organizations who drop off items at KC, and through the pickup service that the club provides. Club members, volunteers, and employees then sort, price, display, and sell donated items. This work often requires conscientious sorting, creative merchandising, and tact. A sorter once found \$660 in an article of clothing; occasionally bills are found hidden in books. Items sold include automobiles, store mannequins, live piglets, tombstones, boats, and organs (musical). Once, four people bought the same sofa on the same day and showed up simultaneously to claim it. Someone mistakenly donated a neighbor's dishes. Members and volunteers have had their own coats and jackets inadvertently sold during a sale. The most successful single sale, a three-day event in 1985, grossed \$80,234. Between fiscal years 2006-07 and 2017-18, annual gross sales have increased from \$241,000 to over \$724,000.

Over the years the club has found additional ways to raise funds. It sells donated vehicles through a licensed dealer. It began selling selected items on eBay in 2002, and on craigslist in 2011. On these electronic sites, a few unusual items have sold for hundreds of dollars to more than one thousand dollars. In early January 2011, the club began selling surplus clothing and shoes to recycling agents. The club currently sells our surplus items to Midwest Recycling. This firm picks up the merchandise at the KC, sorts it, and sends it to developing countries for use by citizens there.

Since 1927, the club and its charitable Foundation (formed in 1964) have netted many millions of dollars from our Thrift Sales. The Foundation devotes these net proceeds to supporting many projects of charitable organizations that serve the local community and Washtenaw County. The success of the Thrift Sale depends on the hard work of many club members and dozens of volunteers.

In addition to donating money to charitable organizations, the Foundation gives merchandise to individuals and families in need through two Direct Assistance Programs. One program is operated by the Sales Management Oversight Committee, which, in 2018, provided \$73,995 in direct giving. The club's Community Services Committee administers a second direct assistance program, the Voucher Program, in cooperation with participating local social agencies. In fiscal year 2017-2018, the Committee distributed \$83,807 worth of merchandise to 425 qualified clients of social agencies that serve the greater Ann Arbor community. Each year, the club's Foundation—together with contributions from club members and others, which are matched by monies from the Ray and Eleanor Cross Foundation—also awards approximately \$75,000 to deserving area youth in the form of \$1500 academic scholarships to graduating seniors of Ann Arbor high schools and \$500 Summer Camperships to children and youth of Washtenaw County. The Foundation has also donated clothing to people in need worldwide, especially to orphanages and countries that have suffered natural disasters. Annually, the Thrift Sale's Book Department donates thousands of surplus children's books to teachers and libraries of K-12 schools in Ann Arbor and Detroit. In July of 2017, the Foundation assumed sponsorship of the Warm the Children program of Washtenaw County, which raised and disbursed \$128,700 for winter clothing for area children.

Through all of these programs combined, the club and Foundation have donated over \$6.7 million in money and merchandise to charities and individuals since the club's inception in 1921.

HIXSON FELLOWS

Kiwanis International (KI) established the George F. Hixson Fellowship in 1983 to honor its first president. Fellows are selected in one of two ways. First, members of a club, upon making a lump-sum payment of at least \$1000 to the KI Foundation, may designate recipients during their lifetimes or posthumously. Second, a club itself may designate a recipient (e.g., a Club member or her/his spouse) by making a lump-sum payment of at least \$1000 to the KI Foundation.

To be considered for a Hixson Fellowship sponsored by our Club, a member must demonstrate exceptional dedication to the Club and its Objects during the course of a single year. This may be achieved in various ways, such as excellence as chair of a committee, outstanding success in recruiting, extraordinary involvement by a new member, or other comparable contributions to the Club. In exceptional circumstances, the Club may award a Fellowship to a nonmember, provided that the designee has made a contribution to the community commensurate with the Club's standards for Honorary Member status or has made a singular contribution of time and effort to the Club.

During three administrative years (1996-1999), our Club donated a total of \$104,000 to KI for the Worldwide Iodine Deficiency Disorder program. Consequently, KI extended to our Club the privilege of awarding several dozen Hixson Fellowships because of those donations. Upon the recommendation of the Member Recognition Committee and approval by the Board, the names of Fellows are permanently displayed in the Kiwanis Center. Fellows to date are as follows ("d" denotes a diamond Fellow):

Leland D Bachman	Dana A Dever	Fred C King	Douglas K Olsen
Mary Bachman	Nick Dever	Richard E Kinney	Marie Olsen
Eleanor Bandrofchak	Garrett J Donner	Lloyd Kitchens	Gretchen Preston
Kathleen Barden-Perlberg	Clarence E Dukes	Amanda Jane Kitchens	William Robb
Bob Barden, Jr	Fulton B Eaglin	Thelma Klapper	John Sampelle
Robert J Barden, Sr	Simon Eaglin	Paul Klinger	Fred Sanchez
John Bassett	S J (Sandy) Elden	Donald J Kossick	Peter F Schork
Gordon Beeman	Gary R Elling	Adelaide Laetz	Clifford G Sheldon
David Bell	Al Engerer	Burton Lamkin	Ray Smit
Judith A Bell	Herbert Estes	Sally Lamkin	Susan M Smith
Richard S Benedek	Garrett H Evans	Lynne P Lande	Robert Snider
Gloria Bignall	Betsy Ford	Dale R Leslie (d)	Sheridan W Springer
Richard G Bignall	Muriel Frederick	Paul Lohr	Walter L Springer
Lyman W Bittman	Larry E French	Tom Lovell	Katie Stadel
Earl T Bondie	Willard J Frey	Elizabeth L Mammel	Fred E "Bud" Stein
Al Bourk	Al Gallup	Fredrick A Mammel	Dick Stoll
Jerry M Brown	Ronald D. Gardner	Glenda Maten	Doris M Strite
Gene Buatti	Mario Gasbarro, Jr	Ralph Maten	Jane Talcott
Alan Burg	George J Gilligan	Ann Mattson	Henry A VanderKaay
Don Butcher	Eugene A Glysson	Norma Barbour Mc-	Hugh Wanty
Letitia J Byrd	Marie M Glysson	Collum	Murray D Wanty
Robert I Carr	John Goff	Amber Jean McEwen	Augusta Washington
F Huston Colvin	Robert H Gray	Donald McEwen	Ellen Webb
C Merle Crawford	Katherine J Griswold	Gerald F McMahan	George Wild
Harry L Cross	Jerry Hartweg	Joseph C Medrano (d)	Kathie E Wilder
Ray Cross	Mary Anne Hennigar	Gregory P. Meisner	Ronald N Williams (d)
Michael F Dabbs	Joyce B Herbert	James Morgan (d)	Mark Wishka
Claire Dahl	Joe Jedele	Robert H Nichols	Ronald C Wolf
John Dahl	Bob Johnson	Charles F North	Carol Ziegler
Alan M Dailey	Arthur D Katz	James J O'Kane	Max M Ziegler, Jr
Carl A Dailey	Donald D Kenney	Jeanette Okuley	Douglas F Ziesemer
John D Devall, Jr	Donald J Kern	Donald G Olsen	

GENERAL CHARGES TO CLUB AND FOUNDATION COMMITTEES

Kiwanis Club of Ann Arbor committees are either committees of the Club (C), committees of the Foundation (F), or two separate committees of the Club and of the Foundation respectively (C&F).

Archive (C&F): Locates, discovers, organizes, and archives the records, photos, memorabilia, and historical stories of our Club and Foundation and as they develop into the future. Identifies effective means to safeguard and to search the archives.

Attendance & Reception (C): Tabulates member attendance and organizes members to greet other members, guests, and visitors as they arrive for noon meetings. Introduces guests and visitors to the membership.

Budget & Finance (C&F): Develops annual budgets and quarterly updates for the Club and Foundation. Presents these budgets to the Board.

Building & Equipment (F): Oversees the maintenance, planning, safety, and security of the Kiwanis Center building, equipment, facilities, and vehicles.

Bylaws (C&F): Reviews and recommends changes to the Club and Foundation bylaws. Updates the Club and Foundation Manuals of Administrative Policies and Procedures as appropriate.

Children & Youth Services (F): Initiates projects that benefit children and youth from birth to age 18, and grants funds to organizations that serve them. Awards college, music, and summer campships.

Community Services (F): Oversees the Club's Direct Assistance Program, and helps clients and case managers redeem vouchers for Thrift Sale merchandise. Grants funds for a variety of community projects.

Fines & Happy Dollars (C): Monitors, organizes, and proposes Fines and Happy Dollars and encourages all members to do so at our noon meetings. Collects and counts Fines and Happy Dollars and reports those totals to the Club Treasurer.

Grant Coordination (F): Oversees and administers the Club Foundation's grant-application process. Facilitates disbursements of grants.

Greater Years (F): Initiates projects and grants that benefit seniors. Grants funds to agencies that serve the senior community.

Honorary Members Selection (C): Nominates worthy community-minded citizens who exemplify the ideals of Kiwanis to become Honorary Members of the Club. Oversees the annual induction ceremony for Honorary Members and Honored Volunteers.

Hospitality (C): Informs membership about births, deaths, illnesses, accidents, and hospitalizations that involve current and past members and their families. Sends cards or flowers as appropriate.

Human & Spiritual Values (C&F): Oversees and administers grants that center on spiritual value and human comfort. Oversees the Salvation Army bell-ringing project. Schedules weekly invocation presenters.

Hundredth-Year Celebration (C): Prepares for the 100th anniversary celebration of our Club during calendar year 2021. Explores ideas, develops plans and a schedule of events, and proposes a budget for the Board's approval by April, 2020.

Interclubs (C): Encourages our Club's exchange visits to other Kiwanis clubs. Ensures that our Club completes two interclubs each month, including Superinterclubs.

Investment Oversight (F): Manages the invested reserve funds of the Foundation.

GENERAL CHARGES TO CLUB AND FOUNDATION COMMITTEES, *continued*

K-Family Leadership Programs (C&F): Oversees the maintenance and growth of K-Kids, Builders, Key, Circle K, and Aktion Clubs.

Kiwanis Environment Education Preserve (KEEP) (F): Develops, oversees, and maintains the environmental preserve at the Kiwanis Center.

Kiwanis of Michigan Foundation (F): Informs Club members about the role of KMF in serving children who are patients at the four children's hospitals supported by KMF.

Meals on Wheels (C&F): In conjunction with the UofM MOW program, delivers meals to the frail, elderly, and disabled Monday through Friday throughout the year.

Member Recognition (C): Provides appropriate recognition to members whose contributions have helped the Club achieve its Kiwanis objectives. Oversees attendance and member-award ceremonies.

Membership Digest (C): Prepares and arranges the publication of the annual Membership Digest.

Membership Growth & Education (C): Develops and implements strategies to recruit, orient, introduce, support, and retain Club members.

Newsletter (C): Prepares the weekly (online) Club Newsletter for distribution to Club members.

Nominating (C): Nominates officers (except Secretary) and Directors to stand for annual election. Prepares and counts ballots for the Club's annual meeting.

Operations Coordination (F): Provides ongoing coordination among the three (3) current Kiwanis business activities: Sale Management Oversight committee, Building & Equipment committee, and Tenant/Rental activities and needs.

Personnel (F): Develops, implements, and monitors personnel policies of the Club and Foundation, subject to the approval by the Board.

Programs (C): Secures speakers for noon meetings.

Public Relations & Marketing (C&F): Communicates the mission, vision, activities, and programs of our Club and Foundation to members, volunteers, and the public through on-line and print media. Takes photographs at Club meetings and events for use in the Newsletter, the Membership Digest, and other Club needs. Oversees, and coordinates our Thrift Sale, Club, and Foundation web pages.

Risk Management (C&F): Provides periodic reviews (at least annually) of our building, property, and operations; makes recommendations and oversee the implementation of risk management best practices, proper insurance coverage, and security systems; develops, identifies and reviews the role of the Safety Officer.

Sale Management Oversight (F): Develops policies and implements procedures for managing all aspects of the Thrift Sale. Administers the Foundation's program of direct assistance.

Social (C): Plans and implements periodic social events that foster camaraderie among Club members, volunteers, friends, and families.

Strategic & Long-Range Planning (C&F): Explores goals and the viability of the Club and Foundation for the next 10 years.

Technology (C&F): Identifies and evaluates, technology needs to support Club and Foundation activities. Develops and makes recommendations for continuous improvement.

2018-2019 COMMITTEE ASSIGNMENTS

ARCHIVE

Hillenburg, Co-Ch
Krasnoff, Co-Ch
Barden-Perlberg
Heller
Wilder

ATTENDANCE & RECEPTION

Gray, Co-Ch
LeRoy, Co-Ch
(A) = Attendance taker
(C) = Lunch Cashier

October

Babcock
Brown (C)
Mattson, A
Sanchez (A)

November

Allshouse (A)
Barden-Perlberg
Leslie (C)
Dries

December

Argyle (A)
Burroughs
Drake (C)
Greene

January

Blomquist
Evans (C)
Hadwin
Winkler (A)

February

Dahl, C (A)
Goodkin
Jones
Ziegler (C)

March

Lamkin, B
Lamkin, S (C)
Powers (A)
Smit

April

Donner
Kidle
Kossick (A)
LaMoreaux (C)

May

Bomar
Kotch-Duda
Sampselle (C)
Sanchez (A)

June

Barhydt (A)
LeRoy
Schenk (C)
Supica

July

Dailey
Gallup (A)
Keyes (C)
Stewart

August

Dick
Greene (C)
Presley (A)
Stewart

September

Dahl, J (C)
LeRoy (A)
Roberts
Shaw

BUDGET & FINANCE

Meisner, Ch
Dabbs
Dever, D (ex officio)
French (ex officio)
Gilligan (ex officio)
Hampton (ex officio)
Johnson (ex officio)

Lavin, E
Panning
Sheldon
Schork
Smith

BUILDING & EQUIPMENT

Dever, N, Co-Ch
Gilligan, Co-Ch
Schenk, Co-Ch
Blomquist
Gray
Hiller
Robb, W
Sanchez

BYLAWS

Goodkin, Ch
Dever, N
Medrano
Meisner
Talcott
Wilder

CHILDREN & YOUTH SERVICES

Burroughs Co-Ch
Dabbs, Co-Ch
Babcock
Carey
Dahl, C
Dahl, J
Dittmar
Kotch-Duda
Evans
Hadwin
Hiller
Lamkin, S
Luke
McNab-Cattell
Miller
Wilder
Williams, J

COMMUNITY SERVICES

Carr, Co-Ch, Grants
Webb, Co-Ch, Vouchers
Barhydt
Benedek
Carey
Dailey
Evans
Hughes
Lamkin, B
Lamkin, S
LaMoreaux
Medrano
Presley
Robinson
Smith

Voucher Helpers

Brown
Burg
Carey
Dahl, C
Goodkin
Harper
Hillenburg
Hughes
Johnson
Lamkin, S
Lavin, E
Lavin, M
Leslie
Meisner
Presley
Preston
Roberts
Smit
Smith
Springer
Ziegler

EXECUTIVE

Hampton, Ch
Burg (ex officio)
Dever, D (ex officio)
Meisner (ex officio)
Wilder (ex officio)

FINES & HAPPY DOLLARS

Leslie, Ch
Dever, D
Dukes
Sanchez
Williams, J

GRANT

COORDINATION

Dever, D, Ch
Dabbs, Asst Ch
Burroughs
Carr
Donner
French
Kossick
Lamkin, S
McNabb-Cattell
Robinson
Talcott

GREATER YEARS

Robinson, Ch
Lande
Meretta
Presley

HONORARY MEMBERS SELECTION

Brown, Ch
Anglin
Dukes
Hiller
Krasnoff
Robinson
Sheldon

HOSPITALITY

Hampton, Ch
Oct - Leslie
Nov - Dahl, J
Dec - Lande
Jan - Ziegler
Feb - Sanchez
Mar - Hughes
Apr - Barden-Perlberg
May - Hampton
Jun - Hampton
Jul - Dahl, C
Aug - Dahl, C
Sep - Kossick

HUMAN & SPIRITUAL VALUES

Donner, Ch
Babcock
Brown
Dick
Evans
Hampton
Lamkin, B

HUNDRETH YEAR CELEBRATION

Leslie, Ch
Benedek
Brown
Carr
Conlin, R
Donner
French
Hendricks
Jones
Kidle
Panning
Sheldon
Wilder
Ziegler
ALL past presidents

INTER-CLUBS

Petroski, Ch

INVESTMENT

OVERSIGHT
French, Ch
Dahl, J
Gilligan
Leroy
Meretta
Schork
Ziegler

KEEP

Dever, D, Co-Ch
Krasnoff, Co-Ch
Bomar
Dever, N
Dick
Evans
Gilligan
Hadwin
Petroski

K-FAMILY LEADERSHIP

Kossick, Ch
Daily
Goodkin
McMahon
Sampselle
Schork
Stewart

2018-2019 COMMITTEE ASSIGNMENTS, *continued*

KIWANIS OF MICHIGAN FOUNDATION
French, Ch
Carey

MEALS ON WHEELS

McNab-Cattell, Ch
Anglin
Argyle
Beeman
Bell
Burroughs
Carey
Drake
French
Gallup
Gray
Greene
Hughes
Johnson
Keyes
Lamoreaux
Leslie
Robb, W
Schenk
Sheldon
Smit
Tasch
Wilder
Winkler
Ziegler

Non Club Members

Barden, Marti
Boulter, Katrina
Drake, Marilyn
Gallup, Karen
Greene, Elaine
Herndon, Amy
Herndon, Paul
Huck, James
Johnson, Linda
Novodoff, Jack
Sudderdorf, Sandy

MEMBER RECOGNITION

Carr, Ch
Benedek
Buhrer
Burg
Cross
Dahl, C
French
Gray
Lande
Mattson, A
Schork
Webb
Ziegler

MEMBERSHIP DIGEST

Winkler, Ch
Bassett
Gray
Keyes
Wilder

MEMBERSHIP GROWTH & EDUCATION

Lande, Ch
Allshouse, Asst Ch
Benedek
Bomar
Burroughs
Gray
Hampton
Panning
Smith
Wilder
Williams, J

NEWSLETTER

Rabidoux, Ch
Oct - Allshouse
Nov - Leslie
Dec - Rabidoux
Jan - Beeman
Feb - Sheldon
Mar - Lande
Apr - LaMoreaux
May - Kidle
Jun - Mattson, A
Jul - Dries
Aug - Brown
Sep - Rabidoux

NOMINATING

Burg, Ch
Barden-Perlberg
Beeman
Dabbs
Lande
Schork
Sheldon
Webb

OPERATIONS COORDINATION

Krasnoff, Ch
Dever, D
Dever, N
Gilligan
Hampton
Schork
Non Club Members
Admin. Asst.
Gasbarro, Mario
Salamin, Tanya

OUTREACH

Barden-Perlberg, Ch
Allshouse
Bomar
Brown
Burg
Dahl, C
Dever, D
Gray
Hillenburg
Krasnoff
Lande
Smith
Webb

PERSONNEL

Beeman, Ch
Hampton, Ex officio
Barden, Jr
Dabbs
Mattson, A
Sheldon
Stewart
Ziegler

PROGRAMS

LeRoy, Ch
Jones
Leslie

PUBLIC RELATIONS & MARKETING

Burg, Co-Ch
Hillenburg, Co-Ch
Allshouse
Argyle
Burroughs
Carr
Dries
Gray
Leroy
Robb
Sampson
Williams, J

RISK MANAGEMENT

Schork, Ch
Allshouse
Beeman (ex officio)
Brown
Dever, N (ex officio)
Dever, D (ex officio)
Gilligan (ex officio)
Goodkin
Gray (ex officio)
Hampton (ex officio)
Meisner (ex officio)
Schenk (ex officio)
Wolffington
Ziesemer

Non Club Members

Gasbarro, Mario (ex officio)
Salamin, Tanya

SALES MANAGEMENT

OVERSIGHT

Dever, D, Ch
Burg
D'Angelo
Dahl, J
Gray
Gilligan
Non Club Member
Gasbarro, Mario

SOCIAL

Stewart, Ch
D'Angelo
Presley
Webb

STRATEGIC & LONG RANGE PLANNING

Inactive in 2018-19

TECHNOLOGY

Gray, Ch
Robb
Hillenburg

MEMBERS' BIRTHDAYS

JANUARY

2 Blomquist
5 Lavin, E; Phibbs
8 Barrett
15 Argyle
24 Babcock
27 Dries, Niemann
29 Fomby
31 Luke

FEBRUARY

2 Kossick
3 Williams, M
6 Taylor
8 Krasnoff
9 Reed; Reynolds
16 Webb
18 Cross
23 Sanchez
24 Burroughs

MARCH

1 Dahl, J
3 Beeman; Kotch-Duda
9 Williams, N
12 LaMoreaux
15 Hughes
17 Kinney
18 Robb, M
21 Mehraban; Petroski
22 Klinger; Rabidoux
23 Conlin, R
25 Smith
26 Snider
31 Lavin, M

APRIL

1 Lamkin, B
4 Hillenburg
5 Bassett
6 Dailey; Gilligan
6 Robinson; Schork
10 Carey
23 Jones
24 Powers

MAY

14 Ziesemer
15 Mattson, A
16 Grachek
17 Bulkley; French
18 Gardner
19 Bell
20 Fegan
22 Dittmar
23 Linden
27 Brokaw
28 Wolfington

JUNE

2 Kavanagh
6 Soyars
15 Tse
17 Salemi
25 Barden, Sr; Gallup
26 McMahon
29 Bomar; Stewart

JULY

4 Brown
7 Roberts
8 Barden-Perlberg
8 Talcott
10 Hampton
11 Harper; Williams, J
13 Goss
16 Preston
23 Anglin
24 LeRoy

AUGUST

5 Hadwin
7 Ackerman
9 Meisner
11 Hendricks
25 Dukes
26 Supica
28 Burg; Okuley

SEPTEMBER

4 Conlin, E
6 Dever, D
10 Buhner
11 Shaw
12 Ziegler
13 Schmerberg
14 Gray
15 Barhydt
15 Lamkin, S
15 Panning; Smit
17 Wishka
23 Dick
24 Medrano; Sheldon
25 Drake
26 Leslie

OCTOBER

1 Robb, W
4 Greene
5 Heller
13 Carr; Kidle
15 Dabbs
16 Allshouse
17 Elling; Evans
22 Hanton
23 Schechtman
28 Wilder

NOVEMBER

4 McKeown
7 McNab-Cattell; Miller
12 Presley
14 Barden, Jr
16 Schenk
17 Dahl, C; Mattson, J
17 Sampelle
21 Goodkin; Lande
25 Dever, N

DECEMBER

10 Hawkins; Hiller
13 Johnson
15 Keyes
20 Benedek
22 Donner
24 Winkler
27 D'Angelo
30 Meretta

MEMBERSHIP BY PROFESSION

ACCOUNTANT

Blomquist
Hendricks
Lavin, E

ACTUARY

Smith

ADMINISTRATOR / DIRECTOR / MGR SUPERVISOR

Bomar
Dabbs
Dahl, J
Dailey
Dries
Goss
Hadwin
Hampton
Keyes
LaMoreaux
Leslie
Mattson, J
Okuley
Robb, W
Salemi
Sampsel
Sanchez
Schechtman
Soyars
Stewart
Talcott
Wilder

APPRAISER / REALTOR

Carey
Schmerberg

ATTORNEY / PARALEGAL

Beeman
Benedek
Dever, D
Dever, N
Dick
Gardner
Goodkin
Heller
Krasnoff
Rabidoux
Reed

CIVIL SERVANT

Snider (Meteorologist)

CONSULTANT

Ackerman
Conlin, R
Cross
Fegan
Lavin, M

DENTIST / ORTHODONTIST

Hillenburg
Niemann

DESIGNER

Donner (Toys and games)

EDUCATOR

Anglin
Barhydt
Barrett
Bassett
Bulkley
Burg
Burroughs
Dahl, C
Dittmar
Dukes
Evans
Gallup
Grachek
Gray
Kinney
Kossick
Lamkin, B
Lamkin, S
McNab-Cattell
Medrano
Petroski
Reynolds
Williams, M
Williams, N

ENGINEER

Babcock
Carr
Elling
Greene
Hughes
Luke
Meisner
Schenk
Smit
Supica

EXECUTIVE / BUSINESS OWNER

Barden-Perlberg
Barden, Jr
Barden, Sr
Brown
Hawkins
Kavanagh
Linden
McKeown
Miller
Powers
Presley
Preston
Robb, M
Roberts
Webb
Williams, J

FINANCIAL PLANNER / BANKER

Brokaw
Drake
Hanton
Jones
Kidle

LeRoy
Mehraban
Meretta
Panning
Schork
Sheldon
Wolffington
Ziegler

INSURANCE AGENT/ ACCOUNT EXEC

Allshouse

INVESTMENT ADVISOR

Kotch-Duda
French
Gilligan
Wishka
Ziesemer

JUDGE / JUDICIAL

Hiller
Mattson, A

NURSE

Buhrer

PASTOR / RELIGION

Bell

PSYCHOLOGIST / THERAPIST

D'Angelo
Lande

RESEARCH SCIENTIST

Argyle
Fomby
Johnson
Tse
Winkler

RETAILER / WHOLESALER

Conlin, E
Phibbs
Taylor

SERVICE PROVIDER

Klinger (Musician)
McMahon (Painter)
Shaw (Computer Prog)

SOCIAL WORKER

Robinson

VETERINARIAN

Harper

ADVERTISER INDEX

Accounting	29	Marketing	11
Attorney	10	Museum	18
Banking	17, 31, back cover	Physical Trainers	3
Child Care	19	Quilts	10
Debt Recovery	9	Realtor	11, 12
Flowers & Gifts	17	Recreation	7
Food & Beverages	4, 29	Restaurants	19
Foster Youth Services	14	Service Organization	1, 5, 28
Gardening Supplies	18	Therapist	17
Insurance	11, 14	Travel	15
Interior Landscaping	15	Veterinarian	14
Investment Serv	9, 10, 15, 30, 36		

2018-19 Kiwanis Calendar

2018	October	November	December	
	S M T W T F S 1 2 3 4 5 6 7 8 9 10 11 12 13 14 15 16 17 18 19 20 21 22 23 24 25 26 27 28 29 30 31	S M T W T F S 4 5 6 7 8 9 10 11 12 13 14 15 16 17 18 19 20 21 22 23 24 25 26 27 28 29 30	S M T W T F S 2 3 4 5 6 7 8 9 10 11 12 13 14 15 16 17 18 19 20 21 22 23 24 25 26 27 28 29 30 31	
	2019	January	February	March
		S M T W T F S 1 2 3 4 5 6 7 8 9 10 11 12 13 14 15 16 17 18 19 20 21 22 23 24 25 26 27 28 29 30 31	S M T W T F S 1 2 3 4 5 6 7 8 9 10 11 12 13 14 15 16 17 18 19 20 21 22 23 24 25 26 27 28	S M T W T F S 1 2 3 4 5 6 7 8 9 10 11 12 13 14 15 16 17 18 19 20 21 22 23 24 25 26 27 28 29 30 31
April		May	June	
S M T W T F S 1 2 3 4 5 6 7 8 9 10 11 12 13 14 15 16 17 18 19 20 21 22 23 24 25 26 27 28 29 30		S M T W T F S 1 2 3 4 5 6 7 8 9 10 11 12 13 14 15 16 17 18 19 20 21 22 23 24 25 26 27 28 29 30 31	S M T W T F S 1 2 3 4 5 6 7 8 9 10 11 12 13 14 15 16 17 18 19 20 21 22 23 24 25 26 27 28 29 30	
2020	July	August	September	
	S M T W T F S 1 2 3 4 5 6 7 8 9 10 11 12 13 14 15 16 17 18 19 20 21 22 23 24 25 26 27 28 29 30 31	S M T W T F S 1 2 3 4 5 6 7 8 9 10 11 12 13 14 15 16 17 18 19 20 21 22 23 24 25 26 27 28 29 30 31	S M T W T F S 1 2 3 4 5 6 7 8 9 10 11 12 13 14 15 16 17 18 19 20 21 22 23 24 25 26 27 28 29 30	
	October	November	December	
	S M T W T F S 1 2 3 4 5 6 7 8 9 10 11 12 13 14 15 16 17 18 19 20 21 22 23 24 25 26 27 28 29 30 31	S M T W T F S 1 2 3 4 5 6 7 8 9 10 11 12 13 14 15 16 17 18 19 20 21 22 23 24 25 26 27 28 29 30	S M T W T F S 1 2 3 4 5 6 7 8 9 10 11 12 13 14 15 16 17 18 19 20 21 22 23 24 25 26 27 28 29 30 31	

TRADITIONAL CLUB ACTIVITIES

DECEMBER 2018

2-Day Christmas Sale
Salvation Army Bell Ringing
Club Christmas Party

JANUARY 2019

Detroit #1 Birthday Party
Detroit, MI

APRIL 13, 2019

Spring Divisional

MAY 2019

Club Annual Meeting & Elections
Perfect Attendance Awards

JUNE 26-29, 2019

International Convention
Walt Disney World, Florida

AUGUST 2019

Club Family Picnic

AUGUST 22-25, 2019

District Convention
Sheraton Ann Arbor Hotel
Ann Arbor, Michigan

SEPTEMBER 2019

Installation of Officers & Directors
Legion of Honor Awards



Ann Arbor State Bank
The Personal Bank

Taking care of your financial needs...
So you can visit the world's best place
for the "funkiest" gifts



Proud supporter of the Kiwanis Club of Ann Arbor

125 W. William St. Ann Arbor, MI (734) 761-1475 a2sb.com